

ROCKWOOD
ULTRA LITE &
SIGNATURE
FIFTH WHEELS

ROCKWOOD

ULTRA LITE & SIGNATURE FIFTH WHEELS

PROVIDING OUTDOOR FUN SINCE 1974.



Welcome to
MILLERSBURG





OVER 40 YEARS OF EXCELLENCE

FROM HUMBLE BEGINNINGS, ROCKWOOD HAS EMERGED AS AN INDUSTRY LEADER IN THE MANUFACTURING OF LIGHT WEIGHT TRAVEL TRAILERS, FIFTH WHEELS AND CAMPING TRAILERS.

Located in Millersburg, IN since 1974, Rockwood has been supported by this community and the local families residing there. These families have helped provide the hundreds of workers that have brought their dedication to quality workmanship, respect for their fellow workers and a commitment to an uncompromising work ethic to make a major contribution to this company's success. Founded on the principle of providing superior value and service while remaining in tune with customer's preferences, Rockwood has become the ultimate luxury product in the light weight fifth wheel market, proudly showcasing more innovative floor plans, appealing features and refined interior appointments than any others in its class.

TODAY, ROCKWOOD REMAINS COMMITTED TO INSURING THAT OUR CUSTOMERS ENJOY THEIR CAMPING EXPERIENCES. Through the utilization of our experienced work force, "state of the art" lamination facility, modern production plants and detailed assembly processes our aim is to continue to provide our customers with the best built product possible at an unmatched value.

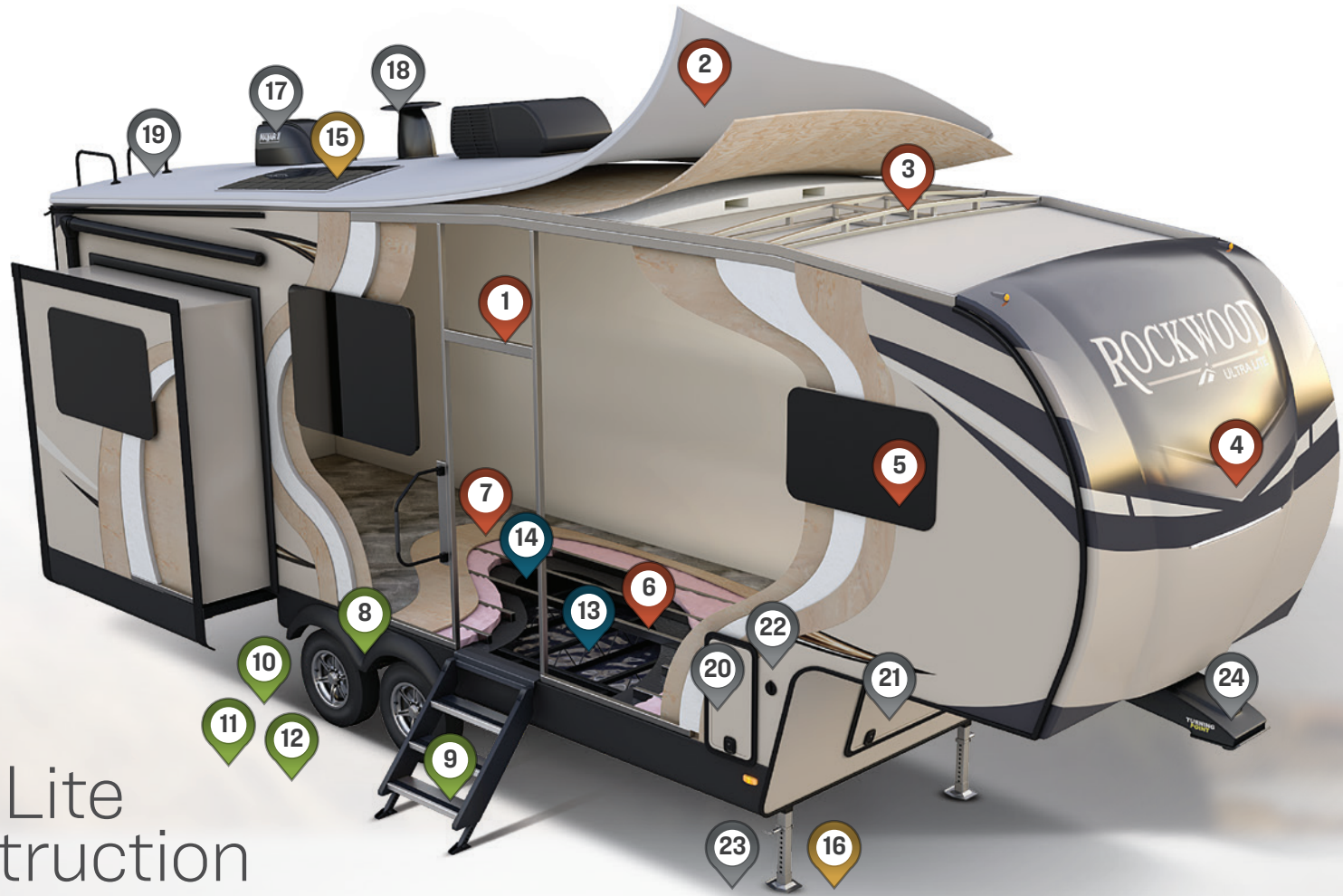

Ultra Lite Construction

THE ROCKWOOD DIFFERENCE

▶ SUPERIOR CONSTRUCTION

- 1 6 Sided Full Aluminum Frame
- 2 Fully Laminated One-Piece Walkable Roof
- 3 Aluminum Truss Roof Bracing
- 4 Painted Fiberglass Front Cap W/ Clear Coat
- 5 Frameless Windows
- 6 Aluminum Floor Joists
- 7 5/8" Tongue & Groove Plywood Floor

▶ SAFETY STANDARDS

- 8 Dexter Torsion Axles
- 9 MORryde Strut Assist Steps
- 10 TST Tire Pressure Monitor System
- 11 16" E-Rated Goodyear Endurance Tires
- 12 Nitrogen Filled Tires

▶ CLIMATE PROTECTION PACKAGE

- 13 Radiant Foil In Underbelly, Front Caps & Slide Out Floors
- 14 12v Thermostatically Controlled Heated Tanks

▶ OPTIONAL FEATURES

- 15 190w Solar Panel W/ 1000w Inverter
- 16 Auto Leveling

▶ STANDARD FEATURES

- 17 Maxxair Fan W/ Cover
- 18 Teton All In One Wifi Booster w/ LTE Prep & Antenna
- 19 Back Up Camera Prep
- 20 Double 30# LP Bottles
- 21 Key-Alike Locks
- 22 Solar Prep On Side & Roof
- 23 Power Stabilizers
- 24 LCI Turning Point Pin Box

ULTRA LITE

YOU WILL LOVE WHAT YOU FIND IN OUR FLOOR PLANS. Our fifth wheels are packed full of quality features in order to bring to you one of the best values in the light weight market. There are spacious flush floor slides, comfortable stylish sofas and wide dinettes and extra large windows to enhance your camping experience. Our Ultra Lite series offers lots of room and amenities while still being a 1/2 or 3/4 ton towable fifth wheel.



2442BS REAR KITCHEN ULTRA LITE UVW: 7950 HITCH: 1252 AXLE: 6639 CCC: 1902 LENGTH: 28' 11"
 WIDTH: 8' HEIGHT: 13' 1" FRESH: 54 gal GRAY: 80 gal BLACK: 40 gal



2445WS REAR KITCHEN ULTRA LITE UVW: 7764 HITCH: 1215 AXLE: 6490 CCC: 2051 LENGTH: 28' 11"
 WIDTH: 8' HEIGHT: 13' 1" FRESH: 54 gal GRAY: 80 gal BLACK: 40 gal



2621WS REAR LIVING ULTRA LITE UVW: 8289 HITCH: 1404 AXLE: 6826 CCC: 1615 LENGTH: 30' 5"
 WIDTH: 8' HEIGHT: 13' 1" FRESH: 54 gal GRAY: 80 gal BLACK: 40 gal

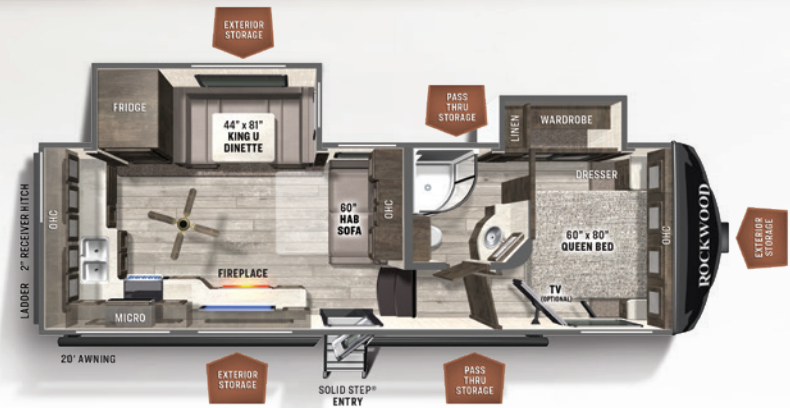

2622RK REAR KITCHEN ULTRA LITE UVW: 8211 HITCH: 1245 AXLE: 6907 CCC: 1634 LENGTH: 30' 5"
 WIDTH: 8' HEIGHT: 13' 1" FRESH: 54 gal GRAY: 80 gal BLACK: 40 gal

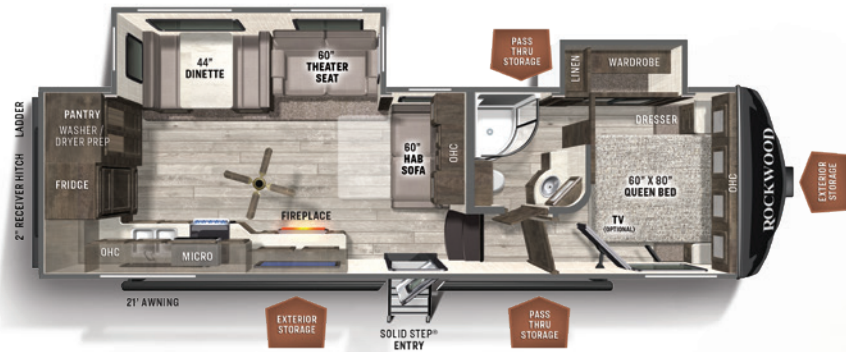

2881S REAR KITCHEN ULTRA LITE U/VW: 8758 HITCH: 1308 AXLE: 7391 CCC: 2550 LENGTH: 33'
 WIDTH: 8' HEIGHT: 13' 2" FRESH: 54 gal GRAY: 80 gal BLACK: 40 gal



2882S REAR KITCHEN ULTRA LITE U/VW: 9620 HITCH: 1496 AXLE: 8065 CCC: 1876 LENGTH: 33'
 WIDTH: 8' HEIGHT: 13' 2" FRESH: 54 gal GRAY: 70 gal BLACK: 40 gal



2883WS REAR LIVING ULTRA LITE U/VW: 9499 HITCH: 1540 AXLE: 7900 CCC: 2041 LENGTH: 33' 10"
 WIDTH: 8' HEIGHT: 13' 2" FRESH: 54 gal GRAY: 90 gal BLACK: 50 gal

2883WS



2887MB BUNKHOUSE ULTRA LITE U/VW: 10229 HITCH: 1620 AXLE: 8550 CCC: 1791 LENGTH: 36' 6"
 WIDTH: 8' HEIGHT: 13' 2" FRESH: 54 gal GRAY: 90 gal BLACK: 50 gal



2891BH BUNKHOUSE ULTRA LITE U/VW: 9270 HITCH: 1483 AXLE: 7728 CCC: 2213 LENGTH: 36' 6"
 WIDTH: 8' HEIGHT: 13' 2" FRESH: 54 gal GRAY: 80 gal BLACK: 40 gal



2892RB BUNKHOUSE ULTRA LITE U/VW: 10018 HITCH: 1602 AXLE: 8357 CCC: 1584 LENGTH: 36' 6"
 WIDTH: 8' HEIGHT: 13' 4" FRESH: 54 gal GRAY: 90 gal BLACK: 90 gal



2893BS REAR LIVING ULTRA LITE U/VW: 10434 HITCH: 1675 AXLE: 8700 CCC: 1641 LENGTH: 36' 6"
 WIDTH: 8' HEIGHT: 13' 2" FRESH: 54 gal GRAY: 90 gal BLACK: 50 gal

*Gas/Electric Fridge Available

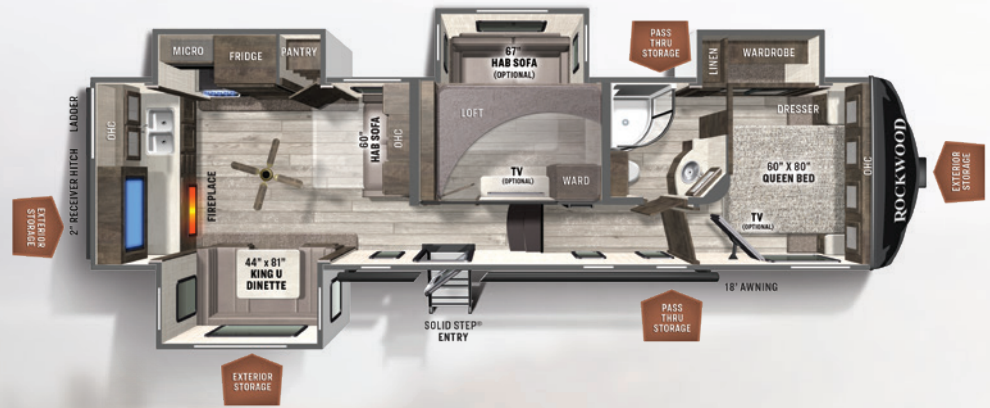

2896MB BUNKHOUSE ULTRA LITE U/VW: 9662 HITCH: 1588 AXLE: 8015 CCC: 1926 LENGTH: 36' 6"
 WIDTH: 8' HEIGHT: 13' 2" FRESH: 54 gal GRAY: 90 gal BLACK: 50 gal

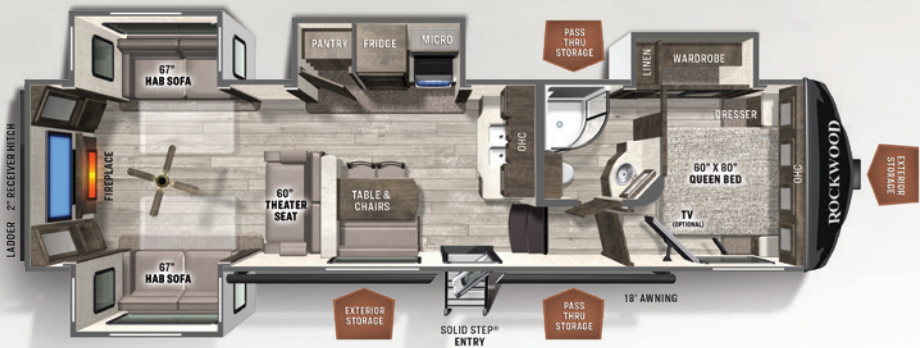

2898KS REAR LIVING ULTRA LITE U/VW: 9631 HITCH: 1583 AXLE: 7989 CCC: 1952 LENGTH: 36' 6"
 WIDTH: 8' HEIGHT: 13' 2" FRESH: 54 gal GRAY: 90 gal BLACK: 50 gal



2899KS REAR KITCHEN / BAR ULTRA LITE U/VW: 10255 HITCH: 1699 AXLE: 8497 CCC: 1844 LENGTH: 36' 6"
 WIDTH: 8' HEIGHT: 13' 2" FRESH: 54 gal GRAY: 80 gal BLACK: 50 gal

*Gas/Electric Fridge Available

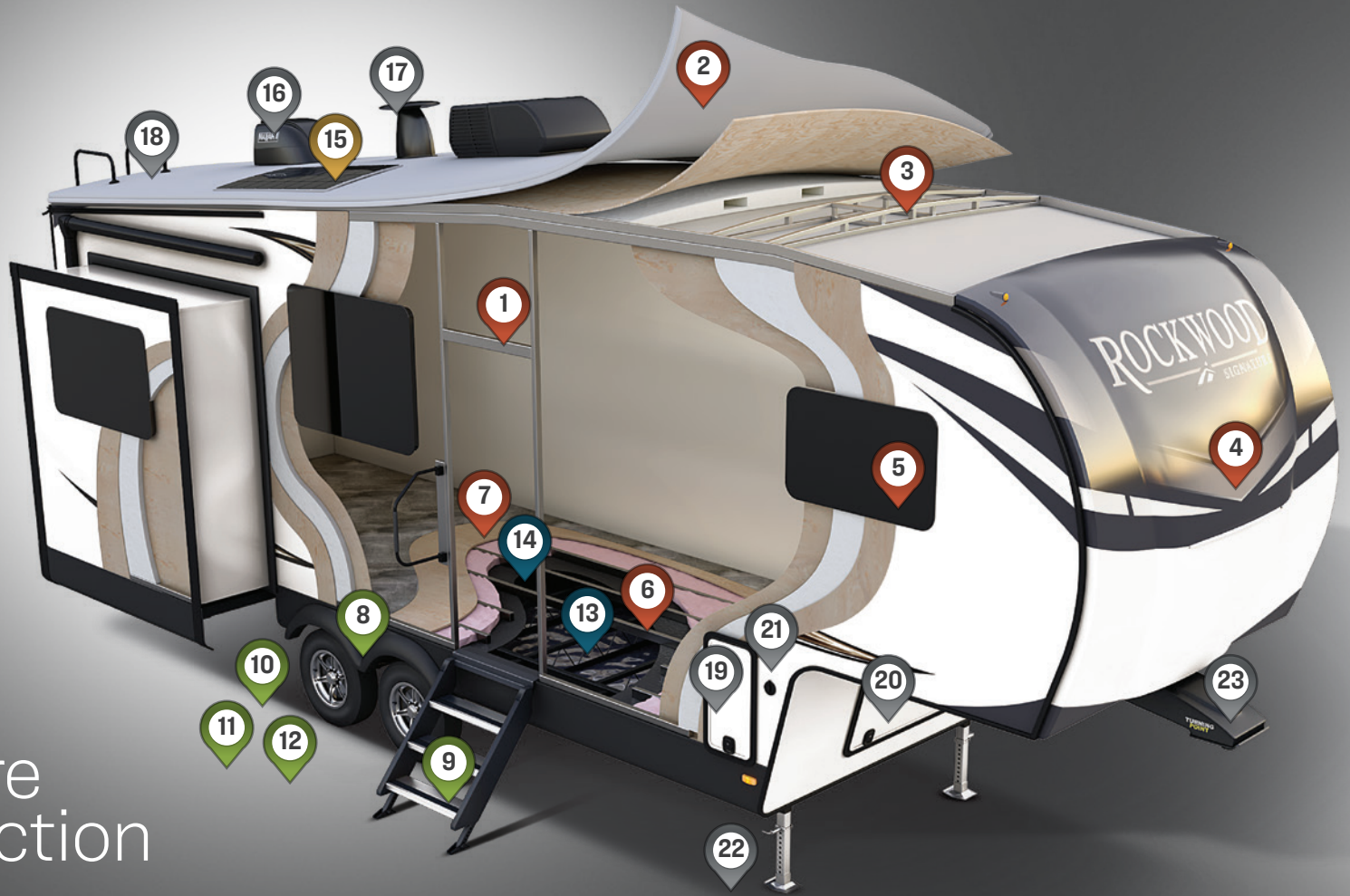

Signature Construction

THE ROCKWOOD DIFFERENCE

▲ SUPERIOR CONSTRUCTION

- 1 6 Sided Full Aluminum Frame
- 2 Fully Laminated One-Piece Walkable Roof
- 3 Aluminum Truss Roof Bracing
- 4 Painted Fiberglass Front Cap W/ Clear Coat
- 5 Frameless Windows
- 6 Aluminum Floor Joists
- 7 5/8" Tongue & Groove Plywood Floor

▲ SAFETY STANDARDS

- 8 Dexter Torsion Axles
- 9 MORryde Strut Assist Steps
- 10 TST Tire Pressure Monitor System
- 11 16" E-Rated Goodyear Endurance Tires
- 12 Nitrogen Filled Tires

▲ CLIMATE PROTECTION PACKAGE

- 13 Radiant Foil In Underbelly, Front Caps & Slide Out Floors
- 14 12v Thermostatically Controlled Heated Tanks

▲ OPTIONAL FEATURES

- 15 190w Solar Panel W/ 1000w Inverter

▲ STANDARD FEATURES

- 16 Maxxair Fan W/ Cover
- 17 Teton All In One Wifi Booster w/ LTE Prep & Antenna
- 18 Back Up Camera Prep
- 19 Double 30# LP Bottles
- 20 Key-Alike Locks
- 21 Solar Prep On Side & Roof
- 22 Electric Auto Leveling
- 23 LCI Turning Point Pin Box



SIGNATURE BY ROCKWOOD

WHEN YOU WANT TO TAKE YOUR CAMPING EXPERIENCE TO THE NEXT LEVEL, LOOK NO FURTHER THAN OUR SIGNATURE LINE OF 5TH WHEELS. Expect all the quality and superior construction that you have come to know in a Rockwood, plus added features to enhance your expedition. Amenities like king beds, electric auto leveling, central vacuum, shielded awning covers, high-gloss fiberglass exterior, upgraded solid-surface countertops and even residential soft-close drawers will be included in our Signature line. This series was designed for those who desire the finest luxuries in a quality 5th wheel.



8298KS

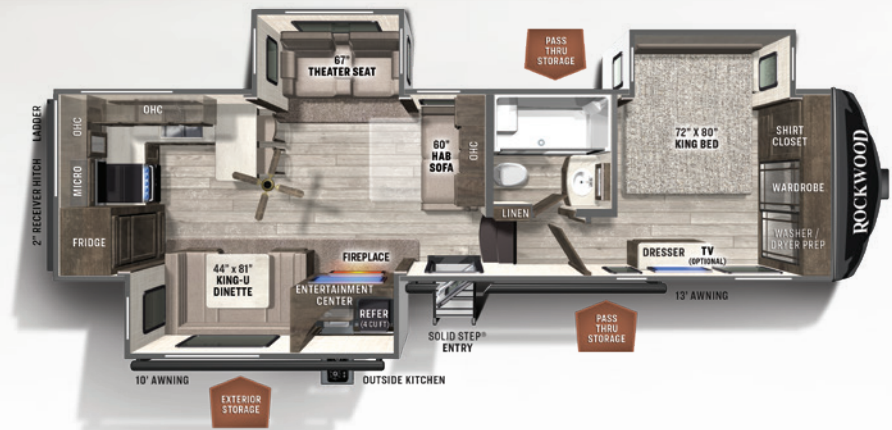

8288SB

REAR LIVING
SIGNATURE

UVW: 10757 HITCH: 1699 AXLE: 8999 CCC: 1742 LENGTH: 37' 2"
WIDTH: 8' HEIGHT: 13' 2" FRESH: 54 gal GRAY: 80 gal BLACK: 50 gal

*Gas/Electric Fridge Available

8291RK

REAR KITCHEN
SIGNATURE

UVW: 10225 HITCH: 1557 AXLE: 8609 CCC: 1732 LENGTH: 36' 6"
WIDTH: 8' HEIGHT: 13' 2" FRESH: 54 gal GRAY: 90 gal BLACK: 50 gal



8298KS

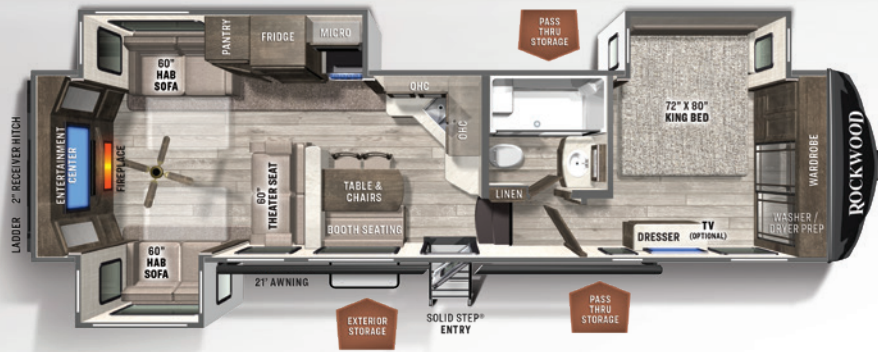

8298KS REAR LIVING SIGNATURE UVW: 9998 HITCH: 1520 AXLE: 8419 CCC: 1922 LENGTH: 37' 2"
 WIDTH: 8' HEIGHT: 13' 2" FRESH: 54 gal GRAY: 90 gal BLACK: 50 gal



8299SB REAR LIVING SIGNATURE UVW: 9940 HITCH: 1555 AXLE: 8326 CCC: 2015 LENGTH: 36'
 WIDTH: 8' HEIGHT: 13' 2" FRESH: 54 gal GRAY: 90 gal BLACK: 50 gal

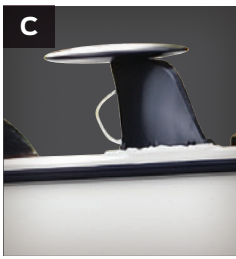
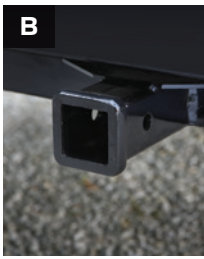

- A Rear Camera Prep.** (Std. all models)
The Furrion observation camera system with digital wireless technology is sold separately.
- B 2" Accessory Hitch Receiver** (Std.) 300 LB capacity
- C Teton All In One Sky4 WiFi Booster/LTE Prep/Antenna**
- D OneControl App Controlled Switch Panel** (Ultra Lite Only)
- E The LCI Turning Point Hitch** provides:
1) Full 90 degree worry-free turning,
2) Eliminates the need for a slider hitch
3) Greatly enhances maneuverability
- F Tire Pressure Monitoring System** (Std.)
- G Roof & Side Solar Panel Prep** (Std. All Models) The Zamp 40 amp. portable solar panel shown is sold separately.
- H Hide-A-Bed Sofa.**
Fabric matched to decor.
- I Swivel Rocker Recliner** where applicable. Fabric to match. (Standard on 8299SB only)
- J La-Z-Boy Swivel Recliner** where applicable. Fabric to match decor. (Optional on 8299SB only)
- K 67" Theatre Seating** per plan where available. Fabric matched to decor. (Per floor plan)

CHOCOLATE

SOFA, CHAIRS, DINETTE CUSHIONS
(LEATHER APPEARANCE)
(SEAPORT MINK)

ACCENTS
(BUREN BK CASHMERE)



BEDROOM (DODWORTH COBBLESTONE)



SLATEWOOD
STANDARD



FLOOR COVERING
WITH SLATEWOOD



NEWPORT ASH
OPTIONAL

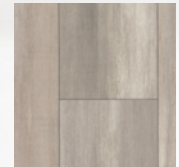

FLOOR COVERING
WITH NEWPORT ASH



CARPET

STONE

SOFA, CHAIRS, DINETTE CUSHIONS
(LEATHER APPEARANCE)
(XANDER STONE)

ACCENTS (LUZ BK MINERAL)



BEDROOM (DODWORTH COBBLESTONE)

ROCKWOOD ULTRA LITE & SIGNATURE

FIFTH WHEEL STANDARDS & OPTIONS

INTERIOR FEATURES		
Slatewood Interior	Trash Can in Kitchen (Select floor plans)	Solid Surface Kitchen Countertops
Screwed & Glued Cabinetry	Bathroom Skylight	Designer Kitchen Backsplash
Solid Wood Cabinet Doors & Drawers With Hidden Hinges & Upgraded Hardware	Water Heater By-Pass Kit	Flush Mount Stainless Steel Sinks With "High Rise" Pull-Down Faucet
35,000 BTU Floor Ducted Furnace	Residential Style Porcelain Bowl Foot Flush Toilet	6 Gallon Quick Recovery Auto Ignition
50 Amp Service with 2nd A/C prep	Maxxair® Ventilation Fan and Vent Cover	Gas/Electric Water Heater
Fireplace (Select floor plans)	Washer/Dryer Prep (Select floor plans)	Shower Miser Water Saver System
Carbon Monoxide Detector	Larger 76" Entry Doors	360 Siphon Black Water Venting
12 Volt Power Plug With USB Charging Port	Ceiling Fan	Outside Speakers
Battery Disconnect Switch	STANDARD PACKAGES	
55 Amp Converter With Charger	5/8" Plywood Tongue and Groove Sub Floor	LED TV With Upgraded Speaker System and Subwoofer
Flush Mount Ceiling LED 12 Volt Interior Lighting w/ Multiple Switches	Aluminum Bed and Dinette Bases	Multi Zone Stereo w/ DVD/CD/AM&FM & Bluetooth
Deluxe Tri-Fold Sofa (Select floor plans)	76" Slide Out Height in Living/Kitchen	One Control App for Lights/Awnings/Slides
Theatre Seating w/ Adjustable Lumbar Support & USB Ports (Select floor plans)	High Gloss Front Cap	Teton All In One Wifi Booster/LTE Prep & Antenna
Night Roller Shades	Enclosed Underbelly	Torsion Axle, Rubber-Ryde Suspension w/ Easy Lube Axles & Never Adjust Brakes
Gas / Electric Refrigerator (Select floor plans)	Thermostatically Controlled Heated Holding Tanks	Nitrogen Filled 16" E-Rated Goodyear Endurance Tires
12 Cubic Foot Auto Gas/Electric Refrigerator w/ Stainless Steel Panels (8299SB & 2882S Only)	Tinted Frameless Windows	Tire Pressure Monitoring System with Monitor
Three Burner High Output Gas Range with Flush Mount Glass Top Cover	Power Awning w/ Adjustable Rain Dump and LED Light Strip	Easy Lube Axles & Never Adjust Brakes
Water-Pur Filtration System	LCI *Turning Point Pin Box Hitch	Polished Alloy Wheels
	13,500 BTU Ducted A/C	Spare Tire Carrier & Cover
	Microwave Oven	Rear Observation Camera Prep w/ Molded Mounting Plate
	Recessed Cooktop and 21" Oven w/ Flush Mount Cover	Roof & Ground Solar Panel Prep
	Hidden Hinge Cabinet Doors	Rear Ladder
	Residential Full Extension Metal Drawer Guides	Black Tank Flush

Strut Assist Fold-Out Steps
 Radiant Foil Insulated Underbelly, Front Caps &
 Slide-out Floors

Keyed Alike Locks
 Power Stabilizer Jacks (Standard on Ultra Lite FW)

Day/Night Roller Shades (Ultra Lite Only)
 Electric Auto Leveling System (Optional on Ultra Lite)
 Washer & Dryer (Select floor plans)
 Free Standing Table and Chairs (Select floor plans)

EXTERIOR FEATURES

6 Sided Full Aluminum Frame (Floor, Walls, & Roof)
 Insulation Factors R-7 Side Wall, R-12 Floor and R-14 Roof
 Radius Roof With Vaulted Interior Ceilings
 One Piece Seamless Roofing Membrane
 Laminated Champagne Color Fiberglass Sidewalls
 Friction Hinge 30" Primary Entrance Door
 Lighted Entry Step
 Large Grab Handles
 Outside Griddle w/ LP Hookup and Work Table
 Outside Shower
 Front Outside Storage
 Outside Antifreeze Inlet for Convenient Winterizing
 Slam Latches on Most Exterior Storage Doors & Magnetic
 Storage Door Latches
 Two Enclosed 30lb LP Gas Bottles w/ Storage Door Access
 Surface Coated Steel I-Beam Frame
 Nautilus Water Management System
 2" Accessory Hitch Receiver

OPTIONS

Newport Ash Interior
 Laminated White Fiberglass Sidewalls
 15,000 BTU Ducted Roof Air
 2nd Roof A/C w/ Chill Chaser Heat Strip in Bedroom
 Bedroom TV & Bunkroom TV
 Theater Seat IPO Sofa (Select floor plans)
 20 Cubic Foot Residential Refrigerator w/ Inverter
 (Select floor plans)
 11 Cubic Foot 12V Refrigerator w/ Inverter and Roof Solar
 Panel (N/A 2882S, 2883WS, 2891BH, 2893BS, 2899KS,
 8288SB, 8299SB)
 18 Cubic Foot Gas/Electric Refrigerator
 (Available on 8288SB, 2899KS, 2893BS, 2883WS)
 Extra Maxxair® Ventilation and Vent Cover
 Bike Rack Ladder Attachment
 Flip Down Rear Storage Deck (250 lbs. Max Load)
 Slide Toppers
 ThermoPane Window Upgrade
 King Bed Mattress (Available on 2442BS, 2883WS,
 2887MB, 2893BS, 2899KS)



STANDARD SIGNATURE UPGRADES

- Residential Solid Surface Kitchen Countertops
- Touch Button Control Pad w/ Bluetooth App Control
- Electric Auto Leveling System
- Shielded Awning Cover
- Day/Night Roller Shades
- High Gloss Fiberglass Exterior
- Soft-Closing Drawer Guides
- Central Step Vacuum
- Sound Bar
- King Bed Slides



We work hard to make a quality product
So you can enjoy it for years to come.

Rockwood Warranty. Our Promise.

FOR DETAILS ON ROCKWOOD'S COMPLETE WARRANTY PROGRAM, SEE YOUR ROCKWOOD DEALER. When it comes to backing products with the same quality and commitment it does when it begins the manufacturing process, the only name you have to remember when you're looking for a recreational vehicle is Rockwood. Rockwood offers the following additional limited warranties to the original purchasers. Consult written warranty for details.

1. Twelve-year vinyl roof warranty. 2. Two-year fiberglass warranty. 3. Ten-year Torflex® axle warranty. 4. One-year bumper to bumper warranty.



www.ForestRiverBuyLocal.com





**24/7 EMERGENCY
ROADSIDE ASSISTANCE
WITH VEHICLE PURCHASE***

<p>TOWING JUMP-STARTS TIRE CHANGES FLUID DELIVERY LOCKOUT SERVICE</p>	<p>WINCH-OUT MOBILE MECHANIC TECHNICAL SUPPORT DEALER LOCATOR SERVICES</p>
---	--



***VALID FOR 1 YEAR FROM DATE OF PURCHASE**



PRE-DELIVERY INSPECTION FACILITY
20,000 square feet of quality assurance. The bare essentials for a premium product. This state-of-the-art facility gives immediate daily feedback to production for quality assurance in every unit built.

Specification Definitions :: GVWR (Gross Vehicle Weight Rating) - is the maximum permissible weight of the unit when fully loaded. It includes all weights, inclusive of all fluids, cargo, optional equipment and accessories. For safety and product performance do NOT exceed the GVWR. // **GAWR (Gross Axle Weight Rating)** - is the maximum permissible weight, including cargo, fluids, optional equipment and accessories that can be safely supported by a combination of all axles. // **UVW (Unloaded Vehicle Weight)*** - is the typical weight of the unit as manufactured at the factory. It includes all weight at the unit's axle(s) and tongue or pin and LP Gas. The UVW does not include cargo, fresh potable water, additional optional equipment or dealer installed accessories. *Estimated average based on standard build optional equipment. // **CCC (Cargo Carrying Capacity)**** - is the amount of weight available for fresh potable water, cargo, additional optional equipment and accessories. CCC is equal to GVWR minus UVW. Available CCC should accommodate fresh potable water (8.3 lbs per gallon). Before filling the fresh water tank, empty the black and gray tanks to provide for more cargo capacity. **Estimated average based on standard build optional equipment. // Each Forest River RV is weighed at the manufacturing facility prior to shipping. A label identifying the unloaded vehicle weight of the actual unit and the cargo carrying capacity is applied to every Forest River RV prior to leaving our facilities. The load capacity of your unit is designated by weight, not by volume, so you cannot necessarily use all available space when loading your unit. // All information contained in this brochure is believed to be accurate at the time of publication. However, during the model year, it may be necessary to make revisions and Forest River, Inc., reserves the right to make all such changes without notice, including prices, colors, materials, equipment and specifications as well as the addition of new models and the discontinuance of models shown in this brochure. Therefore, please consult with your Forest River dealer and confirm the existence of any materials, design or specifications that are material to your purchase decision. Litho. U.S.A. FOR 1763 W: 2021.02.10

Look for our other popular lines of Rockwood trailers.



ROCKWOOD GEO PRO



ROCKWOOD TRAVEL TRAILERS



ROCKWOOD TENT CAMPERS

YOUR **ROCKWOOD** DEALER



Learn More
Scan this barcode using a QR Reader on your smart phone to learn more about Forest River.



A Berkshire Hathaway company.

