



Jayco[®]

Generations of family fun.

JAY FLIGHT

2015 TRAVEL TRAILERS BY JAYCO



2
YEAR
WARRANTY

This 1986 brochure cover inspired our 2015 literature.

BUILT TO BE AMERICA'S **family** FAVORITE



JAY FLIGHT TRAVEL TRAILERS

For 45 years, Jayco has helped create generations of family fun, and over the course of that time, fun still looks remarkably the same. From campfires to fishing, from relaxing to eating, fun has the same feel generations later—and all with a Jayco RV nearby. Today, we're the largest family-owned RV manufacturer in the world, and our promise is to continually strive to build family-friendly products that will outlast just about everything but your memories. Join us in our generations of family fun.

On the cover: The 1986 brochure artwork, illustrated by Tim MacDonald, was part of a successful ad campaign. These illustrations inspired the 2015 Jayco brochure covers, which are live re-creations of Tim's artwork.



Scan this QR code to watch how Jayco delivers Generations of Family Fun or visit www.GenerationsOfFamilyFun.com.

Meet the Jay Flight family, America's No. 1 selling travel trailer for nine years straight. Built by our family for your family, you'll find a perfect fit in this popular lineup.



Jay Flight SLX

PAGE 4

	WEIGHT	2,250 - 6,065 lbs.
	SLEEPS	2 - 10



Jay Flight

PAGE 8

	WEIGHT	3,715 - 8,065 lbs.
	SLEEPS	3 - 12



JAY FLIGHT SLX 195RB | AMBER
SEE YOUR DEALER FOR CURRENT WOOD SELECTION



Jay Flight SLX

Ready, set, tow

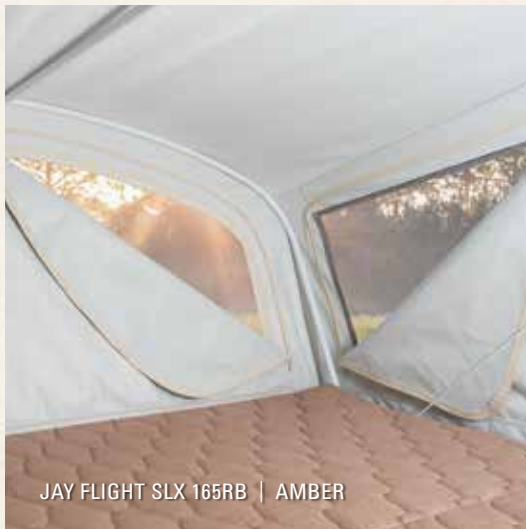

JAY FLIGHT SLX 165RB | AMBER



JAY FLIGHT SLX 165RB | AMBER
SEE YOUR DEALER FOR CURRENT WOOD SELECTION



DIAMONDFLOR VINYL FLOORING

When you're having on-the-go fun, there's bound to be loads of foot traffic, so we equip Jay Flight SLX with seamless, wall-to-wall Diamondflor vinyl flooring. SLX also features an Atwood 12-gallon/hour quick-recovery water heater.



CONVENIENTLY COMFORTABLE

Jay Flight SLX features LED lighting, name-brand appliances, pleated window shades and solid-wood frame cabinetry.



JAY FLIGHT SLX 195RB | AMBER
SEE YOUR DEALER FOR CURRENT WOOD SELECTION

JAY FLIGHT SLX 195RB | AMBER

JAY FLIGHT SLX FLOORPLANS

7-FOOT-WIDE MODELS

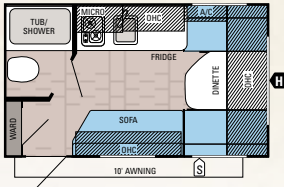

JAY FLIGHT SLX | 145RB

Ext. Length: 16' 6" Ext. Height: 101"
 Unloaded Weight (lbs.): 2,250 Sleeps: 2-3

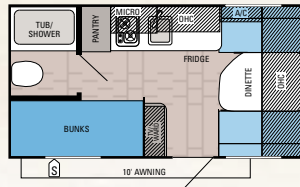

JAY FLIGHT SLX | 154BH

Ext. Length: 17' 10" Ext. Height: 101"
 Unloaded Weight (lbs.): 2,400 Sleeps: 3-4

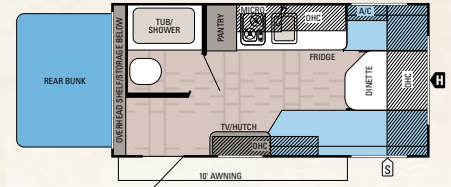

JAY FLIGHT SLX | 165RB

Ext. Length: 18' 10" Ext. Height: 104"
 Unloaded Weight (lbs.): 2,555 Sleeps: 3-4

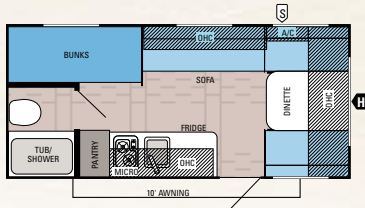

JAY FLIGHT SLX | 184BH

Ext. Length: 20' Ext. Height: 104"
 Unloaded Weight (lbs.): 2,615 Sleeps: 4-5

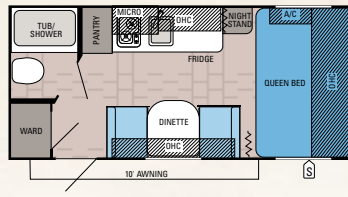

JAY FLIGHT SLX | 185RB

Ext. Length: 20' Ext. Height: 104"
 Unloaded Weight (lbs.): 2,610 Sleeps: 3

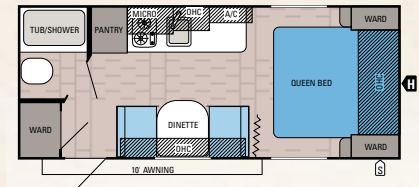

JAY FLIGHT SLX | 195RB

Ext. Length: 21' 8" Ext. Height: 103"
 Unloaded Weight (lbs.): 2,800 Sleeps: 3

8-FOOT-WIDE MODELS

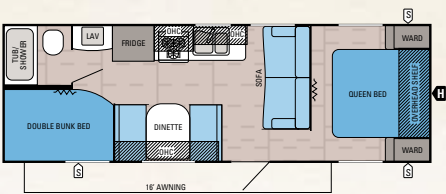

JAY FLIGHT SLX | 264BHW

Ext. Length: 29' 1" Ext. Height: 127"
 Unloaded Weight (lbs.): 4,425 Sleeps: 6-9

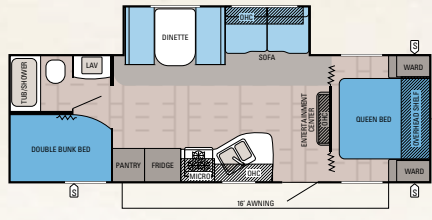

JAY FLIGHT SLX | 267BHSW

Ext. Length: 29' 11" Ext. Height: 132"
 Unloaded Weight (lbs.): 5,505 Sleeps: 6-10

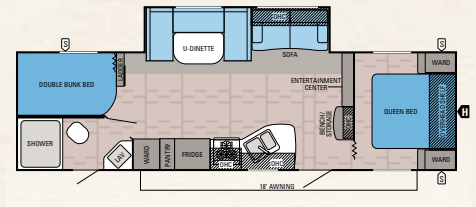

JAY FLIGHT SLX | 287BHSW

Ext. Length: 33' 3" Ext. Height: 134"
 Unloaded Weight (lbs.): 6,065 Sleeps: 6-10

JAY FLIGHT SLX SPECIFICATIONS

MODELS	DIMENSIONS				WEIGHTS (LBS.)				TANKS (GALS.)		
	FLOORPLAN	EXTERIOR TRAVEL LENGTH	EXTERIOR WIDTH	EXT. HEIGHT (WITH A/C)	INTERIOR HEIGHT	UNLOADED VEHICLE WEIGHT *	DRY HITCH WEIGHT	GROSS VEHICLE WEIGHT RATING	CARGO CARRYING CAPACITY	FRESH (INCLUDES WATER HEATER)	GRAY
145RB	16' 6"	85"	101"	73"	2,250	230	2,950	700	16	15	9
154BH	17' 10"	85"	101"	73"	2,400	280	3,200	800	16	15	9
165RB	18' 10"	85"	104"	73"	2,555	220	3,500	945	16	15	9
184BH	20'	85"	104"	73"	2,615	300	3,500	885	26	15	9
185RB	20'	85"	104"	73"	2,610	290	3,500	890	26	15	9
195RB	21' 8"	85"	103"	73"	2,800	280	3,500	700	26	15	9
264BHW	29' 1"	96"	127"	81"	4,425	510	6,500	2,075	48	39	39
267BHSW	29' 11"	96"	132"	81"	5,505	685	7,000	1,495	44	39	39
287BHSW	33' 3"	96"	134"	81"	6,065	641	7,500	1,435	44	39	39

* The weights of certain options and/or option packages are not included in the UWW listed in the specification charts.

Unloaded Vehicle Weight (UWW): Sometimes referred to as "Dry Weight," UWW means the typical weight of this trailer as built at the factory. The UWW, as used in product literature and other promotional materials, does not include cargo, fresh water, propane, options or dealer-installed accessories.

Gross Vehicle Weight Rating (GVWR): GVWR means the maximum permissible weight of the trailer, including the UWW plus passengers, personal items, all cargo, fluids, options, and dealer-installed accessories. The GVWR is equal to or greater than the sum of the UWW and the CCC.

Cargo Carrying Capacity (CCC): CCC means the maximum weight of all passengers, personal items, food, fresh water, propane, tools, other cargo and dealer-installed accessories that can be carried by the trailer. CCC is equal to or less than GVWR minus UWW. The addition of options will decrease the CCC.

Hitch Weight (HW): The hitch weight, as used in product literature and other promotional materials, does not include cargo, fresh water, propane gas, options or dealer-installed accessories. The addition of these types of items will either add to or subtract from the stated hitch weight.

It is important for your safety and enjoyment that your tow vehicle be adequately sized and equipped to tow and handle the GVWR of the RV you select. Review weights and rating of your tow vehicle and consult a competent advisor for questions or advice. Whether you are new to RVing or a veteran, get a feel for the performance of your tow vehicle before heading out on the roadways. When you tow an RV, you must drive differently than when you drive a single vehicle. Practice hooking up, driving, backing up and braking in a safe environment or seek out professional instruction. Jayco affixes a weight label to each RV which lists weight information for that vehicle. See specifications chart above.

JAY FLIGHT SLX STANDARDS AND OPTIONS

7-FOOT-WIDE MODELS

STANDARD EXTERIOR EQUIPMENT

8 1/2' exterior height
.024 mesa crimp exterior aluminum
4" cambered steel box tube frame
Fully integrated A-frame
5/8" seamless floor decking
One-piece, seamless DiFlex II roof material
Amber patio light
Clamp ring, safety-glass windows with automotive gasket seals
Radial tires
Galvanized-steel, impact-resistant wheel wells
Radius-cornered entrance and baggage doors
Double-wide corner mold extrusions
Aerodynamic front profile
Front window with integrated rock guard
DuraTek water-repellent, scratch-resistant, vinyl tent material with zipper windows (165RB)
Powder-coated shepherd's hook tent framing (165RB)
30-amp service
Single 20-lb. propane bottle

STANDARD INTERIOR EQUIPMENT

Screwed-and-glued cabinetry
Wardrobe/pantry storage
Ball bearing drawer guides throughout, 75-lb. capacity with full extension
Laminate countertops with T-mold edging
Acrylic sink
2-burner range
3 cu. ft. Norcold refrigerator with temperature controls
Microwave oven
High-efficiency Atwood furnace
Wall-mounted 8,000-BTU air conditioner
Multi-media premium sound system with MP3/iPod input jacks
Jayco-made dinette cushions and window treatments
Indoor/outdoor dinette table (select models)
Plywood bed platforms
Diamondflor vinyl flooring
Marine toilet with hand flush
Shower curtain with curved shower track (select models)
Wood trimmed mirror in bathroom
Queen bed with bedspread (195RB)
Under-bed storage on main beds
300-lb. rated bunk beds (select models)
4" Denver Mattress bunk mats (select models)
5" high density foam tent mat (165RB)

CUSTOMER VALUE PACKAGE

Patio awning
Front diamond plate
Rear stabilizer jacks (2)
6-gal. gas water heater
Water heater bypass
Range hood
Pleated window shades
Bathroom skylight

8-FOOT-WIDE MODELS

STANDARD EXTERIOR EQUIPMENT

.024 mesa crimp exterior aluminum
4" cambered steel box tube frame
Fully integrated A-frame
5/8" plywood floor decking
One-piece, seamless DiFlex II roof material
13,500-BTU roof-mounted air conditioner
Amber patio light
Clamp-ringed, safety-glass windows with automotive gasket seals
Exterior cable hookup
Radial tires
Galvanized-steel, impact-resistant wheel wells
Radius-cornered entrance and baggage doors
Double-wide corner mold extrusions
Aerodynamic front profile
30-amp service
Dual 20-lb. propane bottles

STANDARD INTERIOR EQUIPMENT

81" ceiling height
Screwed-and-glued cabinetry
Wardrobe/pantry storage
Ball bearing drawer guides throughout, 75-lb. capacity with full extension
Laminate countertops with T-mold edging
6 cu. ft. Norcold refrigerator with temperature controls
Microwave oven
Oven with 3-burner cooktop
Double-bowl kitchen sink with upgraded faucet
High-efficiency Atwood furnace
Multi-media premium sound system with MP3/iPod input jacks
Jayco-made window treatments
Plywood bed platforms
Diamondflor vinyl flooring
Marine toilet with hand flush
Tub surround
Shower curtain with curved shower track (select models)
Wood-trimmed mirror in bathroom
Queen bed with bedspread
Under-bed storage on queen beds
600-lb.-rated bunk beds
4" Denver Mattress bunk mats
Privacy curtains in bunk areas

CUSTOMER VALUE PACKAGE

Power awning
Front diamond plate
Stabilizer jacks (4)
6-gallon gas DSI water heater
Water heater bypass
Range hood
Pleated window shades
Bathroom skylight

OPTIONS

Customer Value Package
15,000-BTU roof-mounted air conditioner
Spare tire



JAY FLIGHT 28BHBE | PLATINUM

Jay Flight

America's top trailer

Jay Flight fulfills every family's camping wish list. With an impressive list of standard features, plus an all-new 2015 Elite Package, Jay Flight delivers comfort in every corner. With so many floorplans to choose from, there's certain to be a fit for your family, including kid-friendly bunk rooms, select model exterior kitchens and SuperSlide models. **LEARN MORE ABOUT THE ELITE PACKAGE ON PAGE 13.**



JAY FLIGHT 32RLDS | OUTSIDE KITCHEN



JAY FLIGHT 32RLDS | FAWN WITH THE ELITE PACKAGE



FIBERGLASS OPTION

New for 2015, Jay Flight features an optional fiberglass package with frameless windows. The front and rear walls are vacuum bonded for extra durability where it's needed most.



JAY FLIGHT 32RLDS | FAWN WITH THE ELITE PACKAGE

JAY FLIGHT 28BHBE | PLATINUM

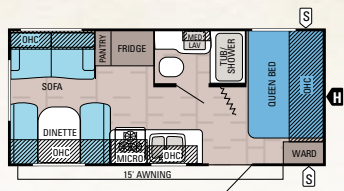

JAY FLIGHT | 19RD **OPTION: H**

Ext. Length: **23' 1"** Ext. Height: **127"** Unloaded Weight (lbs.): **3,715** Sleeps: **4-7**

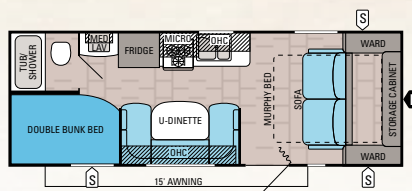

JAY FLIGHT | 23MB **OPTION: D**

Ext. Length: **26' 10"** Ext. Height: **127"** Unloaded Weight (lbs.): **4,200** Sleeps: **4-8**

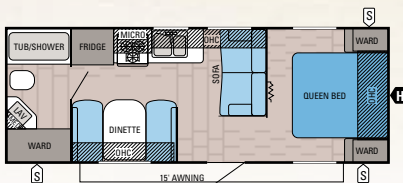

JAY FLIGHT | 23RB **OPTION: I**

Ext. Length: **26' 11"** Ext. Height: **127"** Unloaded Weight (lbs.): **4,015** Sleeps: **4-6**

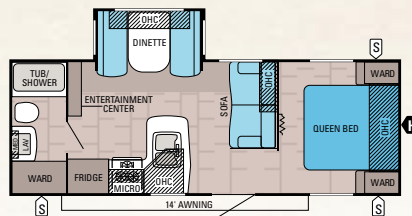

JAY FLIGHT | 24FBS **OPTION: A**

Ext. Length: **27' 5"** Ext. Height: **133"** Unloaded Weight (lbs.): **4,655** Sleeps: **3-6**

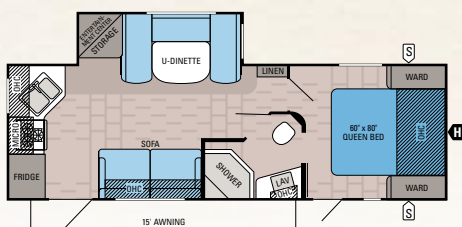

JAY FLIGHT | 26RKS

Ext. Length: **28' 8"** Ext. Height: **135"** Unloaded Weight (lbs.): **5,605** Sleeps: **4-6**

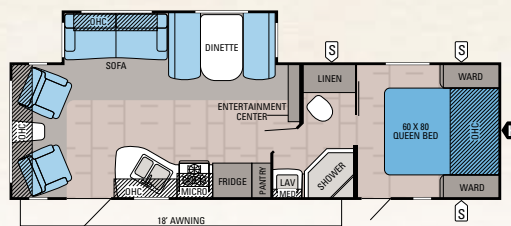

JAY FLIGHT | 27RLS **OPTIONS: A, B**

Ext. Length: **30'** Ext. Height: **135"** Unloaded Weight (lbs.): **6,030** Sleeps: **4-6**

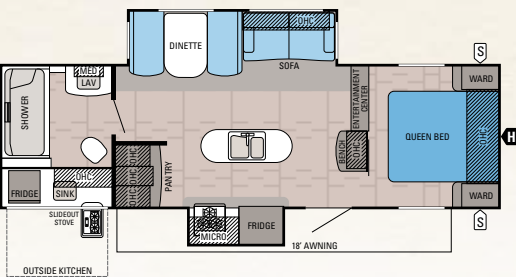

JAY FLIGHT | 28RBDs **OPTIONS: A, B**

Ext. Length: **31' 5"** Ext. Height: **134"** Unloaded Weight (lbs.): **6,455** Sleeps: **4-6**

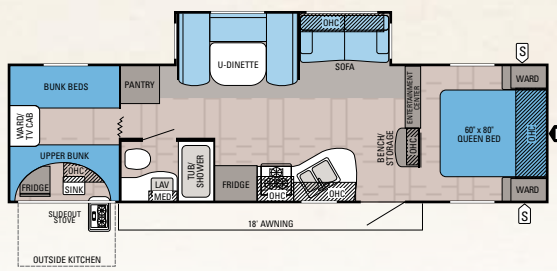

JAY FLIGHT | 29QBS **OPTION: B**

Ext. Length: **34' 9"** Ext. Height: **134"** Unloaded Weight (lbs.): **6,500** Sleeps: **7-9**

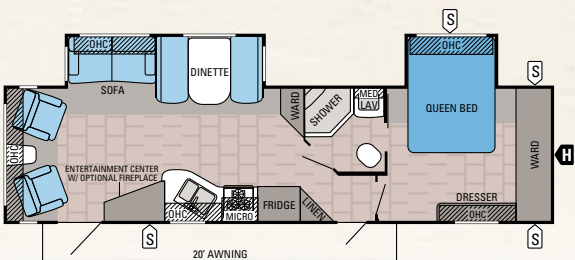

JAY FLIGHT | 31RLDs **OPTIONS: A, B**

Ext. Length: **35' 9"** Ext. Height: **133"** Unloaded Weight (lbs.): **7,285** Sleeps: **4-6**

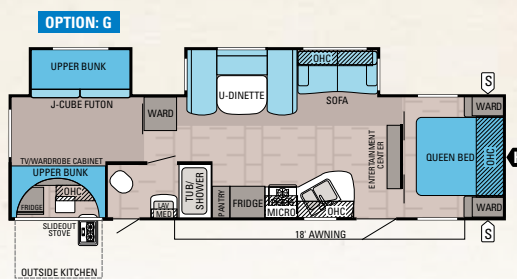

JAY FLIGHT | 32BHDS **OPTION: B**

Ext. Length: **35' 6"** Ext. Height: **133"** Unloaded Weight (lbs.): **7,285** Sleeps: **8-10**

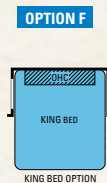
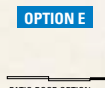
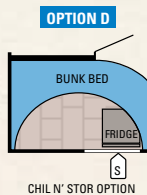
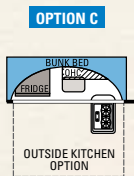

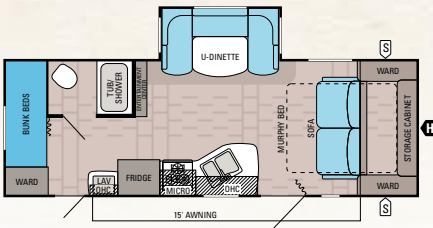

JAY FLIGHT | 23MBH

Ext. Length: 26' 11" Ext. Height: 134" Unloaded Weight (lbs.): 5,045 Sleeps: 4-6

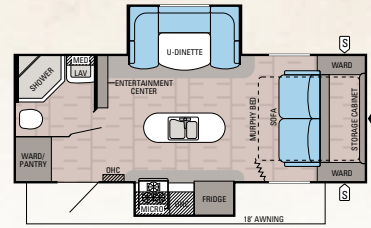

JAY FLIGHT | 23MDS **OPTION: A**

Ext. Length: 25' 9" Ext. Height: 133" Unloaded Weight (lbs.): 5,160 Sleeps: 3-4

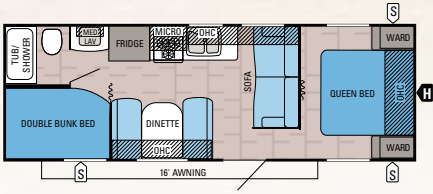

JAY FLIGHT | 26BH **OPTION: D**

Ext. Length: 29' 1" Ext. Height: 127" Unloaded Weight (lbs.): 4,365 Sleeps: 6-10

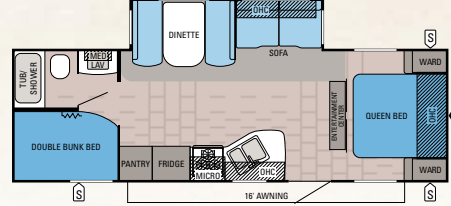

JAY FLIGHT | 26BHS **OPTIONS: A, B, D**

Ext. Length: 29' 11" Ext. Height: 133" Unloaded Weight (lbs.): 5,470 Sleeps: 5-10

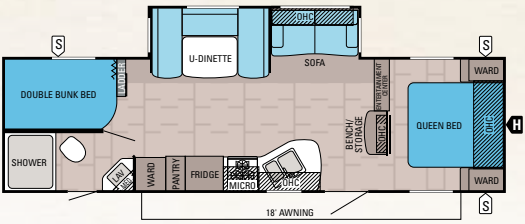

JAY FLIGHT | 28BHBE **OPTION: B**

Ext. Length: 33' 3" Ext. Height: 134" Unloaded Weight (lbs.): 6,135 Sleeps: 8-10

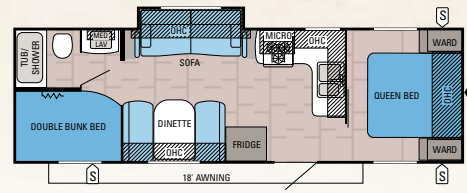

JAY FLIGHT | 28BHS **OPTION: D**

Ext. Length: 30' 11" Ext. Height: 127" Unloaded Weight (lbs.): 4,890 Sleeps: 6-10

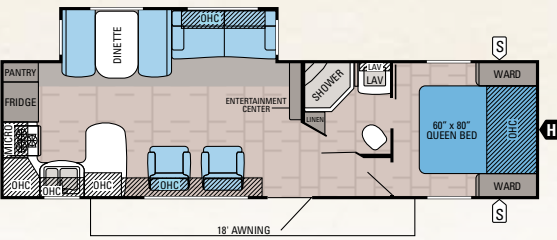

JAY FLIGHT | 29RKS **OPTIONS: A, B, E**

Ext. Length: 33' 6" Ext. Height: 134" Unloaded Weight (lbs.): 6,450 Sleeps: 3-6

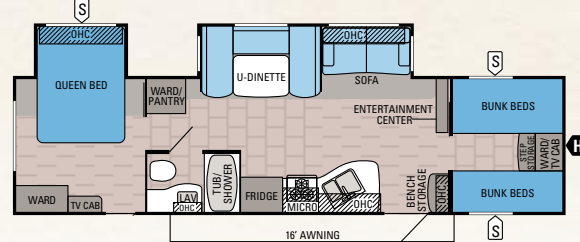

JAY FLIGHT | 31QBDS **OPTIONS: B, C**

Ext. Length: 35' 9" Ext. Height: 133" Unloaded Weight (lbs.): 7,140 Sleeps: 7-10

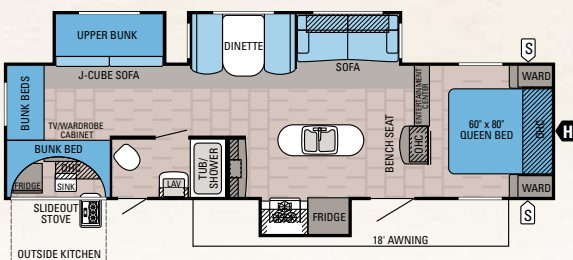

JAY FLIGHT | 32IBTS **OPTIONS: A, B, G**

Ext. Length: 35' 11" Ext. Height: 133" Unloaded Weight (lbs.): 7,710 Sleeps: 8-12

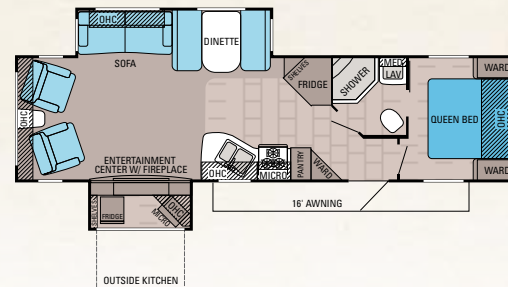

JAY FLIGHT | 32RLDS **OPTIONS: A, B**

Ext. Length: 35' 6" Ext. Height: 134" Unloaded Weight (lbs.): 7,360 Sleeps: 3-6

OPTION J

OPTION K



STORAGE



TRAILER HITCH



BATHROOM SINK

MICRO MICROWAVE

OHC OVERHEAD CABINETS

FRIDGE REFRIGERATOR

WARD WARDROBE

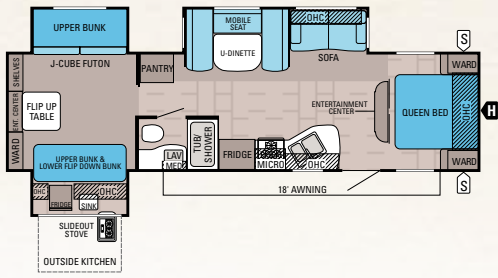

JAY FLIGHT | 32TSB **OPTION: B**
 Ext. Length: 35' 6" Ext. Height: 133" Unloaded Weight (lbs.): 7,785 Sleeps: 11-12

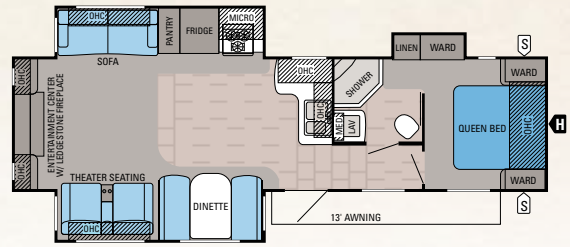

JAY FLIGHT | 33RLDS **OPTIONS: A, B, E**
 Ext. Length: 35' 5" Ext. Height: 133" Unloaded Weight (lbs.): 7,630 Sleeps: 3-6

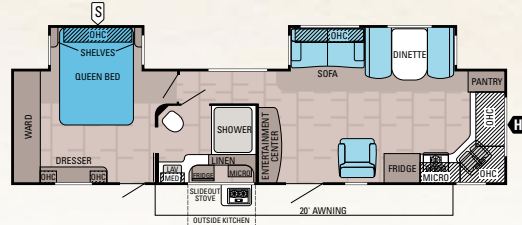

JAY FLIGHT | 34FKDS **OPTIONS: A, B, E, F**
 Ext. Length: 37' 10" Ext. Height: 134" Unloaded Weight (lbs.): 7,795 Sleeps: 3-6

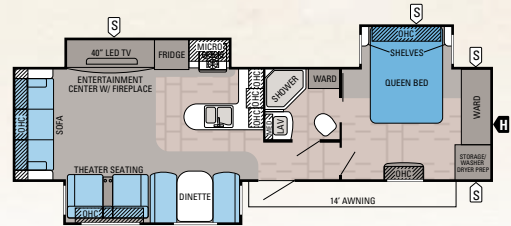

JAY FLIGHT | 34RSBS **OPTIONS: A, B, E, F**
 Ext. Length: 37' 3" Ext. Height: 133" Unloaded Weight (lbs.): 8,100 Sleeps: 4-6

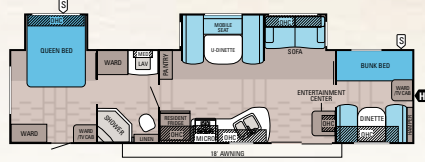

JAY FLIGHT | 36BHDS **OPTION: B**
 Ext. Length: 37' 11" Ext. Height: 133" Unloaded Weight (lbs.): 7,566 Sleeps: 8-10

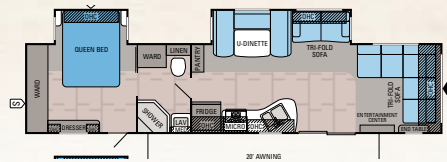

JAY FLIGHT | 38FDDS **OPTIONS: B, J, K**
 Ext. Length: 40' 1" Ext. Height: 134" Unloaded Weight (lbs.): 7,660 Sleeps: 5-8

JAY FLIGHT SPECIFICATIONS

MODELS	DIMENSIONS				WEIGHTS (LBS.)				TANKS (GALS.)			
	FLOORPLAN	EXTERIOR TRAVEL LENGTH	EXTERIOR WIDTH	EXT. HEIGHT (WITH A/C)	INTERIOR HEIGHT	UNLOADED VEHICLE WEIGHT*	DRY HITCH WEIGHT	GROSS VEHICLE WEIGHT RATING	CARGO CARRYING CAPACITY	FRESH (INCLUDES WATER HEATER)	FRESH (INCLUDES WATER HEATER & OPT. FRESH-WATER TANK)	GRAY
19RD	23' 1"	96"	127"	81"	3,715	435	6,000	2,285	48	90	39	39
23MB	26' 10"	96"	127"	81"	4,200	425	6,500	2,300	48	88	39	39
23MBH	26' 11"	96"	134"	81"	5,045	590	7,250	2,205	44	82	39	39
23MDS	25' 9"	96"	133"	81"	5,160	496	7,700	2,540	44	82	32.5	39
23RB	26' 11"	96"	127"	81"	4,015	505	6,250	2,235	48	90	39	39
24FBS	27' 5"	96"	133"	81"	4,655	505	7,000	2,345	48	90	39	39
26BH	29' 1"	96"	127"	81"	4,365	485	7,000	2,635	48	90	39	39
26BHS	29' 11"	96"	133"	81"	5,470	675	7,750	2,280	44	82	39	39
26RKS	28' 8"	96"	135"	81"	5,605	705	8,400	2,795	44	82	39	39
27RLS	30'	96"	135"	81"	6,030	695	8,600	2,570	44	82	39	39
28BHBE	33' 3"	96"	134"	81"	6,135	610	9,250	3,115	44	82	39	39
28BHS	30' 11"	96"	127"	81"	4,890	580	7,250	2,360	48	90	32.5	32.5
28RBDS	31' 5"	96"	134"	81"	6,455	725	9,250	2,795	44	82	78	39
29QBS	34' 9"	96"	134"	81"	6,500	685	9,500	3,000	46	86	39	39
29RKS	33' 6"	96"	134"	81"	6,450	765	9,500	3,050	46	86	78	39
31QBDs	35' 9"	96"	133"	81"	7,140	820	10,250	3,110	46	86	32.5	39
31RLDS	35' 9"	96"	133"	81"	7,285	1,120	10,250	2,965	46	86	39	39
32BHDS	35' 6"	96"	133"	81"	7,285	840	9,975	2,690	46	86	32.5	39
32IBTS	35' 11"	96"	133"	81"	7,710	940	10,500	2,790	46	86	39	32.5
32RLDS	35' 6"	96"	134"	81"	7,360	840	10,250	2,890	46	86	32.5	32.5
32TSBH	35' 6"	96"	133"	81"	7,785	700	10,500	2,715	46	86	32.5	32.5
33RLDS	35' 5"	96"	133"	81"	7,630	995	10,300	2,670	46	86	39	39
34FKDS	37' 10"	96"	134"	81"	7,795	1,010	10,750	2,955	46	86	65	32.5
34RSBS	37' 3"	96"	133"	81"	8,100	1,175	10,950	2,850	46	86	78	39
36BHDS	37' 11"	96"	133"	81"	7,566	920	10,500	2,934	50	90	39	39
38FDDS	40' 1"	96"	134"	81"	7,660	1,110	10,950	3,290	50	90	39	39

* The weights of certain options and/or option packages are not included in the UUV listed in the specification charts.

Unloaded Vehicle Weight (UUV): Sometimes referred to as "Dry Weight," UUV means the typical weight of this trailer as built at the factory. The UUV, as used in product literature and other promotional materials, does not include cargo, fresh water, propane, options or dealer-installed accessories.

Gross Vehicle Weight Rating (GVWR): GVWR means the maximum permissible weight of the trailer, including the UUV plus passengers, personal items, all cargo, fluids, options, and dealer-installed accessories. The GVWR is equal to or greater than the sum of the UUV and the CCC.

Cargo Carrying Capacity (CCC): CCC means the maximum weight of all passengers, personal items, food, fresh water, propane, tools, other cargo and dealer-installed accessories that can be carried by the trailer. CCC is equal to or less than GVWR minus UUV. The addition of options will decrease the CCC.

Hitch Weight (HW): The hitch weight, as used in product literature and other promotional materials, does not include cargo, fresh water, propane gas, options or dealer-installed accessories. The addition of these types of items will either add to or subtract from the stated hitch weight.

It is important for your safety and enjoyment that your tow vehicle be adequately sized and equipped to tow and handle the GVWR of the RV you select. Review weights and rating of your tow vehicle and consult a competent advisor for questions or advice. Whether you are new to RVing or a veteran, get a feel for the performance of your tow vehicle before heading out on the roadways. When you tow an RV, you must drive differently than when you drive a single vehicle. Practice hooking up, driving, backing up and braking in a safe environment or seek out professional instruction. Jayco affixes a weight label to each RV which lists weight information for that vehicle. See specifications chart above.

JAY FLIGHT STANDARDS AND OPTIONS

STANDARD EXTERIOR EQUIPMENT

I-Class cambered structural-steel I-beams with fully integrated A-frame
 Magnum Truss Roof System with one-piece, seamless DiFlex II material
 5/8" tongue-and-groove plywood floor decking
 Two-sided reflective foil insulation in flush-floor slideout floors
 Electric slideouts with enclosed gear system (slide models)
 Large exterior downspouts
 30" x 72" main entrance door
 Power awning
 Exterior marine-grade speakers (2)
 Outside kitchen (select models)
 G20 dark-tint windows
 Radial tires with galvanized-steel, impact-resistant wheel wells
 E-Z Lube axles
 Aerodynamic, rounded front profile with front diamond plate
 Utility lighting system
 30-amp power service
 Stabilizer jacks with sand pads (4)

STANDARD INTERIOR EQUIPMENT

Coat hook by entry door (select models)
 Screwed-and-glued real-wood cabinetry
 Ball bearing drawer guides, 75-lb. capacity and full-drawer extension
 Large 60/40 acrylic kitchen sink with high-rise, brushed-nickel faucet
 Vented kitchen window
 3-burner range with 9,000-BTU SuperBurner and piezo igniter
 Lighted dinette ceiling feature (SuperSlide models)
 Decorative wall light (SuperSlide models)
 Hidden switch command/charging center
 Atwood auto ignition furnace with wall thermostat
 Premium multi-media sound system with AM/FM/CD/DVD player
 Plywood bed, dinette and bunk bases
 J-Steel jackknife sofa
 Diamondflor vinyl flooring
 Residential-grade carpet
 Vented windows in the slideroom end walls (SuperSlide models)
 In-floor ducted heat in the bathroom (SuperSlide models)
 Wooden bedroom doors (select models)
 Denver Mattress pillowtop mattress
 Main bed struts
 300-lb. rated bunks with Denver Mattress bunk mats (600-lb. rating on double bunks) (select models)
 Bunk privacy curtains (select models)
 Vented bunk windows (select models)

CUSTOMER VALUE PACKAGE (MANDATORY)

Power tongue jack
 30-lb. propane bottles with cover (2)
 Outside shower
 Under-mounted spare tire
 13,500-BTU air conditioner
 8 cu. ft. refrigerator (18 cu. ft. residential fridge in 36BHDS)
 Microwave
 Oven
 6-gal. gas/electric DSI water heater (10-gal. in 36BHDS)
 Cable/satellite TV hookup
 Digital TV antenna
 Water heater bypass
 Bathroom skylight
 Bathroom power fan
 Tub surround
 Bedspread

THERMAL PACKAGE

Insulated, heated and enclosed underbelly and 2-sided reflective foil insulation in main roof and slideout floors



THE ELITE PACKAGE

The all-new optional Elite Package features first-time Jay Flight upgrades, like the MOR/ryde CRE/3000 suspension, a SuperSlide model kitchen skylight and a premier kitchen faucet with pull-out sprayer. Raised-panel cabinet doors and hardwood drawer fronts in the kitchen complete the upgrade.

ELITE PACKAGE

MOR/ryde CRE/3000 suspension
 Large entry door grab handle
 LED light on power awning
 Black tank flush
 80-gal. capacity fresh water tanks
 Rear ladder
 Sink covers
 Skylight in kitchen
 Hardwood drawer fronts throughout
 Raised-panel upper kitchen cabinet doors
 Refrigerator insert (n/a 36BHDS)
 Upgraded faucet with pull-out sprayer
 Porcelain stool with foot flush

OPTIONS

Elite Package with hide-a-bed and living room ceiling vent
 Customer Value Package with 15,000-BTU air conditioner
 Aluminum rims
 Fiberglass sidewalls with frameless windows
 Cargo accessory receiver (select models)
 Chil N' Stor outside baggage compartment with 1.7 cu. ft. exterior refrigerator (select models)

Patio door (29RKS, 33RLDS, 34FKDS, 34RSBS)

Electric stabilizer jacks
 Outside bumper-mount grill
 Roof ladder
 28" LED HDTV (select models)
 32" LED HDTV (select models; mandatory on 31RLDS)
 40" LED HDTV (mandatory on 32RLDS, 33RLDS, 34FKDS, 34RSBS; optional on 38FDDS)
 Hide-a-bed sofa with Denver Sleep System (most models)
 Free-standing table with 4 chairs (select models)
 Dinette with folding bunk (32LBTS)
 Linoleum in living area (select models)
 50-amp service (select models)
 2nd air conditioner in bedroom (select models)
 King bed (34FKDS, 34RSBS)
 Queen bed with bunk (19RD)
 Outside kitchen (31QBDS)

JAY FLIGHT INTERIOR DÉCORS

PLATINUM



FAWN



COFFEE

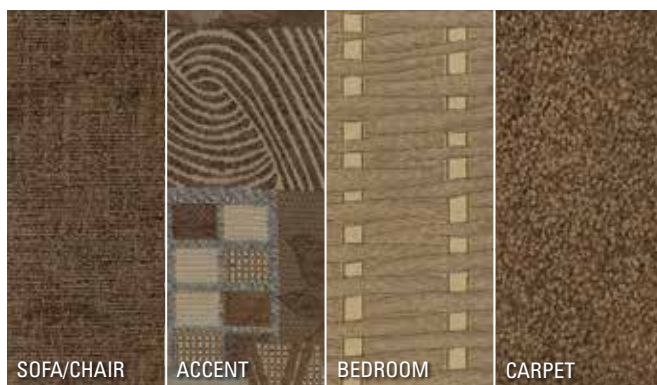

CASHEW



WE START WITH ONE OF THE INDUSTRY'S

Jayco builds on custom-sized frames, designed specifically for each floorplan. Other manufacturers use stock frames, stretching and welding the frame to fit.

Full-width outriggers: We build on full-width outriggers that are spaced 4-6 feet apart (vs. 8 ft.) to better support the weight of the wall.



WALL CONSTRUCTION

hand-tucked insulation

- ① Jayco hand tucks and glues its fiberglass insulation to increase the insulation value near the 2" x 2" wooden studs. Competitors use a blanket-insulation technique.
- ② An optional fiberglass package combines smooth fiberglass with Jay Flight's 2" x 2" wooden studs, lauan and fiberglass insulation. The front and rear walls are vacuum bonded for added durability, while the sidewalls are pinch rolled, creating an affordable package.

strongest foundations

4-6 ft.

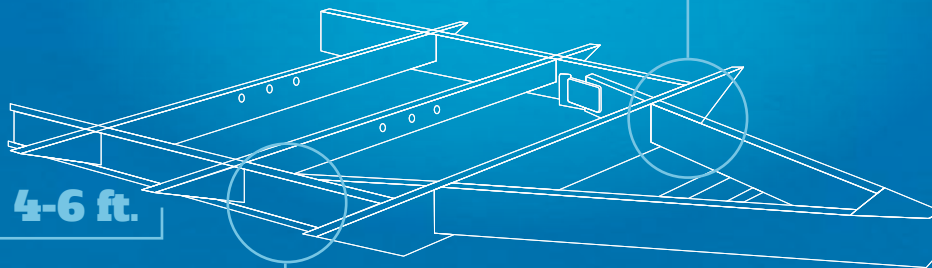

Integrated A-frame: The A-frame runs through the main frame, preventing the hitch from buckling like competing tack-welded frames.

I-Class cambered structural-steel I-beams: Jayco uses a unique molded, one-piece design to prevent the unit from twisting; competing three-piece I-beams can warp over time at the welded seams.

– so that we can build the industry's most reliable RV



JAYCO'S ROOF **vs** OTHER ROOFS



4,500 LBS. ON A JAYCO ROOF VS. OTHER ROOFS

THE MAGNUM TRUSS ROOF SYSTEM **50 percent stronger**

In a side-by-side comparison test, Jayco's exclusive Magnum Truss Roof System withstood 4,500 lbs. — 50 percent more than other roofs. The difference?

- 5 Jayco uses 4 1/2" crowned wood trusses, solid-wood studs and oversized nail plates to maximize the roof's load capacity.
- 6 Then, we screw down 3/8" plywood decking at every seam, a process that is more durable than stapled construction.
- 7 Finally, our one-piece, sidewall-wrapped DiFlex II material provides the ultimate in leak protection.

FLOOR CONSTRUCTION **holds up to the elements**

- 3 Constructed on 5/8" tongue-and-groove plywood on 2" x 3" wooden floor joists and wrapped with a protective moisture barrier, Jay Flight is built to keep the elements out.
- 4 Galvanized-steel wheel wells, not found on competing models, reduce heat loss and prevent damage in case of a blown tire.



TO LEARN MORE ABOUT THE MAGNUM TRUSS ROOF SYSTEM AND TO SEE A SIDE-BY-SIDE ROOF COMPARISON VIDEO, SCAN HERE.

2
YEAR
WARRANTY



Bumper-to-hitch limited warranty*



Jayco[®]

Generations of family fun.

FAMILY fun
starts with peace of mind

At Jayco, we build our RVs to handle every adventure, then we back our products with an industry-leading 2-year limited warranty. You won't find a better warranty in the business because the only strings we attach are those that deliver the ultimate in reliability. That's the Jayco difference. So go explore. We have the warranty that will follow you anywhere.

*For a copy of our 2-year limited warranty with full terms and conditions, please contact your local Jayco dealer.

FREE Roadside Assistance

Travel worry-free with Jayco's Customer First Roadside Assistance program, yours at no cost during the first year of ownership. This program is offered through Coach-Net, the country's largest RV emergency road service, and gives you immediate access to assistance.

eco advantage™

Jayco's long-term commitment to generations of family fun



Scan this QR code with your smartphone to watch a video about our efforts and the impact we're making on our planet.

ecoadvantage.jayco.com

The fun starts with your local Jayco dealer

Your local dealer

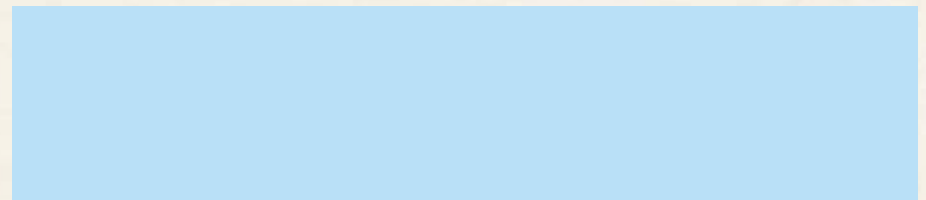

From giving advice to selling and servicing products, we consider our loyal dealers the glue in our family bond. Establishing a solid relationship with your local Jayco dealer is a key component in the enjoyment of your new Jayco. By purchasing from a local dealer, you will have a convenient location for sales, parts and service support. We hope you consider them a part of your camping family.

Follow Jayco



Jayco, Inc., P.O. Box 460, Middlebury, IN 46540, www.jayco.com  See dealer for further information and prices. All information in this brochure is the latest available at the time of publication approval. Jayco reserves the right to make changes and to discontinue models without notice or obligation. Photos in this brochure may show optional equipment and props for photography purposes. RVs built for sale in Canada may differ to conform to Canadian codes. ©2015 Jayco, Inc. 15-JFLT-PL 0315-10K Printed in U.S.A.