

PASSPORT

MINI / SL / GT TRAVEL TRAILERS



 **KEYSTONE**
RV COMPANY

CAMP BETTER
KINDNESS · COMMUNITY · PLANET

LIMITLESS ADVENTURE AWAITS

Step into a world of limitless possibilities with Passport Ultra-Light travel trailers, where towing confidence, agility, and the thrill of spontaneity reigns supreme. Embrace a new level of adventure on the open road, where Passport becomes your gateway to unforgettable journeys. With three distinct product lines, Grand Touring (GT) and Minis, Passport offers options tailored to your preferences and tow vehicle. The GT boasts larger floorplans and enhanced features, while the SL delivers nimble, compact layouts, ensuring an array of choices to match your towing needs and fulfill your desire for exploration.

Discover the joy of effortless travel, and let Passport be your companion in navigating the boundless landscapes of your next adventure.

ALL PASSPORT MODEL FEATURES

*N/A ON MINI FLOORPLANS (170BH & 190RD)

- NEW Exterior Graphics
- LionsHead Radial ST Tires with 1*2*5 Lifetime+ Program and New Wheels
- NEW Dexter TORFLEX Rubber Torsion Suspension Axles *
- NEW 1 1/4" Rear Bumper Accessory Hitch (150lb Max) *
- Power Stabilizer Jacks and Tongue Jack *
- Power Awnings
- Fully Walkable Roof
- Rear Ladder *
- 54 Gallon Fresh Water Tank *
- Norco Frame, Specifically Engineered for Each Floorplan (EASTERN UNITS ONLY)
- Hyperdeck™ High-Performance, Water-Resistant RV Floors
- Heated & Fully Enclosed Underbelly for Extended Season Camping *
- Furrion 15K BTU Chill HE Air Conditioner w/30 Delta T & Alternating Dual Fan *
- TST Tire Pressure & Temperature Monitoring System *
- Girard Tankless On-Demand Water Heater
- Exterior Docking Station *
- Black Glass Entry Door
- Secure Step Entry Steps *
- Giggly Box 12V Distribution Center w/ Battery Disconnect *
- Continuous Edge Countertops
- Stainless Steel Farmhouse Sink *
- NEW 12V refrigerator
- NEW Do-More Portable Dinette * (MOST FLOORPLANS)
- NEW Furrion Kitchen Appliances *
- NEW Sprayer Kitchen Faucet *
- Pillow-Side Shelving to Accommodate CPAP Machine *
- Large Pass-Through Storage w/ Peg Board Storage Panel *
- 12V Smart TV *
- SolarFlex Ready, Protect 220 & Discover 440i Solar Power Packages *
- Winegard Air 360+ Omni-directional Antenna w/ Wi-Fi/4G LTE
- 1-Year Limited Base Warranty & 3-Year Limited Structural
- AlphaPly TPO Roof Membrane – Lifetime Warranty
- Residential Queen Beds (60" x 80") *
- 30,000 BTU Furnace *
- Outdoor camp kitchens include flat top griddle

PASSPORT GT EXCLUSIVE FEATURES

- NEW High-Impact Thermoset Resin Front Cap with LED Lights
- Vaulted Ceilings
- NEW Blackout Roller Shades
- NEW King Bed Slide (TWO MODELS)
- NEW Dinette Storage w/ Drawers
- Convertible Cabinets w/ Hanging Rods & Adjustable Shelves (SELECT MODELS)
- 50AMP Service with 2nd AC Prep
- 15K BTU AC

PASSPORT MINI SINGLE AXLE FEATURES

- NEW Front-end Metal Skin
- SolarFlex Ready (Solar Prep) Standard & SolarFlex Protect 220 Upgrade
- Fully Enclosed Under Belly
- 20,000 BTU Furnace & 13,500 BTU Roof-Mounted AC
- 32" TV
- Rear Ladder Prep
- 2 Burner Cooktop with Hood
- 4 – 3,000lb 24" Stabilizer Jacks
- Large Dish-Ready Kitchen Sink and Bathroom Sink
- Large Entry Door Grab Handle

MINI TRAVEL TRAILERS

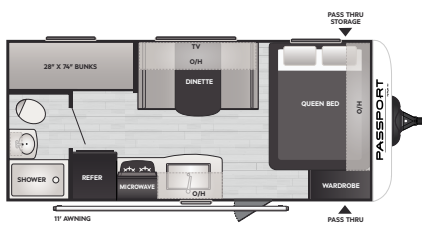

170BH | WEIGHT 3485 | LENGTH 21' 4"

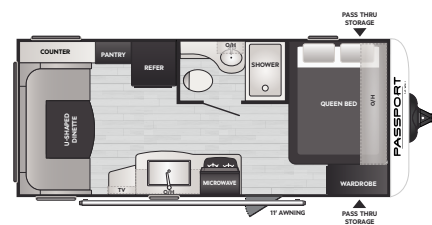

190RD | WEIGHT 3510 | LENGTH 21' 11"

*Pre-Production Estimated Weights & Lengths are Listed; visit Keystonerv.com For the Most Current Specifications.

SUPER-LIGHT (SL) TRAVEL TRAILERS

WE = OREGON PRODUCTION MODEL, SPECIFICATIONS MAY VARY SLIGHTLY

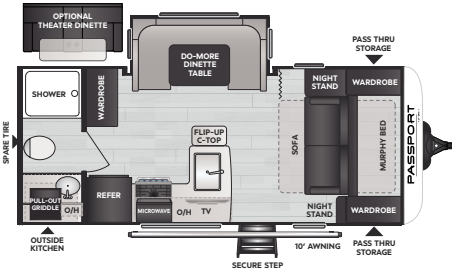

189RB/WE | WEIGHT **4883** | LENGTH **23' 1"**

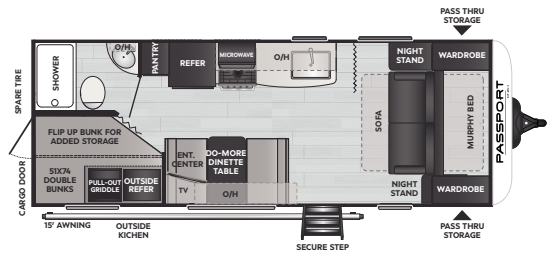

219BH/WE | WEIGHT **4794** | LENGTH **25' 10"**

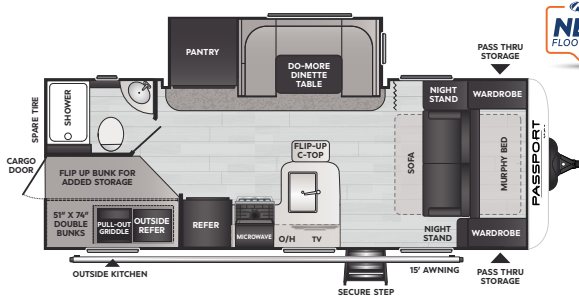

221BH/WE | WEIGHT **5382** | LENGTH **26' 0"**

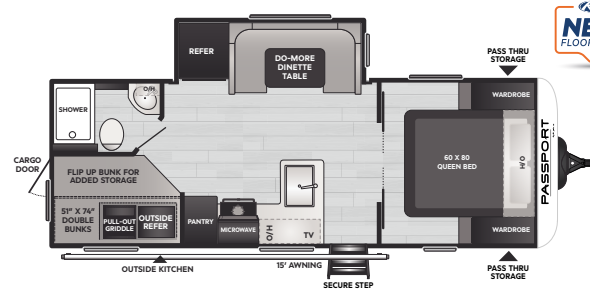

229BH/WE | WEIGHT **5315** | LENGTH **26' 10"**

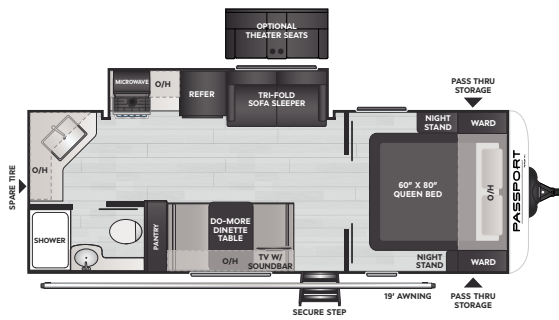

229RK/WE | WEIGHT **5385** | LENGTH **26' 9"**



253RD/WE | WEIGHT **5660** | LENGTH **29' 10"**

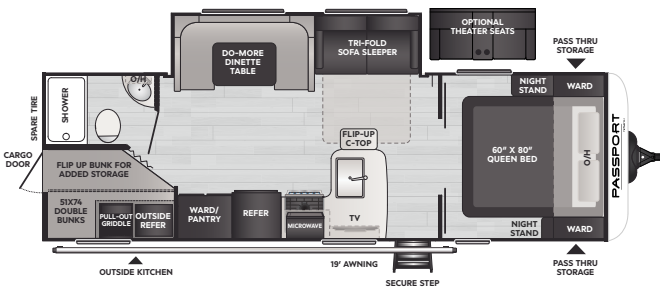

268BH/WE | WEIGHT **6075** | LENGTH **30' 4"**

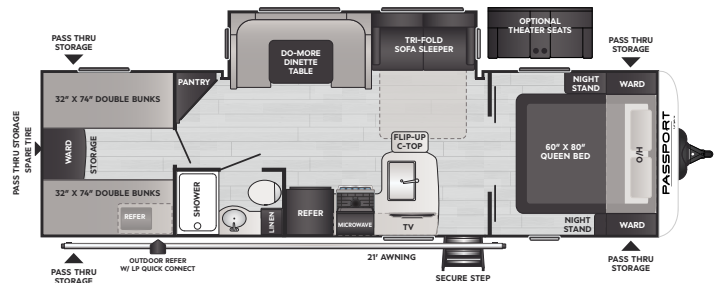

282QB/WE | WEIGHT **6325** | LENGTH **32' 9"**

*Pre-Production Estimated Weights & Lengths are Listed; visit Keystonerv.com For the Most Current Specifications.

GRAND TOURING (GT) TRAVEL TRAILERS

WE = OREGON PRODUCTION MODEL, SPECIFICATIONS MAY VARY SLIGHTLY

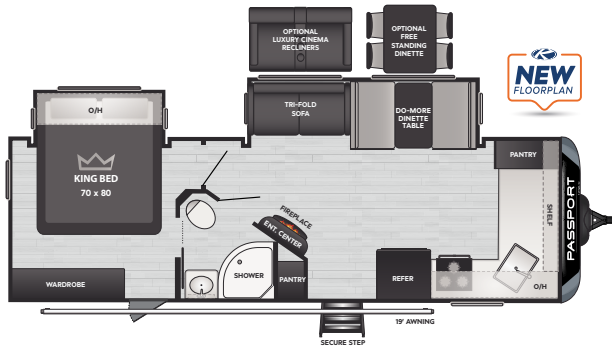

2600FK | WEIGHT 7085 | LENGTH 30' 3"

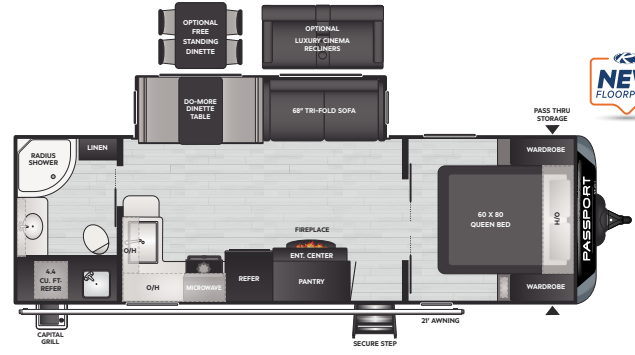

2605RB/WE | WEIGHT 6355 | LENGTH 30' 6"

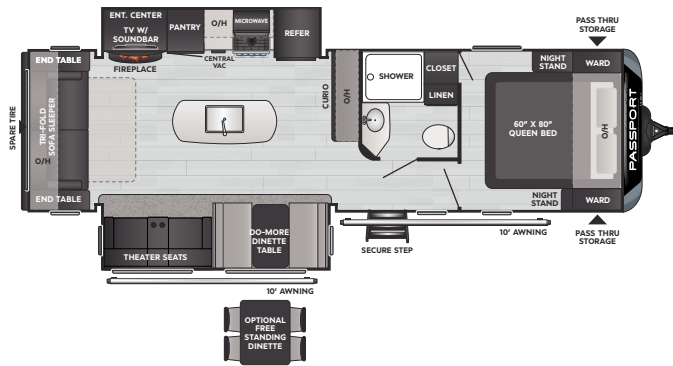

2870RL | WEIGHT 7250 | LENGTH 32' 7"

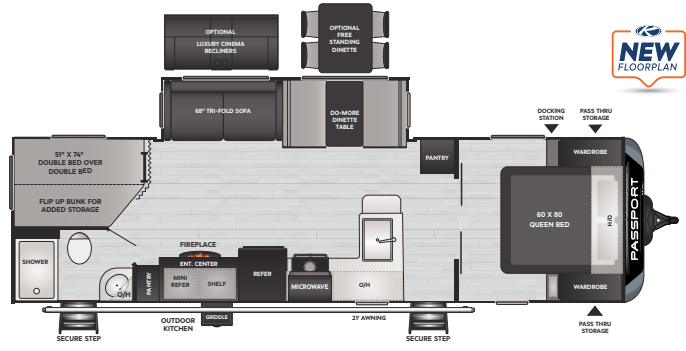

2900BH/WE | WEIGHT 6380 | LENGTH 33' 3"

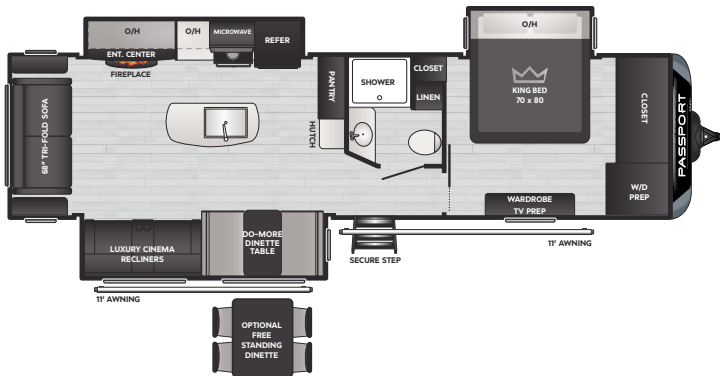

3100RE | WEIGHT 8190 | LENGTH 35' 11"

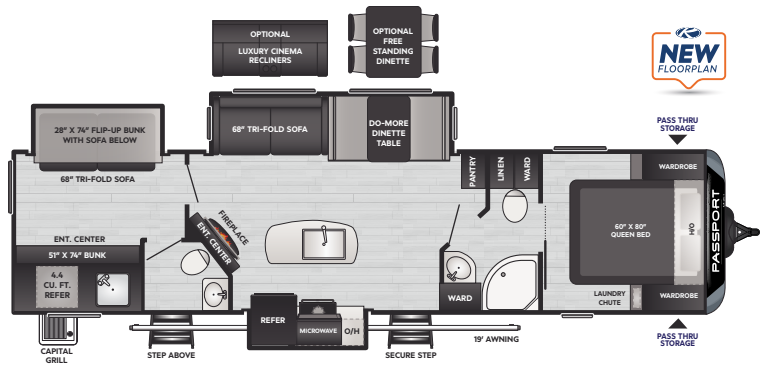

3300BK | WEIGHT 7995 | LENGTH 31' 11"

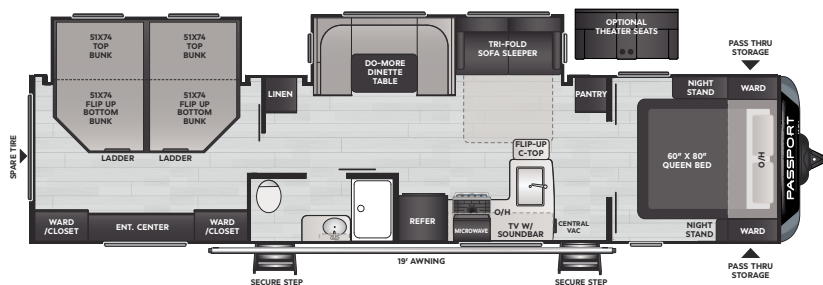

3401QD | WEIGHT 7929 | LENGTH 39' 3"

*Pre-Production Estimated Weights & Lengths are Listed; visit Keystonerv.com For the Most Current Specifications.

KEYSTONE OWNER'S SUPPORT

Keystone makes operating and maintaining your new RV easy with world-class resources and support. Owners have access to a wide variety of support tools and services via the MyKeystone mobile app and the Owner's section of KeystoneRV.com.

FIRST TIME CAMPER'S VIDEO SERIES

A comprehensive guide to RV camping basics with Keystone's Matt & Bart.

PRO TIPS DIY OPERATION & MAINTENANCE VIDEO LIBRARY

Visit our growing collection of step-by-step video and written guides to operating, maintaining, and repairing your Keystone RV.

DIGITAL OWNER'S MANUAL

Our new online owner's manual is fully searchable and features helpful visual and video support.

DIY REPAIR PROGRAM*

Which includes free parts for small repairs within your first year of ownership

1-YEAR LIMITED BASE WARRANTY*

3-YEAR LIMITED STRUCTURAL WARRANTY*

*See KeystoneRV.com for full details. PRO TIP: Owners should work with their dealers or other Keystone authorized service center or mobile tech to document all warranty claims within the warranty period.

VISIT OUR WEBSITE FOR PHOTOS,
360° TOURS, AND FULL PRODUCT DETAILS



PASSPORT SPECIFICATIONS*

*Pre-Production Estimated Weights & Lengths are Listed; visit Keystonerv.com For the Most Current Specifications.

MODEL	WEIGHT	CARRYING CAPACITY	HITCH WEIGHT	FRESH WATER**	WASTE WATER	GRAY WATER	LPG	LENGTH*	WIDTH	HEIGHT	AWNING
170BH	3485	1340	425	37	30	30	20	21' 4"	8'	10' 5"	11'
190RD	3510	1310	420	37	30	30	20	21' 11"	8'	10' 5"	11'
189RB/WE	4883	1547	615	54	30	30	40	23' 1"	8'	10' 8"	10'
219BH/WE	4794	1636	535	54	30	30	40	25' 10"	8'	10' 8"	15'
221BH/WE	5382	1618	685	54	30	60	40	26'	8'	10' 8"	15'
229BH/WE	5315	1685	620	54	38	38	40	26' 10"	8'	10' 8"	19'
229RK/WE	5385	1815	575	54	38	38	40	26' 9"	8'	10' 9"	19'
253RD/WE	5660	1940	835	54	30	60	40	29' 10"	8'	10' 8"	21'
268BH/WE	6075	1525	665	54	38	76	40	30' 4"	8'	10' 9"	19'
282QB/WE	6325	1375	820	54	38	76	40	32' 9"	8'	10' 9"	19'
2600FK	7085	1415	1205	54	38	76	40	30' 3"	8'	11' 3"	19'
2605RB/WE	6355	1245	640	54	38	76	40	30' 6"	8'	11' 1"	21'
2870RL/WE	7250	1550	955	54	38	76	40	32' 7"	8'	11' 3"	10'/10'
2900BH/WE	6380	1220	705	54	38	76	40	33' 3"	8'	10' 8"	21'
3100RE	8190	1410	805	54	38	76	40	35' 11"	8'	11' 2"	11'/11'
3300BK	7995	1805	1165	54	76	76	40	31' 11"	8'	11' 4"	21'
3401QD	7929	1741	980	54	38	76	40	39' 3"	8'	11' 2"	21'

SOLAR FLEX™



NEW 2024 PACKAGE UPDATES

For more information scan the QR code or visit keystonerv.com.

TAKE CHARGE OF HOW YOU CAMP

EXCEPTIONAL QUALITY, IMPOSSIBLY VERSATILE, SolarFlex™ IS SHATTERING CUSTOMER'S EXPECTATIONS OF FACTORY-INSTALLED SOLAR POWER. EXCLUSIVELY AVAILABLE ON ALL KEYSTONE RV MODELS.



Keystone RV is proud to partner with Dragonfly Energy to offer their legendary heated Lithium-ion batteries exclusively on all Keystone models.



FOLLOW US FOR THE LATEST!



DISCLAIMER: Product information is as accurate as possible as of the date of publication of this brochure. All features, floor plans, and specifications in this brochure are subject to change without notice. Please also consult Keystone's web site at www.keystonerv.com for more current product information and specifications. Tow Vehicle Disclaimer. CAUTION: Owners of Keystone recreational vehicles are solely responsible for the selection and proper use of tow vehicles. All customers should consult with a motor vehicle manufacturer or their dealer concerning the purchase and use of suitable tow vehicles for Keystone products. Keystone disclaims any liability or damages suffered as a result of the selection, operation, use or misuse of a tow vehicle. KEYSTONE'S LIMITED WARRANTY DOES NOT COVER DAMAGE TO THE RECREATIONAL VEHICLE OR THE TOW VEHICLE AS A RESULT OF THE SELECTION, OPERATION, USE OR MISUSE OF THE TOW VEHICLE. *Length is defined as the distance from the centerline of hitch pin/coupler to rear bumper of trailer. ** Fresh water capacity includes water heater. Please review owner's manual prior to purchase for more information on service warranties, extended use, towing and maintenance. Owner's manuals can be found at keystonerv.com.

PRINT 10.2023