

Jayco | Jay Flight SLX 8 West Travel Trailer

JAY FLIGHT SLX 8 WEST

#1 SELLING TRAVEL TRAILER FOR 15 YEARS



2+3
YEAR | YEAR
WARRANTY



INTERIOR DESIGN



CLASSIC COTTAGE



Wood



Floor

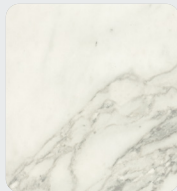

Countertop

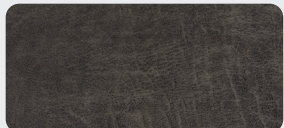

Main Fabric



Accent Fabrics

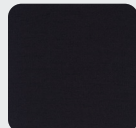

MODERN FARMHOUSE

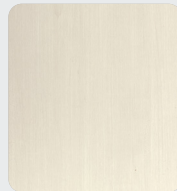

Wood

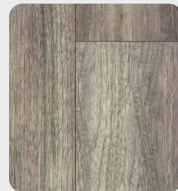

Floor

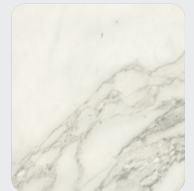

Countertop

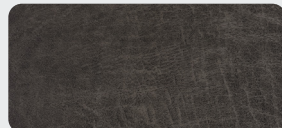

Main Fabric



Accent Fabrics





JAY FLIGHT SLX 8 WEST

212QBW



224BHW



240RBSW OPTIONS: D



242BHSW



264BHW OPTIONS: A

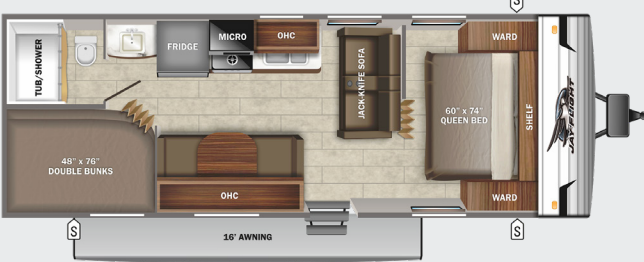

267BHSW OPTIONS: D



275RLSW OPTIONS: B, D



286BHSW OPTIONS: C, D, E



295BHSW OPTIONS: D

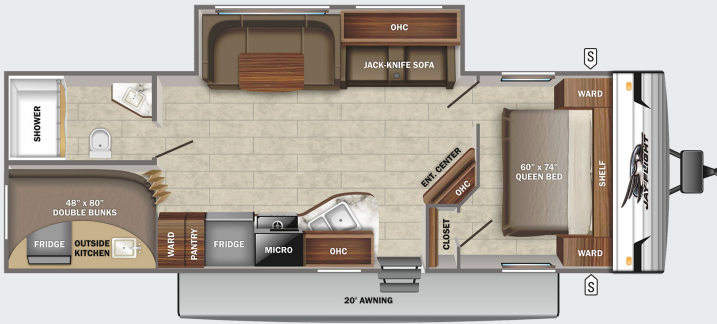

	STORAGE	OHC	OVERHEAD CABINETS
	MICROWAVE	FRIDGE	REFRIGERATOR
		WARD	WARDROBE

OPTIONS

A	B	C	D	E
Chil 'N' Stor	Table & Chairs	Theater Seat	Tri-Fold Sofa	King Bed

STANDARDS & OPTIONS

EXTERIOR

Axles with electric, self-adjusting brakes and E-Z Lube hubs
Galvanized steel, impact-resistant wheel wells
I-Class™ cambered structural steel I-beams
Fully-integrated A-frame
5/8 in. tongue-and-groove plywood floor decking
Magnum Truss™ Roof System with plywood decking
Seamless roof material with 20 year warranty
13,500 BTU roof-mounted A/C
30-amp service
20 lb. propane bottles (2)
Camp kitchen (select models)
Exterior TV mount and bracket
LED exterior lighting
Friction-hinge entry door with shade-prep window
G20 dark tinted safety-glass privacy windows
Detachable power cord

INTERIOR

81 in. ceiling height
Solid hardwood cabinet doors
LED interior lighting
J-Steel™ jackknife sofa with armrest
Vinyl flooring throughout (including slide room floors)
Premium multimedia sound system with MP3/iPod input jacks and Bluetooth® connectivity
Digital TV antenna
Cable/satellite TV hookup
Smoked-glass cabinet door inserts (select models)
Heavy-duty, 75 lb., full-extension, steel ball-bearing drawer guides
Plywood bed platforms
Bedroom doors in place of curtains (select models)
Queen bed struts
Queen mattress
Bedroom LED accent lighting
300 lb. rated bunk beds (select models)
600 lb. rated bunk beds (double bunks only)
Privacy curtains in bunk areas (select models)

4 in. thick bunk mats (select models)
Marine-grade toilet with foot flush
Tub surround
Bathroom exhaust vent
Shower curtain with curved shower track (select models)
Wood-trimmed mirror in bathroom

CUSTOMER VALUE PACKAGE (MANDATORY)

Goodyear® Endurance® tires (made in the USA)
6 gal. gas/electric DSI water heater
Water heater bypass
Front diamond plate
Thermal Package Insulation (insulated & enclosed underbelly, foil insulation in roof)
Keyed-Alike™ entry and baggage doors
Outside shower
Power awning with LED lights
Marine-grade exterior speakers
Black tank flush
Spare tire with cover
Stabilizer jacks (4)
Hitch light
Rooftop solar prep
JaySMART™ (Safety Markers And Reverse Travel) LED lighting (patent-pending)
Large folding entry door grab handle
Power tongue jack
Window shades
Range hood
3-burner range with glass cover
6 cu. ft. gas/electric refrigerator with temperature controls
Oven with glass door and interior light
Microwave oven
Fitted bed sheet
Bathroom skylight

ROCKY MOUNTAIN EDITION (OPTIONAL)

2nd fresh water tank- 80 gal. total capacity
Deluxe colored metal & graphics package

Decorative slide room lighting
8 cu. ft. gas/electric refrigerator
Pull-out kitchen faucet with sprayer
Sink cover and one rolling drying rack
Kitchen backsplash
Bedspread and pillows
Bathroom medicine cabinet
Porcelain foot flush toilet

BAJA EDITION PACKAGE (OPTIONAL)

30 lb. propane bottles (2)
Flipped axle
16 in. Goodyear® off-road tires
Triple tread step

OPTIONS

Rocky Mountain Edition Package
Baja Edition Package
15,000 BTU roof-mounted A/C
50-amp service (286BHSW, 287BHSW & 295BHSW)
Outside griddle
Cargo accessory receiver (N/A 212QBW, 224BHW, 264BHW & 267BHSW)
Aluminum rims (N/A with Baja Edition Package)
Chil N' Stor (264BHW)
MORryde® StepAbove™ entry steps
30 lb. propane bottles (standard with the Baja Edition Package option)
Solar Power Package (100W roof solar panel & 30-amp digital controller)
LED TV
Freestanding table with 4 chairs (240RBSW, 267BHSW & 275RLSW)
Hide-a-bed with tri-fold mattress (267BHSW, 275RLSW, 286BHSW, 287BHSW & 295BHSW)

FLOORPLAN	EXTERIOR TRAVEL LENGTH	EXTERIOR WIDTH	EXTERIOR HEIGHT (WITH A/C)	INTERIOR HEIGHT	UNLOADED VEHICLE WEIGHT	DRY HITCH WEIGHT	GVWR	CARGO CARRYING CAPACITY	FRESH WATER CAPACITY (INCLUDING WATER HEATER)	GRAY WASTE WATER CAPACITY	BLACK WASTE WATER CAPACITY	SLEEPING CAPACITY
212QBW	25' 8"	8' 0"	10' 7"	6' 9"	4,370	490	6,000	1,630	48	39	39	4-5
224BHW	27' 1"	8' 0"	11' 0"	6' 9"	4,460	500	6,000	1,540	48	39	39	7-8
240RBSW	TBD	8' 0"	TBD	6' 9"	TBD	TBD	TBD	TBD	TBD	TBD	TBD	TBD
242BHSW	29' 4"	8' 0"	11' 0"	6' 9"	5,540	720	7,250	1,710	44	39	39	7-8
264BHW	29' 5"	8' 0"	10' 5"	6' 9"	4,775	515	6,500	1,725	48	39	39	8-9
267BHSW	30' 4"	8' 0"	11' 0"	6' 9"	5,830	720	7,500	1,670	44	39	39	8-10
275RLSW	30' 10"	8' 0"	11' 2"	6' 9"	5,825	715	7,800	1,985	46	39	39	3-5
286BHSW	33' 4"	8' 0"	11' 1"	6' 9"	6,310	760	8,150	1,840	46	39	39	8-10
295BHSW	TBD	8' 0"	TBD	6' 9"	TBD	TBD	TBD	TBD	TBD	TBD	TBD	TBD

Meet your Jayco Dealer



Scan QR code for specification definitions

Some specs at the time of print may include estimates. For the most updated information, please visit Jayco.com/rvs/travel-trailers/2022-jay-flight-slx-8

Jayco, Inc. | P.O. Box 460 | Middlebury, IN 46540

See dealer for further information and prices. All information in this brochure and on www.jayco.com is the latest available at the time of publication approval. Jayco reserves the right to make changes and to discontinue models without notice or obligation. Photography may show optional equipment or props used for decoration purposes only. RVs built for sale in Canada may differ to conform to Canadian codes. JAYCO and the JAYCO BIRD IN FLIGHT are registered trademarks of Jayco, Inc. Printed in USA 11/21 ©2021 Jayco, Inc. 257079



Jayco - Part of the Jayco Family of Companies