



THE ULTIMATE OWNERSHIP EXPERIENCE



RW-4150RD Front Kitchen in Linen Cabinets

Redwood RV is the number one retail sold Luxury FW in North America, with good reason. Not only do we offer the strongest foundation, the most innovative technologies and the most luxurious full time living amenities, we also ensure that our customers are in constant communication with our dealers/owner relations/warranty division for the best care.

Redwood offers our customer the best ownership experience by offering over 2,000 service centers throughout North America along with our resourceful Owners Group. You can access our current dealers, and or your closest service center online within seconds, or simply give us a call.

Welcome to the Redwood family. We are a team from the beginning of your purchase, through your journeys along the road.



The CrossRoads limited base warranty covers your RV for a period of (2) years from the date of purchase by the original owner. Transferable during the warranty period. The limited warranty covers defects in materials & workmanship supplied by and attributed to CrossRoads' manufacturing & assembly of the RV.

ONE-STOP WARRANTY CLAIMS PROCESSING, INCLUDING SUPPLIER WARRANTIES.*

The limited structural warranty covers your RV for a period of three (3) years from the date of purchase by the original owner. Transferable during the warranty period. The structural warranty covers defects in materials and workmanship attributable to CrossRoads RV manufacturing and assembly of the structural portion of your RV.

Custom Shower with Teak Bench



King Bed with Tilt in the 4001LK



3401RL Kitchen in Linen Cabinets



3901WB Interior in Linen Cabinets



Dual Vanity Bathroom in the 4001LK



4001LK Kitchen in Linen Cabinets



Living Area in Stonemist Decor



Passthrough with Easy Access



4150RD in Midnight Decor

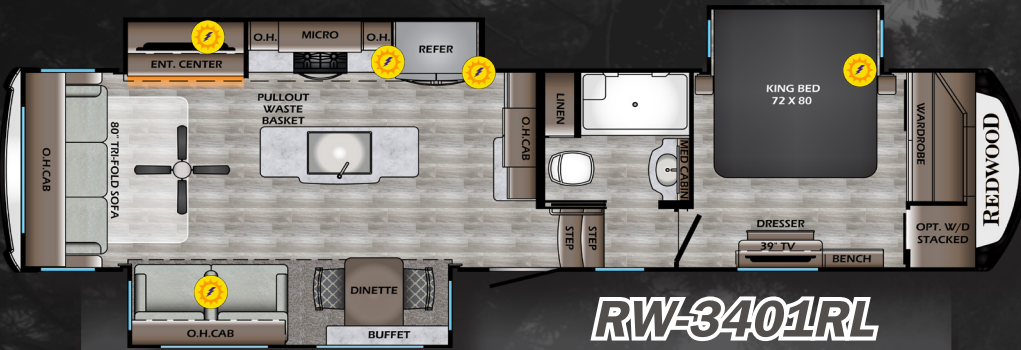

RW-3401RL

WEIGHT	LENGTH	HEIGHT	FRESH W	BLACK W	GRAY W	HITCH
13246	36' 8"	13' 6"	66 Gal	45 Gal	88 Gal	2362

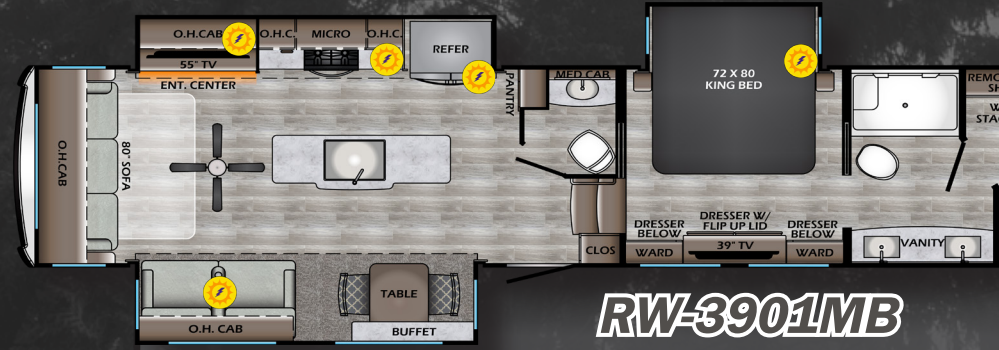

RW-3901MB

WEIGHT	LENGTH	HEIGHT	FRESH W	BLACK W	GRAY W	HITCH
14402	40' 2"	13' 6"	66 Gal	88 Gal	88 Gal	2570

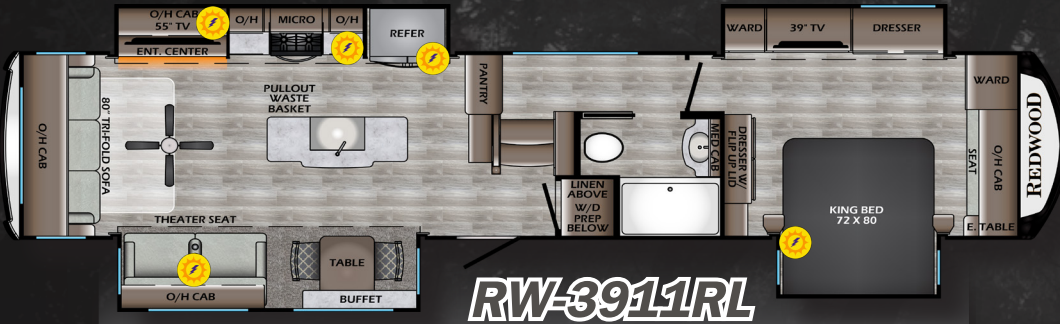

RW-3911RL

WEIGHT	LENGTH	HEIGHT	FRESH W	BLACK W	GRAY W	HITCH
14312	40' 2"	13' 6"	66 Gal	44 Gal	88 Gal	2412

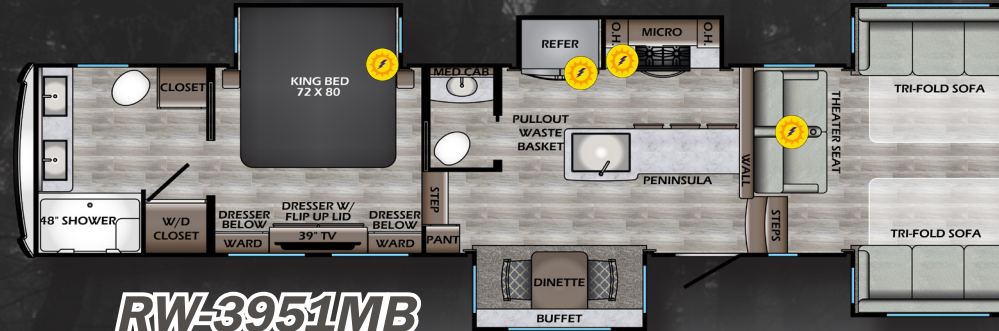

RW-3951MB

WEIGHT	LENGTH	HEIGHT	FRESH W	BLACK W	GRAY W	HITCH
14940	42' 4"	13' 6"	66 Gal	82 Gal	82 Gal	2778

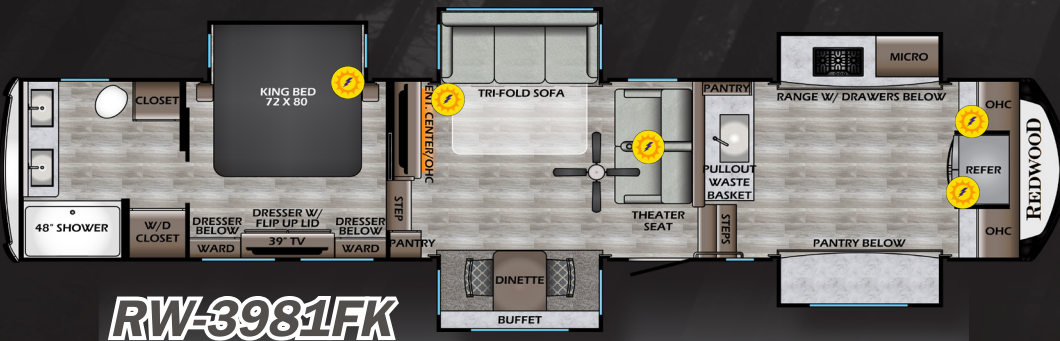

RW-3981FK

WEIGHT	LENGTH	HEIGHT	FRESH W	BLACK W	GRAY W	HITCH
14652	42' 2"	13' 6"	66 Gal	44 Gal	88 Gal	2824

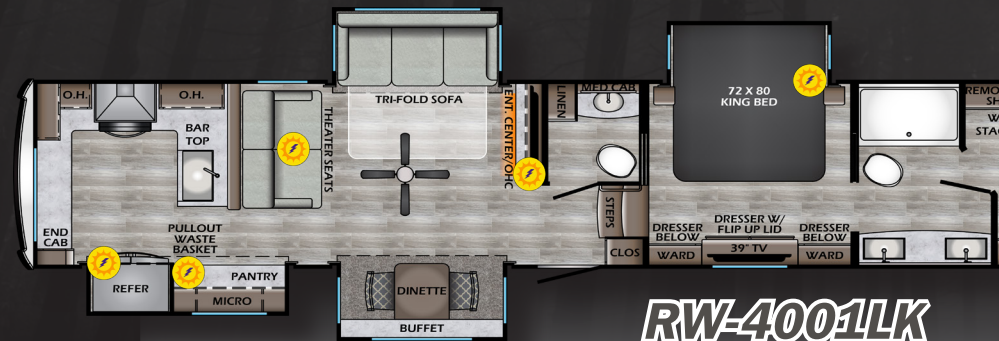

RW-4001LK

WEIGHT	LENGTH	HEIGHT	FRESH W	BLACK W	GRAY W	HITCH
14902	42' 10"	13' 6"	66 Gal	89 Gal	82 Gal	2914



Locations with this symbol denote powered outlets/appliances with inverter



RW-3901WB

WEIGHT	LENGTH	HEIGHT	FRESH W	BLACK W	GRAY W	HITCH
14312	40' 2"	13' 6"	66 Gal	44 Gal	88 Gal	2412

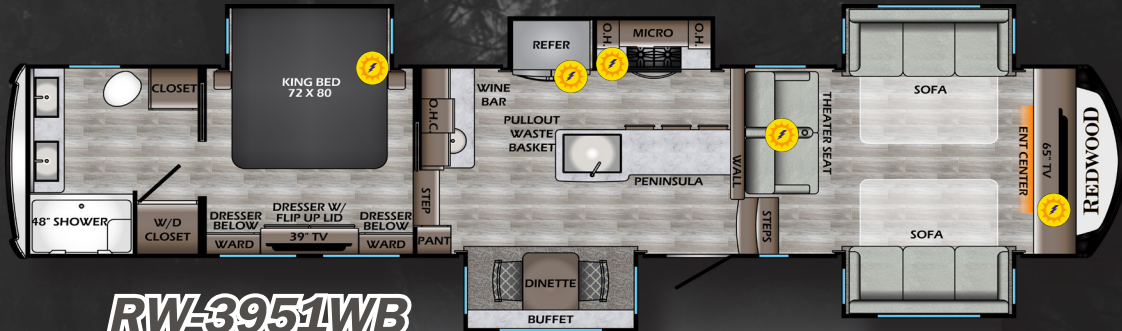

RW-3951WB

WEIGHT	LENGTH	HEIGHT	FRESH W	BLACK W	GRAY W	HITCH
14806	42' 4"	13' 6"	66 Gal	44 Gal	82 Gal	2736

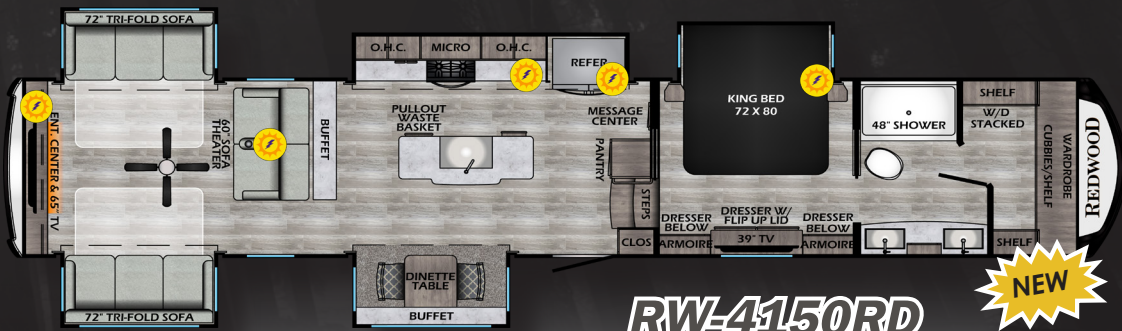
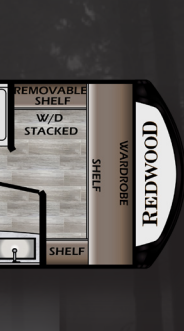

RW-4150RD



WEIGHT	LENGTH	HEIGHT	FRESH W	BLACK W	GRAY W	HITCH
15726	44' 10"	13' 6"	62 Gal	44 Gal	82 Gal	2824

Relax. You're iN-Command

- ✔ Never lose your controller
- ✔ Unlimited Users
- ✔ When you have your phone, you're iN-Command

iN-Command embraces the next generation of controls for your Redwood RV by acting as the central hub of operations and puts you at the helm using your preferred smart device. For more info go to in-command.net



Winegard Air 360+ V2
 Nationwide 4G LTE Data Plans
 w/ Winegard Connect 2.0 -
 Compatible w/ Most Data Plans



- Increased WiFi Range
- Powerful
- Internet While On-The-Go
- Secure RV Internet
- No Contract
- Nationwide 4G LTE Coverage
- AM/FM Radio



To Learn More!

REDWOOD

PAINT COLORS:

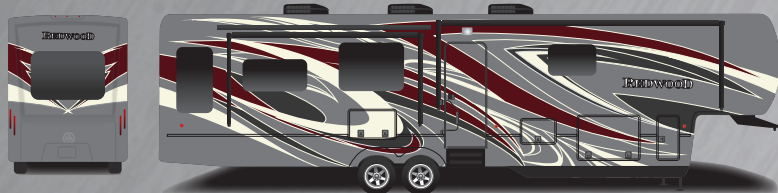

CRIMSON SKY

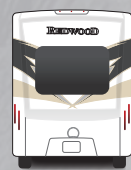

MOONLITE SKY



IVORY SKY



SAPPHIRE SKY



CLASSIC

REDWOOD
LUXURY VEHICLES

STONEMIST

 COUNTERTOPS	
 FLOORING	

REDWOOD
LUXURY VEHICLES

MIDNIGHT

 COUNTERTOPS	
 FLOORING	

REDWOOD
LUXURY VEHICLES

FROSTED

 COUNTERTOPS	
 FLOORING	

CABINET COLOR OPTIONS



Cannon



Linen

TV COAX SYSTEMS MADE EASY WITH KEYTV

KeyTV functions as the “brain” of the system into which you plug the satellite feeds. The roof mounted antenna is already pre-wired into the system. KeyTV identifies over-the-air, cable and satellite signals and sends each signal to the TV outlets located throughout the RV. A color-coded coax cable runs from the KeyTV box to each TV location with no splitters or jumpers to degrade the signal. Inside and outside connection points are clearly labeled. There’s no need for a “booster button” as KeyTV senses the signal source and automatically boosts the over-the-air signal. Unlike other systems, each TV location is satellite TV capable. KeyTV is compatible with DISH, Direct TV, Shaw, and Bell satellite systems.

The next time you sit down to watch the game in your CrossRoads RV equipped with KeyTV; relax. Switching between antennae, cable or satellite is as easy as pie.

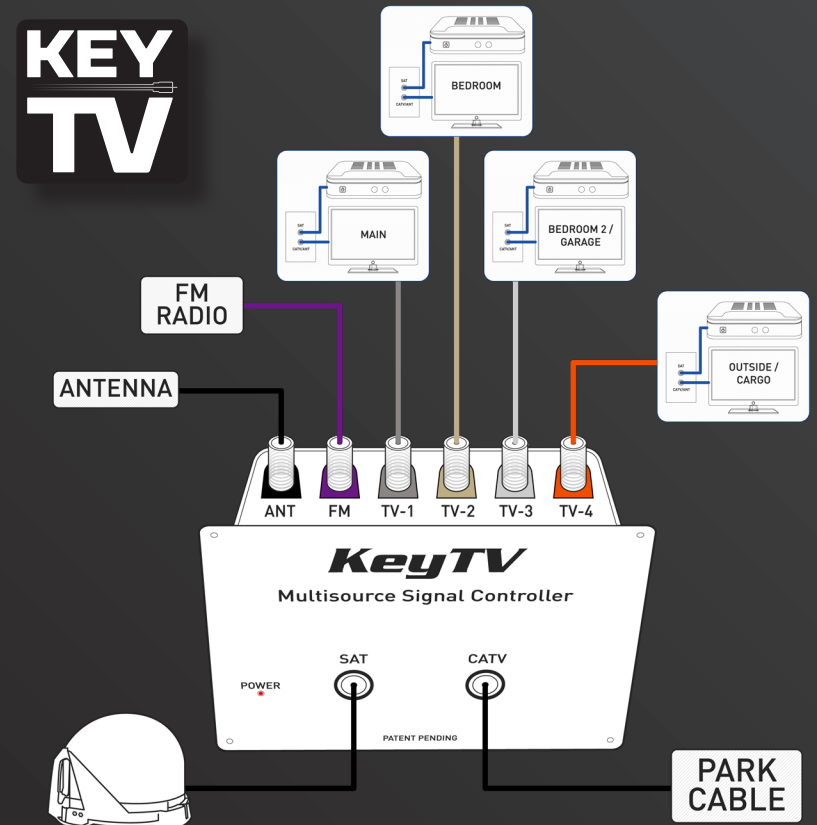

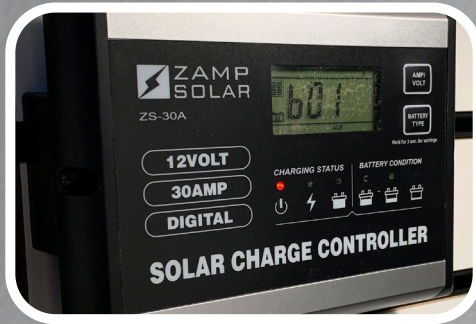

ZAMP SOLAR

Dual inputs for solar hookup on roof and sidewall of each Redwood RV. Roof solar panels pre-installed is a popular option.

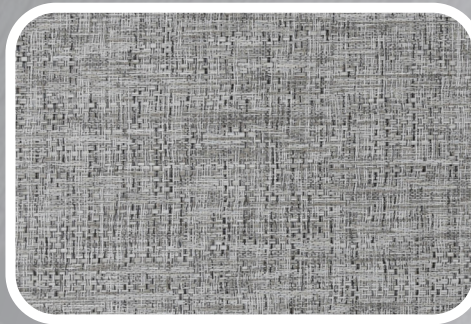

BOAT FLOORING

Marine grade flooring in slide outs allows for much more moisture resistance



WATER MANIFOLD

- Improved Efficiencies
- Direct Lines to Plumbing Fixtures
- Dedicated Shut-Off Valves
- Residential Pex Water Lines

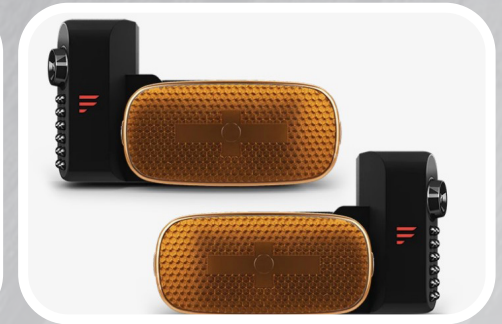

BLIND SPOT MONITORING

Prepped for Furrion Vision S Obstruction



NEW UPGRADED STOVE

- Right Front Burner 12K BTU
- Right Rear Burner 3.5K BTU
- Left Front Burner 9K BTU
- Left Rear Burner 6K BTU w/ 3.7 Ft³ Oven



BED TILT SYSTEM

- Creates more space around foot of bed
- Adapt to your comfort level
- Easily sit up in bed

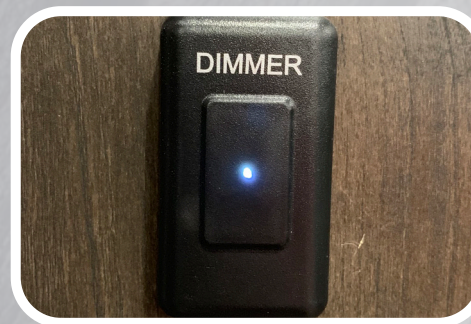

DIMMER SWITCH

Adjust lighting in your Redwood RV with the touch of a finger. Long press to dim, while tapping once will turn them on/off.



WIRELESS CHARGERS

As simple as setting down your phone... Place any Qi enabled wireless device on the charging station to instantly begin recharging your device.



C-PAP SHELF

Bedrooms now come standard with bedside shelves large enough for C-Pap machines.

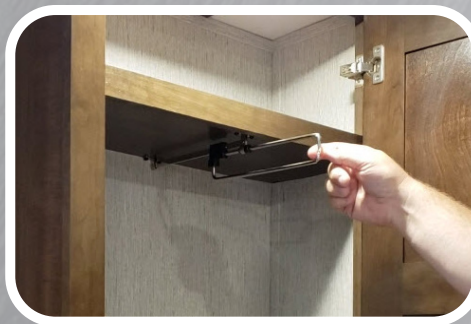

PULLOUT HANGARS IN CLOSET

Maximize your hanging clothes space in the bedroom. These new style closets are available in most Redwood floorplans.



SMART 4K HDTV

- Built in Roku to Stream your Favorite Content
- Cast to TV from your Smart Device



CENTRAL VAC SYSTEM

No need for a dust pan when using the equipped central vac system built into the solid surface steps of your Redwood RV.

THE FOUNDATION OF LUXURY

Our F.I.T. 2.0 Chassis is made from the best components available!

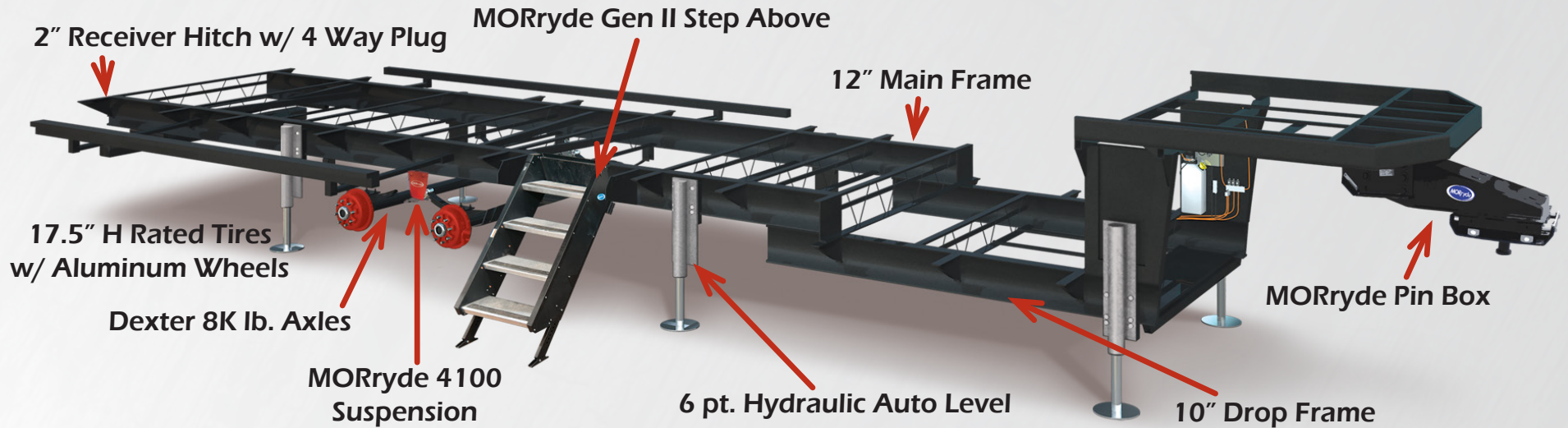

Falcon Integrated Technology (FIT 2.0) ensures quality down to the smallest of details. All components of the FIT 2.0 chassis system are sourced from industry leading manufacturers, producing one of the industry's most sought-after foundations.

Additionally, having a custom chassis system from industry leaders allows for the use of many industry firsts. This keeps the features and technology of the FIT chassis at the forefront of the best the RV industry has to offer.

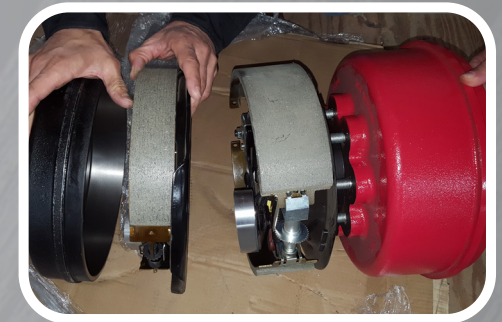

ENLARGED BRAKES



LRE 4100 SUSPENSION W/ WET BOLTS

The Best *Cooling* Efficiency Period!

Dual Zone System

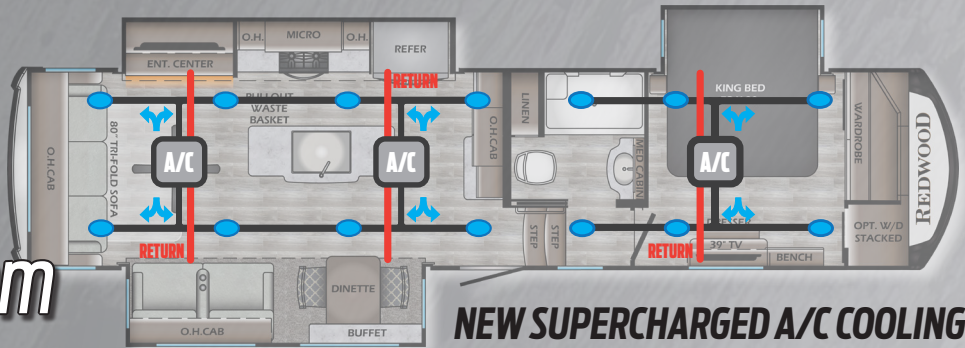

Why have this?

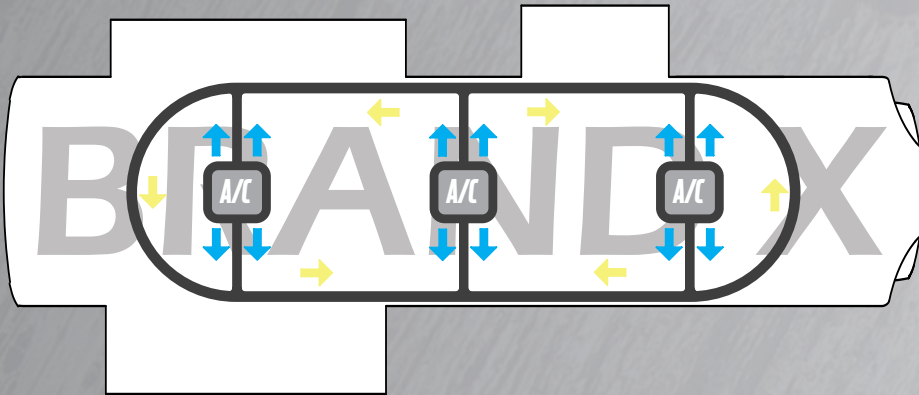

Choose Redwood and get the efficiency you deserve!

Redwood RV's exclusive A/C system provides users with the best efficiencies in the industry.

- Power Management System - Detects Amp Service & Regulates A/C Usage Automatically
- 2 Zone Living = Shorter distances for energy to travel = Maximum Efficiency
- (3) 15k BTU Whisper Quiet A/C Units
- Reinforced Insert Duct Joints - Strengthens & Maximizes Airflow
- Insulated A/C Duct Work - Keeps Cold Air Colder Longer & Reduces Sweating

01 SUPERCHARGED A/C COOLING

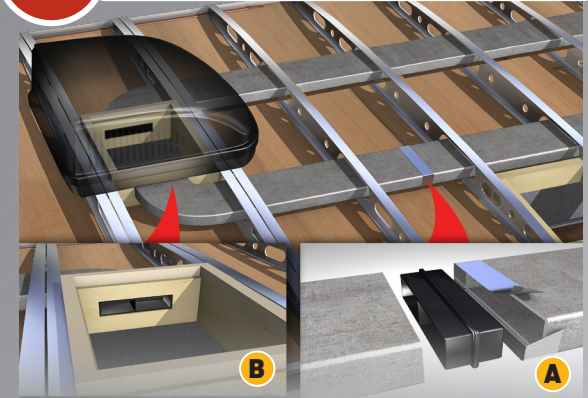

TUF-LOK THERMOPLASTIC COUPLERS FORM A PERMANENT, CRUSH-RESISTANT SEAL IN YOUR AIR-CONDITIONING DUCT

- **A.** Securely joins ductwork and air-conditioning units, crush resistant design won't pull apart due to rough roads, heat and stress
- **B.** Drastically reduces chilled-air leaks to boost cooling efficiency and comfort

03 PERFECT-FIT SLIDE TECHNOLOGY



PERFECT FIT FIVE-POINT SLIDE ROOM CONSTRUCTION BACKED BY THE INDUSTRY'S BEST 3-YEAR LIMITED STRUCTURAL WARRANTY

- Designed to eliminate drag on Carpet and Lino
- Bulb seal slides into track vs. being glued into place
- Rain channels direct rain away from the slide openings
- Composite slide-room "glide" bar enables the room to move with no binding
- Reinforced roof, walls and floor
- Beefed-up aluminum header above slide room for greater strength

02

UNIFIED WIRING SYSTEM



REDWOOD INCORPORATES COLOR-CODED AND NUMBERED ELECTRICAL WIRING ON ALL PRODUCTS

- Creates a clean, well organized wiring layout
- Makes it easy to trace electrical circuits and saves troubleshooting time

04

RAIN BAY TESTED



RAIN BAY TESTED

- Rain bay testing ensures the unit has no leaks when it leaves the facility

The Best Heating Efficiency Period!

REAL TEMPERATURE TESTED!
NO VAGUE/SUBJECTIVE R-VALUES



- A/C SYSTEM TESTED IN 110° ENVIRONMENT*
- FURNACE TESTED IN 0° ENVIRONMENT*

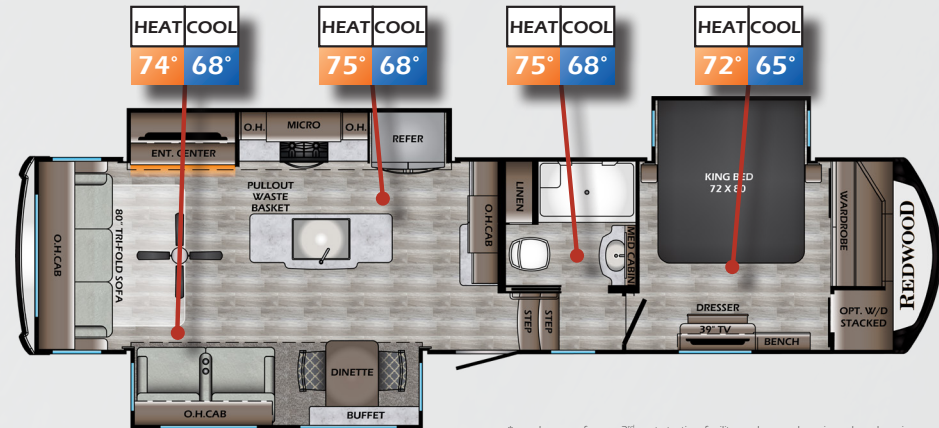

*numbers are from a 3rd party testing facility and were done in a closed environment

Choose Redwood and get the efficiency you deserve!

3 Sources of Heat for Maximum Heat Efficiency

- 35,000 BTU Energy Efficient Furnace:
 - Floor Ducted Heat Run - Spans Entire Length of Unit - Evenly Distributed Heat
 - Water Lines Ran Into Floor & Run Parallel to Ducted Heat - Keeps Lines from Freezing
 - Dedicated Heat Runs for Both Sub-floor (Tanks) & Pass Through Storage
- 5,300 BTU Electric Fireplace - Easily Heats up to 1,000 ft²
- Heat Pump Dedicated for Both Bedroom & Bathroom

STANDARDS AND OPTIONS:

KITCHEN & APPLIANCES

- Coleman Mach 15 Power Saver - Q Series
- Hardwood Stiles Pre-Drilled & Screwed Together
- Residential Sized Storage Drawers
- Pots & Pans Storage
- EGS Steel Backed Cabinet Anchors
- LG Solid Surface Countertops
- High Rise Faucet w/ Pull Out Sprayer
- Over-Island Lighting
- 18 Ft³ Residential Refrigerator - w/ 2000W Inverter
- 18 Ft³ Norcold Side-by-Side Refer & Ice Maker - w/ 2000W Inverter
- Insignia 3.7 Ft³ Oven w/ 4 Burner Cook Top
- 30" Convection Microwave w/ Exhaust Fan
- Max Air Fan w/ Rain Sensor

BEDROOM

- Gel Foam King Bed w/ MORryde Bed Tilt
- 110v Outlets on Both Sides of Bed
- USB Ports on Both Sides of Bed
- C-PAP Shelves on Both Sides of Bed
- Residential Dresser w/ Drawers
- Walk-In Closet with Shelving (VBM)
- Night Roller Shades
- Coleman Mach 15 Power Saver - Q Series w/ Heat Pump A/C

LIVING AREA

- Coleman Mach 15 Power Saver - Q Series
- Williamsburg Furniture Collection:
 - » Residential Style Sofa & Powered Theater Seating
 - » Buffet -Style Adjustable Dinette w/ Leaf Extension
 - » 2 Premium Dinette Chairs
 - » 2 Folding Dinette Chairs
- 55"-65" 4K Smart HDTV (VBM)
- 2 USB Ports Beside Sofa
- Wireless Charging Pad
- 5,100 BTU Fireplace
- Winegard Air 360+ w/ WiFi Extender & 4G Gateway

BATHROOM

- 48" Custom Shower w/ Folding Teak Seat
- Domed Skylight in Shower
- Porcelain Foot Flush Toilet
- Heat & A/C Duct in Bathroom
- Max Air Fan w/ Rain Sensor (N/A on 3981FK & 4001LK)
- Residential Rain Shower Head w/ Sprayer
- LG Solid Surface Countertops

GENERAL INTERIOR

- iN-Command™ Global Automation System
- Solid Hardwood Slide Fascia
- 7' Interior Slide Room Height
- Energy Efficient 35,000 BTU Furnace
- Residential Linoleum
- Magnetic Door Stops
- Blade Pure Airflow System w/ Merv 9 Filtration

CONSTRUCTION

Chassis

- Custom FIT 2.0 Chassis
 - » Falcon 12"/10" I-Beam Drop Frame
 - » Falcon Hydraulic Slide Out System w/ Manual Override (Main Slides)
 - » Dexter 8,000 lb. Axles
 - » Falcon 2" (3,000 lb.) Receiver Hitch
 - » MORryde Pinbox
 - » MORryde LRE 4100 Suspension System
 - » MORryde Lift Assist Steps
 - » 6-Point Hydraulic Jacks w/ Auto Leveling
 - » Sailun 17.5 H Rated 16 Ply Tires
 - » 3-3/8" Self-Adjusting Drum Brakes
 - » 17.5" Wheels

Sidewalls

- Z-65 True Gel Coat Exterior
- 2" Laminated Wall
- Sanded Block Foam Insulation
- Double Welded Aluminum Frame
- Double Luan Backer

Floor

- 5/8" Floor Decking
- 3" Aluminum Subfloor - 11" on Center (VBM)
- 2 Layers of Batten Fiberglass Insulation
- 1 Layers of Radiant Tech Foil Insulation
- Darco Moisture Barrier
- Corrugated Underbelly w/ Tech Foil
- Fully Enclosed & Heated Underbelly

Roof

- One Piece Alpha-Ply Roof Material (Lifetime Warranty)
- 5" Reinforced Trussed Roof Rafter System
- Double Trusses at each A/C
- 3/8" Roof Decking
- Batten Fiberglass Insulation
- Radiant Tech Foil Insulation
- Fully Walkable

General Exterior

- Front & Rear Insulated Fiberglass Caps
- LED Pin Box Light
- 2nd Power Awning w/ LED (VBM)
- Docking Station w/ All Hookups & Black Tank Flush
- Fully Finished & Heated Pass-Through w/ Slat Board Storage
- Exterior Radio in Pass-Through
- Exterior Speakers
- (2) 45 Gallon Grey Tanks (VBM)

- 45 Gallon Black Tank (VBM)
- Holding Tank Heat Pads
- Truma-Comfort Plus Tankless Water Heater
- Enclosed & Heated Water Lines
- Seamless Residential Insulated Heat Ducts
- 2-Zoned Radius House A/C Ducting System
- Wireless Backup Camera Prep
- Electric Power Cord Reel - (VBM)
- 110v Exterior Receptacle
- (2) 30 lb. LP Tanks w/ Auto Change Over

Parks Package - Standard

- Solid Hardwood Cabinetry
- 39" LED HDTV (Bedroom)
- Williamsburg Furniture Collection
- Bluetooth Sound System w/ Soundbar & Powered Subwoofer
- Pre-wired for Winegard® Satellite Systems
- LED Recessed Ceiling & Accent Lights
- Central Vacuum w/ Power Dust Pan
- USB Ports Throughout
- Electric Adjustable Awning w/ LED Lights
- Bauer Keyed-A-Like Lock System

Full Time Living Package - Standard

- Full-Extension Ball-Bearing Drawer Guides
- Residential Soft Close Hidden Hinges
- Oversized Farmhouse Sink
- High Rise Island w/ Dedicated Garbage Cabinet
- Day/Night Roller Shades
- Ceiling Fan (VBM)
- Maximum Linoleum Throughout
- Washer Dryer Prep
- Straight Roof Line (Luxury Profile)
- Insulated Slam Latch Baggage Doors
- Frameless Dual Pane Windows
- GoPower Roof & Sidewall Solar Prep
- 50 Amp Service
- Progressive 75 Amp/12v DC Power Converter
- Aluminum Wheels
- 3rd A/C in Living Room

Options

- High Efficiency Dishwasher
 - 5.5 Onan LP Generator
 - Slide Awning Package
 - Disc Brakes
 - Full Body Paint
 - Freedom Solar 2 (2 - 190 Watt Panels w/ Controller by GoPower)
- *VBM - Varies By Model

www.redwood-rv.com • 1140 W. Lake St Topeka, IN 46571 • (260) 593 - 3850

DISCLAIMER: Product information is as accurate as possible as of the date of publication of this brochure. All features, floor plans, and specifications in this brochure are subject to change without notice. Please also consult Redwood's web site at www.redwood-rv.com for more current product information and specifications. Tow Vehicle Disclaimer, CAUTION: Owners of Redwood recreational vehicles are solely responsible for the selection and proper use of tow vehicles. All customers should consult with a motor vehicle manufacturer or their dealer concerning the purchase and use of suitable tow vehicles for Redwood products. Redwood RV disclaims any liability or damages suffered as a result of the selection, operation, use or misuse of a tow vehicle. CROSSROADS' LIMITED WARRANTY DOES NOT COVER DAMAGE TO THE RECREATIONAL VEHICLE OR THE TOW VEHICLE AS A RESULT OF THE SELECTION, OPERATION, USE OR MISUSE OF THE TOW VEHICLE. REFERENCE CROSSROADS RV COMPANY OWNERS MANUAL FOR LIMITED WARRANTY DETAILS. *Length is defined as the distance from the centerline of hitch pin/coupler to rear bumper of trailer.