



Lance **travel trailers**

ULTRALIGHT SERIES

Eight perfect matches for mid-size SUVs and pickup trucks



1685



2180

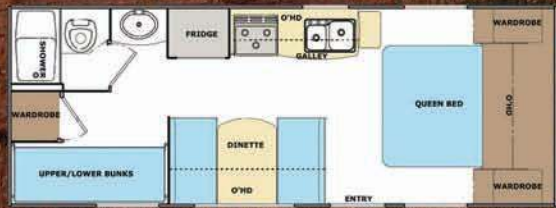

1880

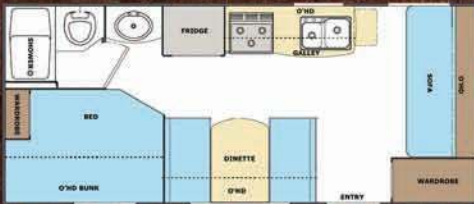

2185

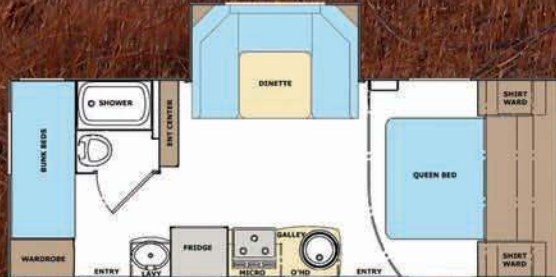

1881

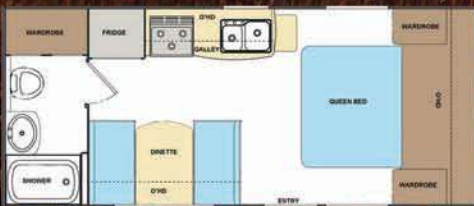

2281

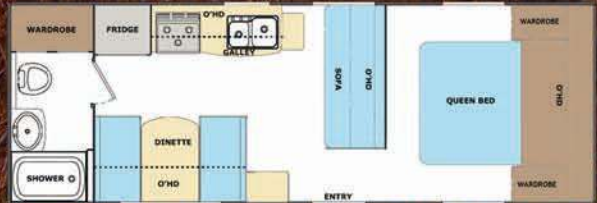

1985

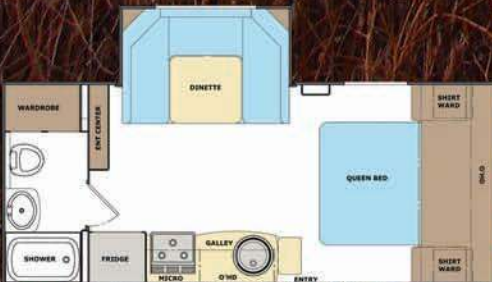

2285

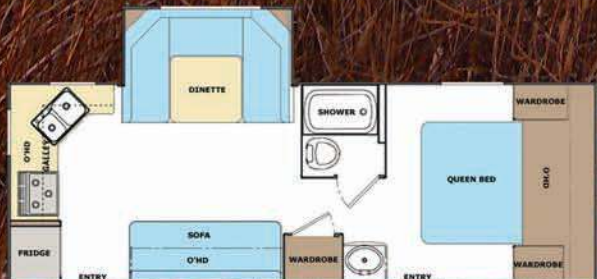



basic **tech specs**

	1685	1880	1881	1985	2180	2185	2281	2285
Gross dry weight (pounds)	3450	3280	3220	3650	3510	4635	3675	4160
Hitch dry weight (pounds)	346	340	325	370	355	600	370	445
Axle weight (pounds)	3104	2940	2895	3280	3155	3765	3305	3715
Cargo carrying capacity (pounds)	1910	1880	1940	1910	1950	1595	1985	1800
GVWR (Gross Vehicle Weight Rating - pounds)	5400	5200	5200	5600	5500	6000	5700	6000
Interior floor length	16'3"	18'2"	18'2"	18'10"	21'2"	21'2"	22'6"	22'6"
Interior height	78"	78"	78"	78"	78"	78"	78"	78"
Exterior height	109"	109"	109"	109"	109"	109"	109"	109"
Exterior height with air conditioner	119"	119"	119"	119"	119"	119"	119"	119"
Exterior width	96 $\frac{3}{8}$ "	96 $\frac{3}{8}$ "	96 $\frac{3}{8}$ "	96 $\frac{3}{8}$ "	96 $\frac{3}{8}$ "	96 $\frac{3}{8}$ "	96 $\frac{3}{8}$ "	96 $\frac{3}{8}$ "
Overall exterior length	20'9"	22'8"	22'8"	23'4"	25'8"	25'8"	27'0"	27'0"
Fresh holding tank (US gallons)	30	30	30	30	30	30	30	30
Grey holding tank (US gallons)	30	30	30	30	30	30	30	60
Black holding tank (US gallons)	30	30	30	30	30	30	30	30
Propane (number of tanks x US gallons)	2 x 5	2 x 5	2 x 5	2 x 5	2 x 5	2 x 5	2 x 5	2 x 5
Two-way power mode refrigerator (cubic feet)	6	6	6	6	6	6	6	6
Furnace (BTUs - British Thermal Units)	20,000	20,000	20,000	25,000	25,000	25,000	25,000	25,000
Number of people standard trailer sleeps	5	7	4	4	6	7	6	6
Queen bed	60"x80"	-	60"x80"	60"x80"	60"x80"	60"x80"	60"x80"	60"x80"
Double bed	-	54"x75"	-	-	-	-	-	-
Bunk bed(s)	29"x94"	29"x75"	-	-	2 x 29"x75"	3 x 29"x75"	-	-
Dinette bed	54"x78"	40"x72"	40"x72"	54"x78"	40"x72"	54"x78"	40"x72"	54"x78"
Sofa bed	-	42"x72"	-	-	-	-	42"x68"	42"x72"



Whitewater interior

Lance 1685

"Super-slideout" - with 54"x78" U-shaped dinette. Overhead storage bins throughout. Truly ultralight - only 3450 pounds dry weight. Three wardrobe closets. Under-bed storage accessible from either inside or outside the coach - in addition to pass-through exterior storage. Sleeps up to five. Some options specific to this model: front rockguard window, awning slideout cover, and pull-out storage tray.



Optional pull-out storage tray





A traditional floorplan with uncommon features. As in all Lance travel trailers, there's absolutely no compromise on the quality of components or workmanship in the Lance 1880. With sleeping accommodations for up to seven and all the features needed for a great vacation, it's the right RV for either just a couple, or a growing family. And a variety of options add to its versatility. Option specific to this model: front rock guard window.



Plenty of exterior-access storage space – large enough for a portable generator, firewood, tackle boxes – you name it.



Lance 1880



Red Rock interior

The Lance 1881, like its sister trailer – the Lance 2281 – is a front walk-around queen bed model with a similar floorplan, but with a more compact footprint than the 2281. The large rear bath includes a roomy wardrobe and lavatory sink. And there's no shortage of storage – including a large area beneath the front bed. Options for the 1881 include a convertible sofa/queen bed, and pull-out storage tray.



Available in the 1881, 1985, 2180 and 2185 models is an optional sofa/queen bed – deployed using a space-saving, somersault-flip/roll-out action.



Rear bath – looking left



Rear bath – looking straight in

Lance 1881



Gold Rush interior

Red Rock interior



Lance 1985



In the new Lance 1985, we've taken our very popular "super slideout" dinette and walk-around bed features - and combined them with a full-trailer-width rear bathroom and spacious galley area. There's an abundant amount of storage in this model as well. Options specific to the 1985: convertible sofa/queen bed, and pull-out storage tray.

As in the Lance 1881 and 2281 models, the 1985 has a full-trailer-width rear bathroom - and there's a large exterior storage compartment under the bathroom wardrobe.



Red Rock interior

Lance 2180

Twenty-one feet of comfort and convenience with sleeping for six. Fold-up the rear bunks and there's plenty of storage for the kid's bikes or other toys - with access from a large outside door. Standard features include the six-foot double-door refrigerator and a full-length rear wardrobe.

Like all Lance travel trailers, a comfortable dinette converts into a bed - with lots of storage beneath. Options specific to this model: convertible sofa/queen bed, and pull-out storage tray.



Gold Rush interior

Available in the 1881, 1985, 2180 and 2185 models is an optional sofa/queen bed - deployed using a space-saving, somersault-flip/roll-out action.



Looking back into the twin bunks and bathroom.



Rear triple-bunk



The new Lance 2185 is a unique lightweight trailer with a rear triple-bunk that can also convert into a large exterior storage garage. Equipped standard to sleep up to seven people in only a 21-foot-long box. A huge U-shaped dinette slideout provides a dance-floor-type feel in the center of the trailer. The forward queen bed has a walk-around on both sides. This 2185 is perfect for the long distance traveler or for family and friends. Options specific to this model: convertible sofa/queen bed, and pull-out storage tray.

The bathroom door opens, swings-out and clicks into place - separating the rear of the trailer from the front.

Lance 2185



Gold Rush interior



The Lance 2281, like its sister trailer – the Lance 1881 – is a front walk-around queen bed model with a similar floorplan. But, the 2281 is about four feet longer than the 1881 to accommodate a very comfortable sofa that converts to an additional bed. The large rear bath (seen on pages 6 and 7) includes a roomy wardrobe and lavatory sink. And there's no shortage of storage – including a large area beneath the front bed. Options for the 2281 include a pull-out storage tray.

Lance 2281





Gold Rush interior with optional swivel rockers

Lance 2285



"Super-slideout" - 54"x78" U-shaped dinette. Island (walk-around) queen bed. Rear kitchen. Two entry doors. Large center-located wardrobe. Pass-through exterior storage. Under-bed storage accessible from inside the trailer. Pull-out sofa standard. Sleeps up to six. Options specific to this model: swivel rockers (replaces pullout sofa), awning slideout cover, and pull-out storage tray.

Every Lance a **LanceLock**TM



LanceLock is the exclusive process we design and construct all our RVs with for strength and durability using interlocking aluminum framing, laminated paneling, and structural cabinetry. From computer-aided designs - computed numerically controlled (CNC) machines that cut and rout structural paneling to ensure uniformity and tight-tolerance fit - welded aluminum framing

using .062-inch-thickness aluminum tubing (coated with Alodine® to help protect against corrosion) - our 141,000-square-foot, custom-designed, state-of-the-art RV manufacturing facility produces quality rarely found in recreation vehicles.



Tinted glass windows
reduce glare and reject the sun's harmful rays.

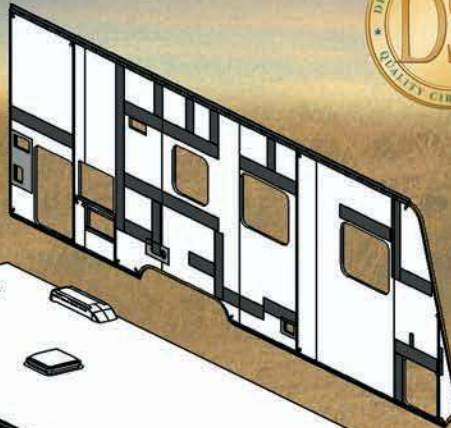

Welded, Alodine®-coated, .062" wall-thickness, all-aluminum frame construction with coated steel bonding plates serve as the underlying structure of every Lance for years of reliability and outdoor fun.



Solid, high-density block foam insulation provides a superior barrier for cool summers and warm winters.



EnergyStar®-rated TPO roof. An incredibly tough, seamless, marine-grade, white TPO (thermoplastic polyolefin) single-piece roof doesn't chalk, resists streaking, provides added insulation - and carries a manufacturer's 12-year warranty.



Solid-Ply® interlocking solid wood cabinetry. Cabinets and components are screwed together. No more staples and glue.

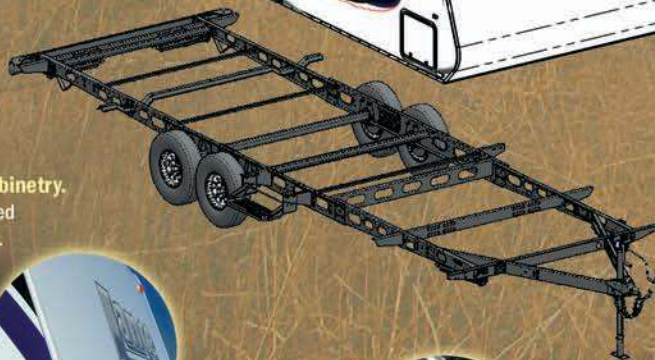

Custom-manufactured, solid aluminum exterior seam moldings ensure a tight bond and lasting beauty.

Torsion-bar suspension axles. Premium, heavy-duty, rubber torsion-bar-suspension axles with EZ-lube wheel bearings ensure a smooth ride.

Super-lightweight, powder-coated chassis. Every Lance travel trailer superstructure is mounted on a lightweight, high-strength-engineered, powder-coated, tempered steel chassis.

©2010 Lance Camper Manufacturing Corporation (LCMC). All rights reserved. Lance, the Lance logo, LanceLock and other exclusive Lance product names, marks or designations are trademarks, service marks or registered trademarks of LCMC. All other marks are property of their respective owners. All product data, graphics and photography in this brochure were as accurate as possible at press time. Subsequent refinements during the model year may be evident in the actual product. LCMC reserves the right to change prices, colors, materials, equipment and specifications without notice - as well as to add, modify or discontinue models shown in promotional materials and/or on its websites. All weights, fuel and liquid capacities are approximate and dimensions are nominal. LCMC has designed its travel trailers to provide a variety of potential uses for owners. Each model features optimum living, storage, fluid, seating and sleeping capacities. Though each owner enjoys this potential, it's that purchaser's sole responsibility to select the proper Lance travel trailer and towing equipment appropriate to their tow vehicle without exceeding safe weight operating and towing capacities. Your Factory Authorized Lance Dealer can advise you of safe operating parameters for your particular use and situation, as well as confirming prices and product specs material to your purchase decision. CS-1010 40M. Litho in USA.