

DSI
Annual RVDA DEALER
SATISFACTION INDEX
AWARD WINNER
7 YEARS IN A ROW

Cougar

by *Keystone*



 **Keystone RV
Company**

WESTERN EDITION

HIGH COUNTRY PACKAGE



Thomasville Furniture w/Recliners



Frameless Windows



Weber grill



Max Air Fan w/Remote



Lighted Awning



Clay Colored Sidewalls



Keyless Entry (Cougar FW Only)



**NOW AVAILABLE ON ANY
COUGAR FIFTH WHEEL MODEL**

**Not available on 1/2 ton series and Ultra Lite models*



COUGAR FIFTH WHEELS

Innovative designs, quality construction, residential finished interiors, and luxury features. Cougar continues to focus on the things most important to our customers. With a floorplan to match everyone's needs, Cougar is the brand you can rely on.



PAGES 4-14



COUGAR 1/2 TON FIFTH WHEELS

Taking the quality of a Cougar and matching it with the size and weight your vehicle can tow! 1/2 Ton Cougar offers multiple 1/2 ton towable fifth wheel floorplans.



COUGAR 1/2 TON TRAVEL TRAILERS

Continuing to grow in floorplans and features, 1/2 Ton travel trailers are engineered to give you more for your money while focusing on staying lightweight and budget friendly.



PAGES 5-19



*Since 1998,
Cougar has been the pinnacle of excellence in the RV industry,
earning the DSI award for 7 consecutive years. Come find out why...*

THE DSI (DEALER SATISFACTION INDEX) AWARD RATES THE LEVEL OF SATISFACTION THE DEALERS HAVE IN A MANUFACTURER. IT RATES MANUFACTURERS IN MANY AREAS SUCH AS: PRODUCT DESIGN, PRODUCT RELIABILITY & QUALITY, WARRANTY SUPPORT, AND PARTS SUPPORT.

313RLIVE SHOWN IN BRONZE DECOR

COUGAR FIFTH WHEELS



EXECUTIVE KITCHEN

- ① 8 Cubic Foot Refrigerator
- ② 22" Oven
- ③ Best in Class Pantry Storage
- ④ Tile Backsplash
- ⑤ Island with Storage - Select Models
- ⑥ Crown Molding
- ⑦ Rich Residential Cherry Cabinet Doors
- ⑧ Residential 5" Pulls
- ⑨ Easy to Reach Microwave Oven
- ⑩ Pots and Pans Drawers - Most Models
- ⑪ Dedicated Trash Can Storage
- ⑫ Large Solid Surface Countertop
- ⑬ Stainless Steel Sink
- ⑭ Pull-Out Faucet with Sprayer



301SABWE SHOWN IN AUBURN DECOR



313RLIWE BEDROOM SHOWN IN BRONZE DECOR



313RLIWE BATHROOM with 30" x 60" SHOWER



337FLSWE FRONT LIVING ROOM

Cougar's version of the popular front living room features 4 slides, 50" HDTV, plentiful seating, gourmet kitchen and private master bedroom with bed slide.



301SABWE BUNKROOM



INDUSTRY FIRST PASS-THRU STORAGE PLUS



SRX

326SRXWE GARAGE SHOWN IN PLATINUM DECOR



326SRXWE DUAL OPPOSING SOFAS IN GARAGE

326SRXWE SHOWN IN PLATINUM DECOR

Residential styling and toyhauler function, the new 326SRXWE fifth wheel includes amazing amounts of storage, room for your toys or tools and has great features including: 3 TV's, washer/dryer prep, outdoor refrigerator and weighs under 10,000 lbs.



326SRXWE SHOWN IN PLATINUM DECOR

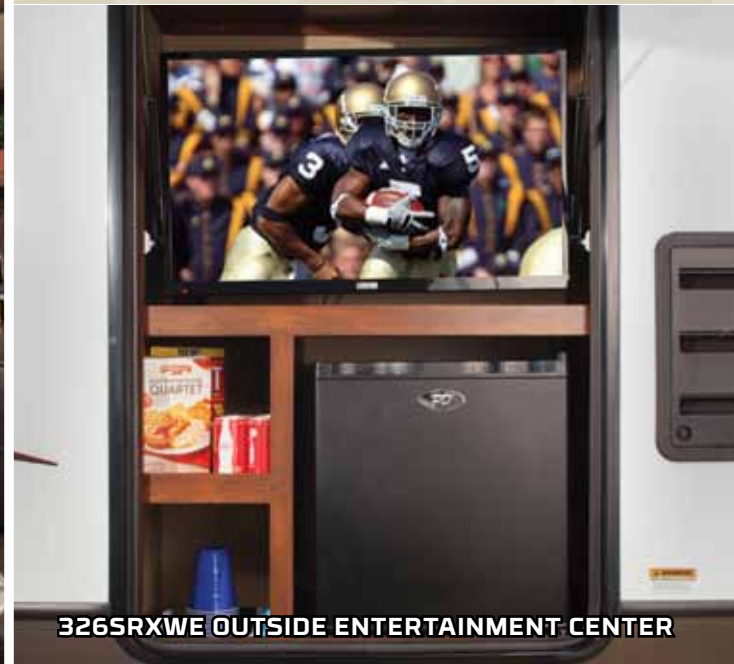

326SRXWE OUTSIDE ENTERTAINMENT CENTER

COUGAR FIFTH WHEEL FEATURES



Another Cougar first: The rear storage rack provides a quick slide-away storage alternative. (N/A on 326)



DOCKING STATION with battery disconnect for quick and easy set up.



ORTHOPEDIC SLEEP SYSTEM includes 7.5" foam mattress, orthopedic foam bunk mats and Ashley ortho tri-fold sleep surface.



LED lights on the new front cap are a great way to make things more visible at night. Not to mention it's energy efficient.



OPTIONAL FIREPLACE (*Mandatory on 326)



W/D PREP (280, 313, 326, 327, 331, 333)



40" LED TVs in the main living area



TOUCH SCREEN REMOTE



Cougar slam baggage doors offer added security and convenience while providing better insulation.



Black tank flush provides a clean and easy solution to cleaning your waste tank.



BLUETOOTH STEREO. Also includes: AM/FM, MP3, AUX INPUT, USB PORT, DVD/CD PLAYER



Cougars command center features back lighted switches and places all of your controls in one convenient location.



LED Lighted awning

Cougar

by Keystone

(5-SIDED ALUMINUM SUPER STRUCTURE)

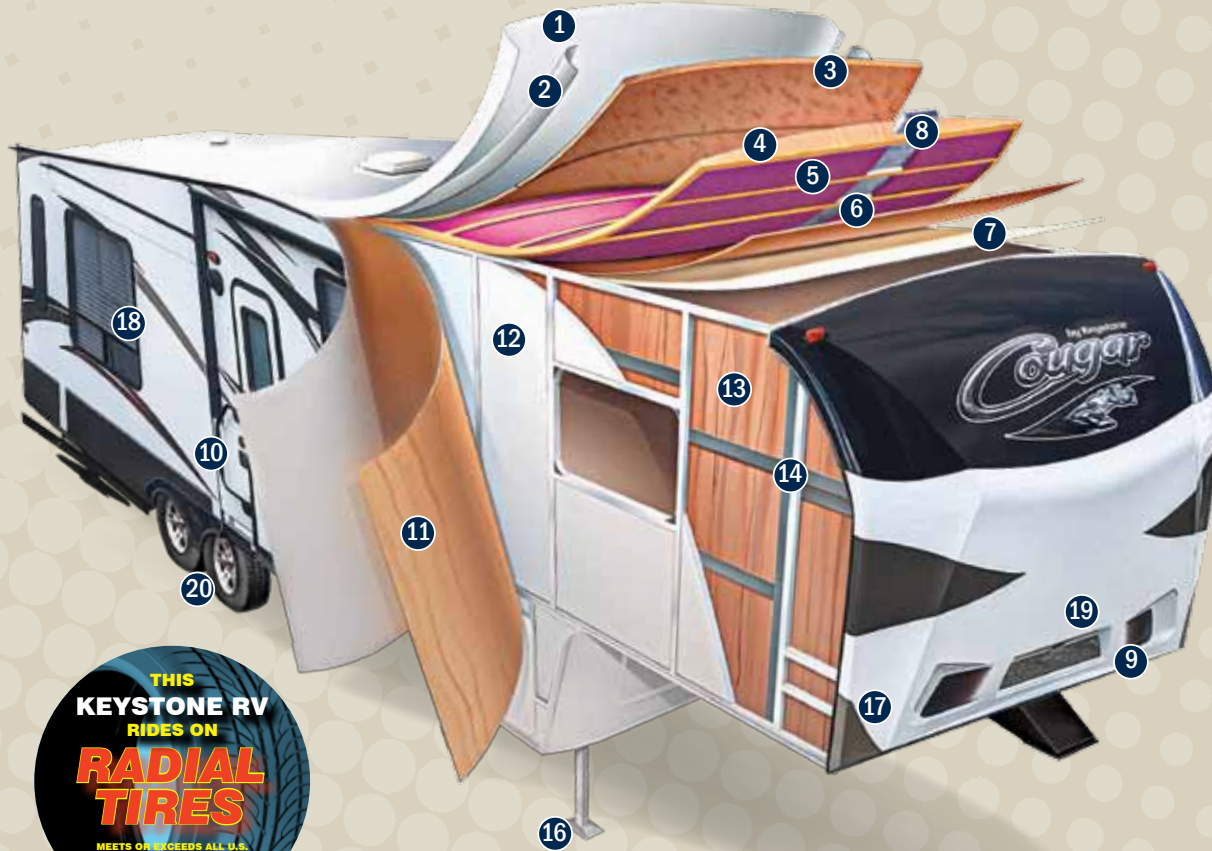

- 1 One-piece T.P.O. roof membrane with 12 year warranty
- 2 Radius roof transition molding
- 3 3/8" roof decking
- 4 5" fabricated rafters on 16" centers
- 5 Fiberglass insulation (R-14)
- 6 Ceiling decking Luan backer
- 7 Vinyl ceiling panel
- 8 Triple insulated, foam-core air conditioning duct
- 9 Hitch Vision (Patented)
- 10 Gel-coated Filon® fiberglass sidewall
- 11 1/8" Luan board (2 layers)
- 12 Solid block foam insulation (R-9)
- 13 Interior decorator wall board
- 14 2" welded aluminum wall studs
- 15 Electro-galvanized sheet (EGS) metal backing strips
- 16 Easy access adjustable snap jack pins
- 17 Industry leading "Max Turn" turning radius
- 18 Tinted safety glass windows
- 19 LED Docking lights
- 20 E-Z lube axles

COUGAR FIFTH WHEELS



FLOOR (R-14) + (R-15)

- 1 10" steel i-beam (powder coated)
- 2 3" Welded aluminum floor joists
- 3 3" Large-capacity insulated heat duct
- 4 1/4" polypropylene enclosed underbelly
- 5 Welded steel cross members
- 6 Full radius wrap aluminum enclosure
- 7 Woven moisture and vapor barrier
- 8 Fiberglass insulation (R-14)
- 9 5/8" Seamless floor decking
- 10 Residential-grade carpeting with stain protectant
- 11 2" Heat duct from furnace into underbelly
- 12 Heated, enclosed water lines
- 13 Astro-Foil insulation barrier (R-15)





MOR/RYPDE SUSPENSION

What does "Best-In-Class" mean for a suspension system?

It means that all suspensions are not created equal. Like all other products, there are unique product segments relative to price and quality demands.

CRE/3000 RUBBER EQUALIZER

FOR SUSPENSIONS, IT LOOKS LIKE THIS:
UPGRADED EQUALIZER = IMPROVED SUSPENSION TRAVEL OVER STOCK STANDARD, STOCK STEEL ROCKER ARM & LEAF SPRINGS

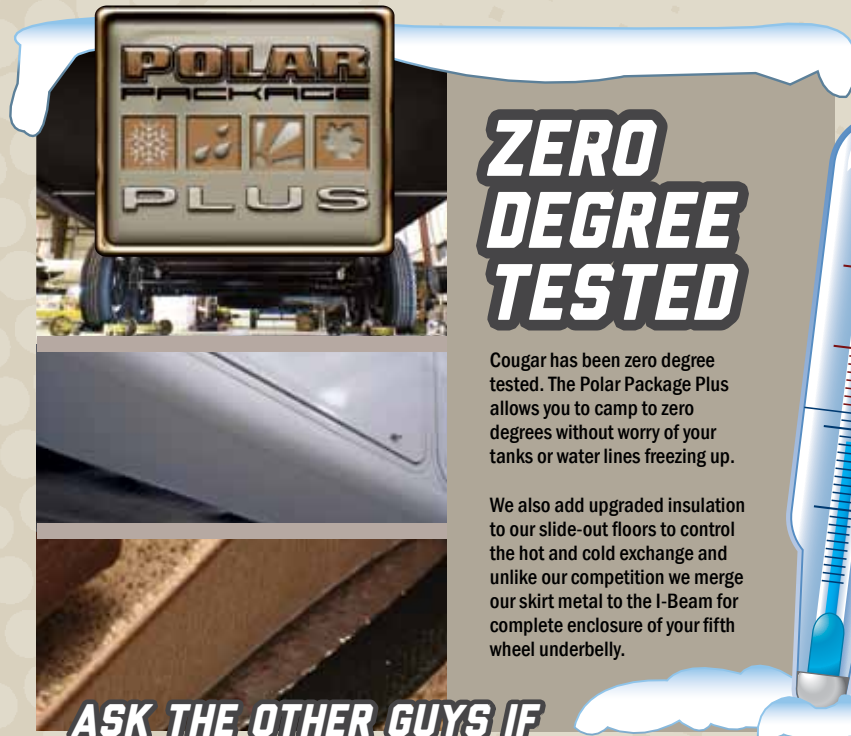

ZERO DEGREE TESTED

Cougar has been zero degree tested. The Polar Package Plus allows you to camp to zero degrees without worry of your tanks or water lines freezing up.

We also add upgraded insulation to our slide-out floors to control the hot and cold exchange and unlike our competition we merge our skirt metal to the I-Beam for complete enclosure of your fifth wheel underbelly.

**ASK THE OTHER GUYS IF
THEY HAVE BEEN TESTED!**

MAX TURN FRONT CAP

Combining focused design and unique product specifications, Max Turn Technology is the leader in optimum turn radius.

Unlike the competition, Cougar uses continuous contoured tubular steel for optimum strength and support behind the engineered tapered fiberglass front cap.

Also, Cougar is equipped with a heavy duty extended hitch. Combined - Max Turn Technology makes turning and maneuvering a breeze.

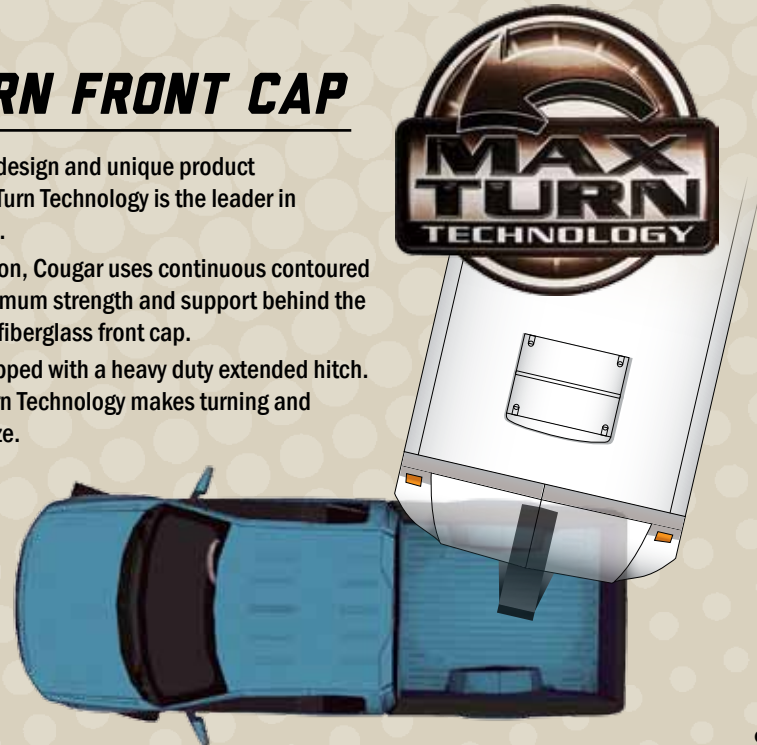

PATENTED COUGAR HITCH VISION

Hitch Vision moves the dial forward in what customers expect from an RV. There's no looking back!

Hitch Vision gives the fifth wheel user complete confidence to back up and align their truck to Cougar's extended hitch pin using only the built-in mirror for guidance. Automotive LED docking lights, which can be controlled by the E-Z Camp Cougar Remote, allow you to load or unload camping gear day or night. (Hitch Vision also comes in handy when using the E-Z Camp Cougar Remote to raise and lower landing gear.) Once you've used Hitch Vision, "there's no looking back" to the inconvenience of turning or straining to see your fifth wheel.

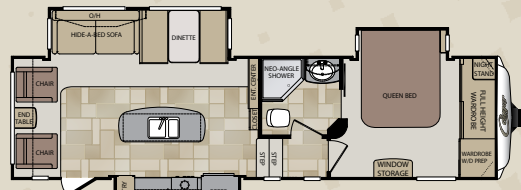

280RLSWE

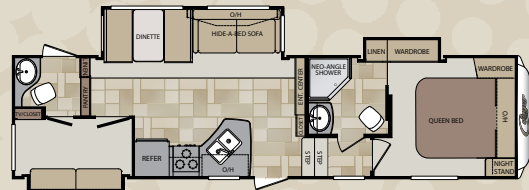

ALL NEW 301SABWE



ALL NEW 313RLIWE

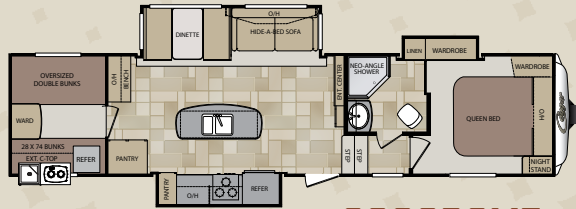

320QBSWE

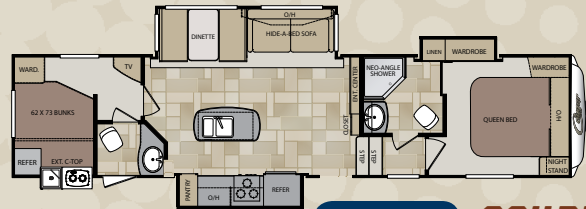

ALL NEW 334RDBWE

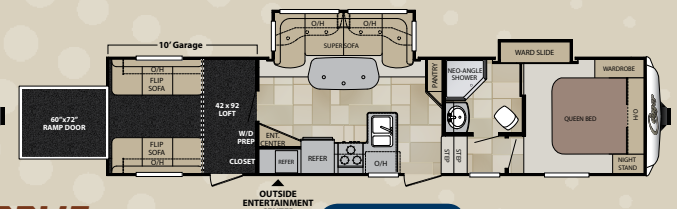

ALL NEW 326SRXWE

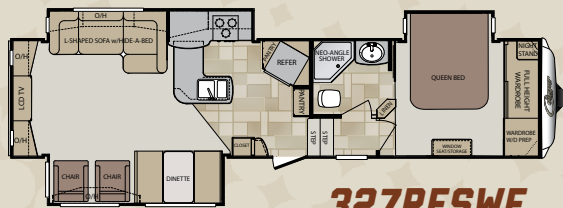

327RESWE

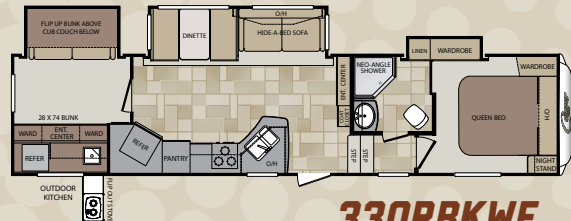

330RBKWE



331MKSWE



333MKSWE



ALL NEW 337FLSWE



FIFTH WHEELS

MODEL	280RLSWE	301SABWE	313RLIWE	320QBSWE	326SRXWE	327RESWE	330RBKWE	331MKSWE	333MKSWE	334RDBWE	337FLSWE
SHIPPING WEIGHT	9325	9220	9540	9671	9745	10185	10065	10070	10185	10185	9755
CARRYING CAPACITY	2825	2885	2725	2529	2915	1950	2380	2180	2025	2025	2715
HITCH WEIGHT	1750	1705	1865	1910	2260	1735	2045	1850	1810	1810	2070
EXTERIOR LENGTH	32' 9"	34' 0"	34' 7"	36' 11"	37' 7"	36' 5"	37' 4"	36' 6"	36' 8"	37' 8"	37' 8"
EXTERIOR WIDTH	8'	8'	8'	8'	8'	8'	8'	8'	8'	8'	8'
EXT. HEIGHT - A/C TOP	12' 3"	12' 9"	12' 3"	13' 2"	13' 2"	12' 3"	12'	12'	12' 10"	13' 2"	13' 2"
FRESH WATER (GAL.)	60	60	60	60	60	60	60	60	60	60	60
WASTE WATER (GAL.)	38	76	38	38	38	38	38	38	38	38	38
GRAY WATER (GAL.)	76	76	76	76	76	76	76	76	76	76	76
LP CAPACITY (LBS.)	60	60	60	60	60	60	60	60	60	60	60
AWNING LENGTH	16'	15'	14'	20'	19'	14'	19'	13'	12'	20'	16'

Product information is as accurate as possible as of the date of publication of this brochure. Features, floor plans, and specifications are subject to change without notice. Please also consult Keystone's web site at keystonev.com for more current product information and specifications. Tow Vehicle Disclaimer. CAUTION: Owners of Keystone recreational vehicles are solely responsible for the selection and proper use of tow vehicles. All customers should consult with a motor vehicle manufacturer or their dealer concerning the purchase and use of suitable tow vehicles for Keystone products. Keystone disclaims any liability or damages suffered as a result of the selection, operation, use or misuse of a tow vehicle. KEYSTONE'S LIMITED WARRANTY DOES NOT COVER DAMAGE TO THE RECREATIONAL VEHICLE OR THE TOW VEHICLE AS A RESULT OF THE SELECTION, OPERATION, USE OR MISUSE OF THE TOW VEHICLE.

STANDARDS, OPTIONS AND DECORS

CAMPING IN STYLE PACKAGE*

- Day and night shades
- Black trim safety glass windows (tinted to keep the sun out)
- Microwave oven with turn style
- Aluminum framed sidewalls, floor, front and rear walls, slide rooms
- 13,500 BTU air conditioner
- Raised-panel upper & lower cabinet doors throughout
- Cougar Platinum Series Orthopedic Sleep System Mattress
- Orthopedic sleep system

VALUE PACKAGE*

- True home CD/DVD system with speakers and separate zones (12-Volt compatible); MP3 player hookup on stereo with Bluetooth
- Gas/electric water heater with quick recovery
- Residential shower/tub surround
- TV antenna
- Satellite/Cable hook-up
- Gel coated Filon® fiberglass
- Full walk-on roof & slideouts
- Fiberglass walls
- Rear stabilizer jacks
- Max Turn Technology front cap (fifth wheels only)
- MOR/ryde CRE 3000 Suspension

CONVENIENCE PACKAGE*

- Outside shower
- Residential refrigerator front
- Spare tire
- XL grab handle

COUGAR PACKAGE*

- Slam latch baggage doors
- 40" LCD TV (50" in 337)
- Electric awning
- Radial tires
- Carbon monoxide detector
- Outside speakers
- Black tank flush
- XL Pass through storage with entertainment hook-up
- 16" wheels
- 8 cu ft refrigerator
- Outside LP quick connect
- Main entrance step light
- Battery disconnect
- Solid surface countertops

MANDATORY OPTIONS*

- Slide out bike/storage rack (N/A 326)
- Cougar Camp Remote Control
- Polar Package Plus

COUGAR OPTIONS

- "Smart Slide" Free standing dinette
- Multi-Functional L-Shape sleeper sofa (327 & 331 only)
- 15,000 BTU Ducted air conditioning
- Aluminum wheels

NOTABLE STANDARD FEATURES

- 50 Amp Service
- E-Z lube hubs on axles (all models)
- Snap jack pins (all fifth wheels)
- 35,000 BTU furnace
- One-piece seamless T.P.O. roof
- Pre-Wire and Prepped for 2nd Air conditioner
- Patented Front Cap Hitch Vision
- Hand glazed cherry raised panel upper & lower cabinet doors through out
- Solid hardwood slide fascia
- 19" LCD spare room TV (326 & 330 only)
- Residential porcelain toilet with foot pedal
- All windows in main slide out open

SAFETY MUST-HAVES

- Manual backup on all main slide outs
- T-Mold bulb seals on all slide outs to keep slider sweeps on your slide out (stays on in hot weather)
- LP sensor
- Smoke detector
- Fire extinguisher
- Carbon monoxide detector

DRY CAMPING FEATURES

- 12 Volt stereo/MP3 compatible
- Large fresh, gray & black tanks (all models)
- All slide-out lights are 12 Volt
- Space for dual batteries
- Entire underbelly enclosed to keep debris off tanks, water lines, etc.
- All lights 12V compatible

* Mandatory option

AUBURN



BRONZE



PLATINUM



DARE TO COMPARE

- #1 selling fifth wheel in its class (13 years in a row)
- Highest trade-in and resale value in the industry on average
- Hitch Vision (patented) front cap with docking lights & Max Turn Technology (fifth wheels only)
- Exclusive factory installed bike/storage rack on most fifth wheels and travel trailers
- Fully enclosed, underbelly with heated and

- enclosed dump valves
- 16.2 Gallons per hour – quick recovery water heater (great for bunkhouses)
- Oversized pass-thru storage doors with slam latches
- Slide out seal is mounted in a "T" track (no sticky tape to hold slide seals on)
- Solid surface countertops
- Extra large slide-out windows open for cross ventilation

- Pass-thru storage plus
- Panoramic picture window at all dinettes
- Day/night shades
- Porcelain foot flush toilets
- Five side welded aluminum super structure
- R-9 sidewall, R-14 roof, R14+R15 floor insulation and R-15 astro-foil in the slide out
- Fully ducted air conditioning featuring triple insulated, foil wrapped, light weight ducts
- 12 Volt compatible for dry camping

- Outside docking station (fifth wheels only)
- Back lit inside command center
- Cherry stained Alder hardwood upper and lower cabinet doors
- Cougar remote
- Polar package plus
- Full extension drawer guides
- Black tank flush
- Battery disconnect

1/2 TON SERIES



27RLSWE SHOWN IN BRONZE DECOR



TRAVEL TRAILERS

Cougar 1/2 Ton Series travel trailers have set a new standard for lightweight. Our goal was to make a unit lighter weight without sacrificing a high end features and a residential feel.

The Cougar 1/2 Ton series 31SQB in Bronze décor can accommodate any size family, with unmatched interior/ exterior storage and sleeps up to 9.



31SQB KITCHEN SHOWN IN BRONZE DECOR

277RLSWE SHOWN IN PLATINUM DECOR

EXPECT MORE AND SACRIFICE NOTHING



277RLSWE SHOWN IN PLATINUM DECOR



FIFTH WHEELS

Enjoy panoramic views in the ultimate rear living model; The Cougar 277RLS boasts interior living space with optimum kitchen, bedroom, and wardrobe storage while still keeping unit ½ ton towable.



Cougar 1/2 Ton Series takes good ideas to the next level. The Cougar 31SQBWE features a full service outside kitchen which includes a refrigerator, stove top, sink and extendable countertop all without sacrificing valuable sleep space.

Another Cougar first: The rear storage rack provides a quick slide-away storage alternative.

1/2 TON SERIES FEATURES



COUGAR HAS EARNED THE DSI AWARD AN UNPRECEDENTED 7 YEARS IN A ROW!

THE DSI (DEALER SATISFACTION INDEX) AWARD RATES THE LEVEL OF SATISFACTION THE DEALERS HAVE IN A MANUFACTURER. IT RATES MANUFACTURERS IN MANY AREAS SUCH AS: PRODUCT DESIGN, PRODUCT RELIABILITY & QUALITY, WARRANTY SUPPORT, AND PARTS SUPPORT.



ZERO DEGREE TESTED

Cougar has been zero degree tested. The Polar Package Plus allows you to camp to zero degrees without worry of your tanks or water lines freezing up.

We also add upgraded insulation to our slide-out floors to control the hot and cold exchange and unlike our competition we merge our skirt metal to the I-Beam for complete enclosure of your fifth wheel underbelly.

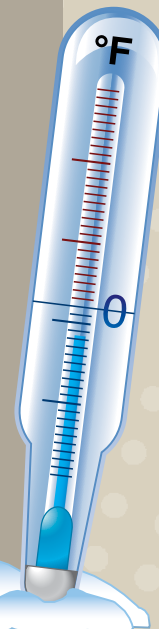

ASK THE OTHER GUYS IF THEY HAVE BEEN TESTED!



Cougar Platinum Series Ortho-Pedic Sleep System



The 1/2 Ton Series comes with an 8 cu. ft. refrigerator standard.



Cougar slam baggage doors offer added security and convenience while providing better insulation.



TOUCH SCREEN REMOTE



BATTERY DISCONNECT



MOR/ryde Suspension comes standard on all Cougar 1/2 Ton Series fifth wheels and travel trailers.



OPTIONAL FIREPLACE (277RLS, 279RKS, 281BHS, 282RES). STANDARD on 32RES.



Glazed raised panel hardwood upper and lower cabinet doors



Cougar 1/2 Ton Series comes outfitted with a black tank flush hook-up. This feature keeps the black tank clean and trouble free.



BLUETOOTH STEREO. Also includes: AM/FM, MP3, AUX INPUT, USB PORT, DVD/CD PLAYER



Setting up and taking down your awning is easier than ever with the all new Cougar adjustable electric awning.



The multi-functional pop-up dinette table offers ease of use both inside and outside.

1/2 TON SERIES TRAVEL TRAILER FLOORPLANS

COUGAR 1/2 TON SERIES TRAVEL TRAILERS AND FIFTH WHEELS

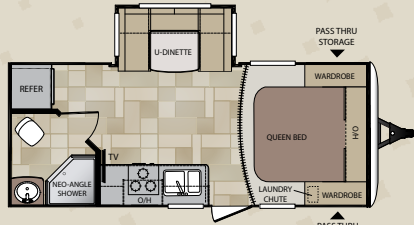

19RBWE

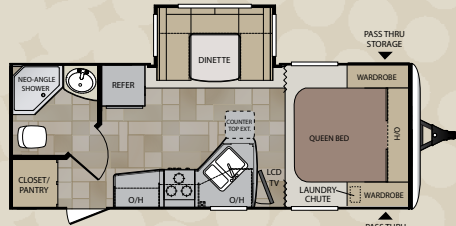

21RBSWE

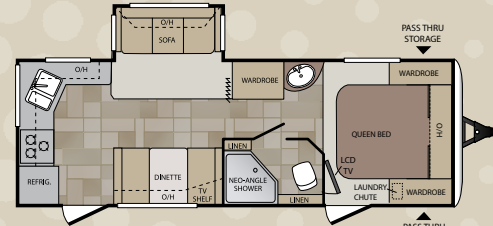

24RKSWE

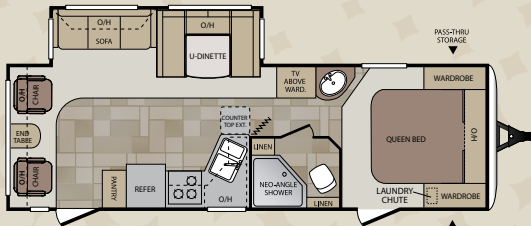

25RLSWE

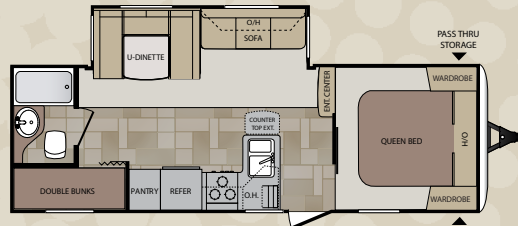

26BHSWE

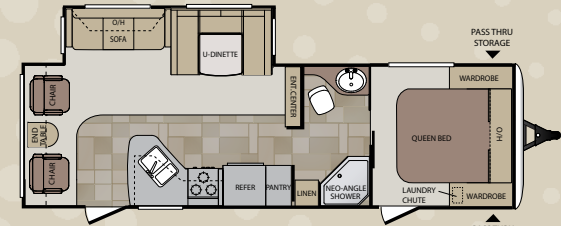

27RLSWE

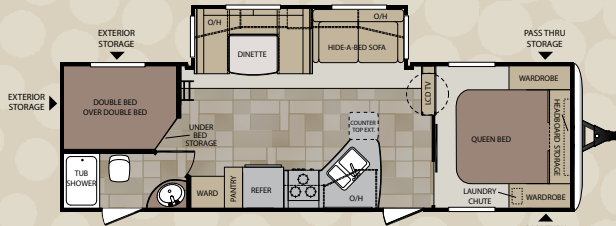

28RBSWE

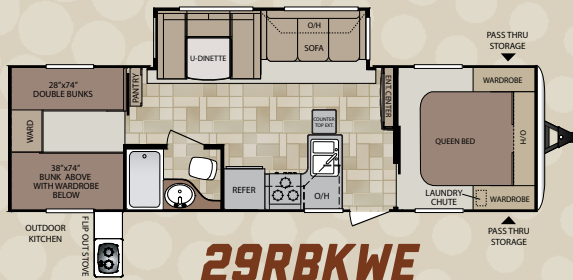

29RBKWE

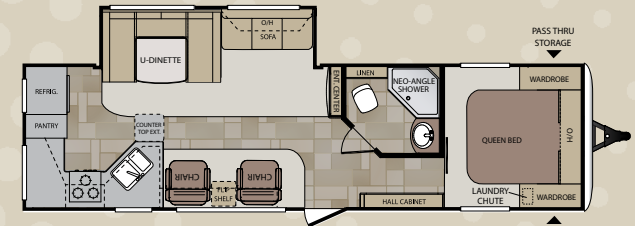

30RKSWE

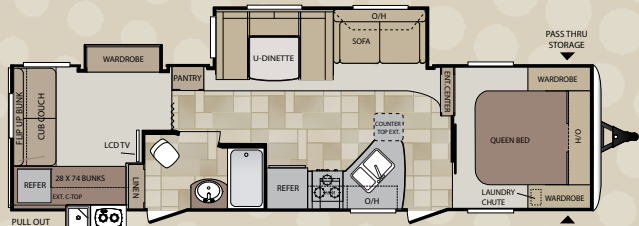

31SQBWE

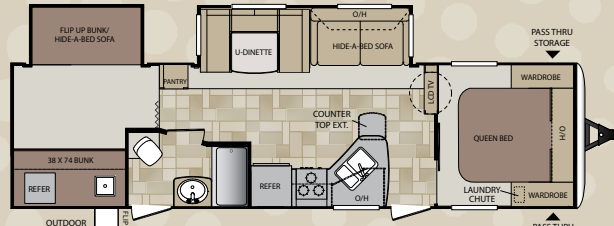

32RBKWE

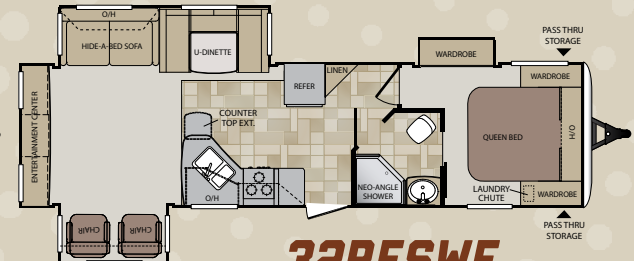

32RESWE

1/2 TON SERIES FIFTH WHEEL FLOORPLANS

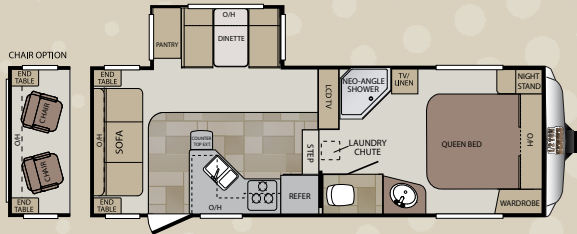

244RLSWE

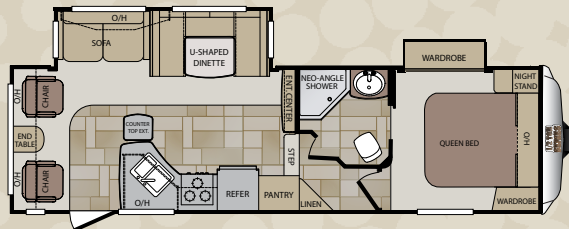

277RLSWE

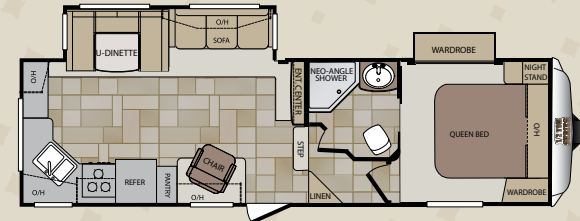

279RKSWE

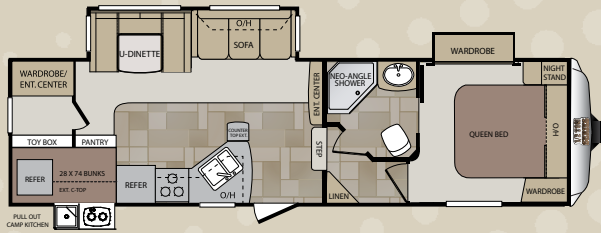

281BHSWE

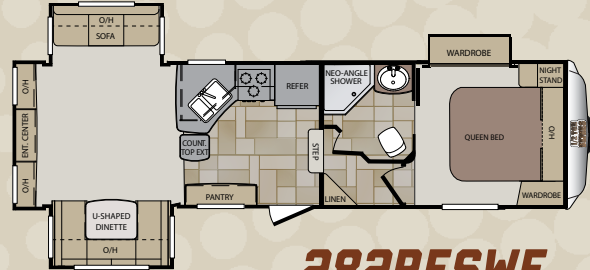

282RESWE

**1/2 TON
SERIES**

TRAVEL TRAILERS

FIFTH WHEELS

MODEL	19RBEWE	21RBSWE	24RKSWE	25RLSWE	26BHSWE	27RLSWE	28RBSWE	29RBKWE	30RKSWE	31SQBWE	32RBKWE	32RESWE	244RLSWE	277RLSWE	279RKSWE	281BHSWE	282RESWE
SHIPPING WEIGHT	4787	5268	5591	6074	5866	6271	6305	6554	6645	7229	7294	7251	6802	7637	7560	8161	7927
CARRYING CAPACITY	1613	1932	1609	1726	1934	1729	1695	1646	1555	1771	1706	1749	3268	2693	2760	2209	2343
HITCH WEIGHT	540	500	530	630	580	610	850	760	670	750	740	840	1270	1530	1520	1570	1470
EXTERIOR LENGTH	23' 6"	25' 9"	27' 3"	29' 6"	28' 11"	30' 6"	31' 8"	32' 6"	34' 4"	35' 5"	34' 9"	34' 7"	26' 9"	30' 2"	30' 2"	32' 2"	31' 0"
EXTERIOR WIDTH	8'	8'	8'	8'	8'	8'	8'	8'	8'	8'	8'	8'	8'	8'	8'	8'	8'
EXT. HEIGHT - A/C TOP	11' 1"	11' 1"	11' 1"	11' 1"	11' 1"	11' 1"	11' 1"	11' 1"	11' 1"	11' 1"	11' 1"	11' 1"	11' 9"	11' 9"	11' 9"	12' 4"	11' 9"
FRESH WATER (GAL.)	60	60	60	60	60	60	60	60	60	60	60	60	60	60	60	60	60
WASTE WATER (GAL.)	38	38	38	38	38	38	38	38	38	38	38	38	38	38	38	38	38
GRAY WATER (GAL.)	38	76	76	38	76	76	76	38	76	76	76	76	76	76	76	76	76
LP CAPACITY (LBS.)	60	60	60	60	60	60	60	60	60	60	60	60	60	60	60	60	60
AWNING LENGTH	16'	16'	15'	17'	16'	16'	16'	17'	19'	19'	18'	18'	16'	19'	16'	17'	13'

Product information is as accurate as possible as of the date of publication of this brochure. Features, floor plans, and specifications are subject to change without notice. Please also consult Keystone's web site at keystonerv.com for more current product information and specifications. Tow Vehicle Disclaimer. CAUTION: Owners of Keystone recreational vehicles are solely responsible for the selection and proper use of tow vehicles. All customers should consult with a motor vehicle manufacturer or their dealer concerning the purchase and use of suitable tow vehicles for Keystone products. Keystone disclaims any liability or damages suffered as a result of the selection, operation, use or misuse of a tow vehicle. KEYSTONE'S LIMITED WARRANTY DOES NOT COVER DAMAGE TO THE RECREATIONAL VEHICLE OR THE TOW VEHICLE AS A RESULT OF THE SELECTION, OPERATION, USE OR MISUSE OF THE TOW VEHICLE.



MAX TURN FRONT CAP

Combining focused design and unique product specifications, Max Turn Technology is the leader in optimum turn radius.

Unlike the competition, Cougar uses continuous contoured tubular steel for optimum strength and support behind the engineered tapered fiberglass front cap.

Also, Cougar is equipped with a heavy duty extended hitch. Combined - Max Turn Technology makes turning and maneuvering a breeze.

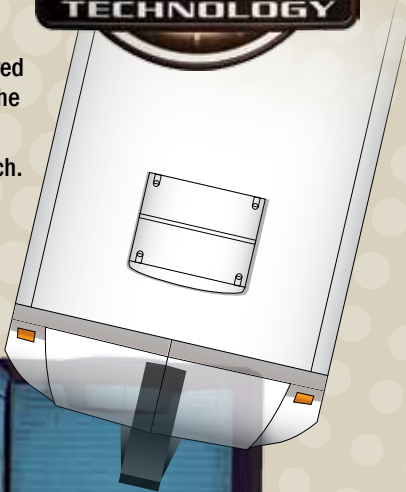

CONTROL EVERYTHING WITH THE LCI TOUCH SCREEN COUGAR REMOTE



Docking Light



Landing Gear



Electric Slide Out



Electric Awning



COUGAR HITCH VISION

Hitch Vision moves the dial forward in what customers expect from an RV. There's no looking back!

Hitch Vision gives the fifth wheel user complete confidence to back up and align their truck to Cougar's extended hitch pin using only the built-in mirror for guidance. Automotive LED docking lights, which can be controlled by the E-Z Camp Cougar Remote, allow you to load or unload camping gear day or night. (Hitch Vision also comes in handy when using the E-Z Camp Cougar Remote to raise and lower landing gear.)

Once you've used Hitch Vision, "there's no looking back" to the inconvenience of turning or straining to see your fifth wheel.

1/2 TON SERIES STANDARDS

- Executive Chef Kitchen (most models)
- Real cherry wood cabinet doors – not composite doors
- Oversized pots and pans drawer
- Pantry 100% larger than competitors
- Deep two bowl sink with sink cover cutting boards
- Residential full-extension drawer glides with steel ball bearings throughout
- Residential porcelain toilet with foot pedal
- EZ-Lube hubs on axles (all models)
- 30,000 BTU furnace
- One-piece seamless rubber roof
- All windows in main slide-out open
- Swivel rocker (25RLSWE, 27RLSWE, 30RKSWE, 244RLSWE, 277RLSWE, and 279RKSWE)
- Cable/satellite prep

1/2 TON SERIES CAMPING-IN-STYLE PACKAGE

- Pleated day/night shades
- Laundry chute (most models)
- Black trim safety glass windows
- Microwave oven with turn style
- Aluminum framed sidewalls, floors, front and rear walls and slide-rooms
- 13,500 BTU air conditioner

1/2 TON SERIES VALUE PACKAGE

- True home CD/DVD system with speakers and separate zones (12 Volt compatible), MP3 player hookup on stereo
- All weather outside speakers
- Gas/electric water heater with quick recovery
- Residential tiled shower/tub surround
- TV antenna
- Laminated fiberglass sidewalls

STANDARDS, OPTIONS AND DECORS

1/2 TON SERIES CONVENIENCE PACKAGE

- Outside shower*
- Residential refrigerator front*
- Spare Tire*
- Outside Cook Center (most models)*
- 1/2 Ton Series Dry Camping Features
- 12 Volt stereo
- Large fresh, grey and black tanks (all models)
- All slide-out lights are 12 Volt
- Space for dual batteries
- Entire underbelly enclosed to keep debris off tanks, water lines, etc.
- Fully enclosed and heated tanks and dump valves

1/2 TON SERIES SAFETY FEATURES

- Manual backup on all main slide-outs
- LP sensor
- Smoke detector
- Fire extinguisher
- Carbon monoxide detector

1/2 TON SERIES OPTIONS

- Air mattress sofa with storage (most models)
- Free-standing dinette (N/A 24RKSWE)
- Radial tires*
- Polar Package Plus*
- 20" LCD TV (24RKSWE, 25RLSWE)
- 26" LCD TV (N/A 24RKSWE, 25RLSWE)*
- 32" LCD TV (all fifth wheels)*
- Carbon monoxide detector*
- Electric awning*

* Mandatory option *Mandatory option

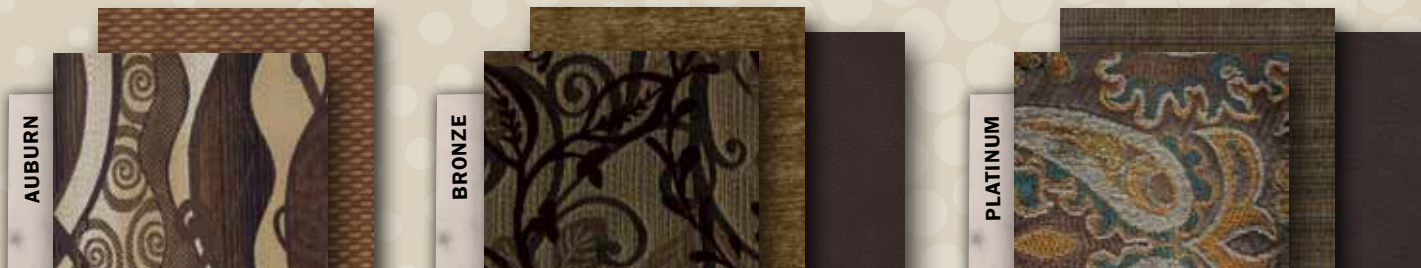

DARE TO COMPARE

1/2 TON SERIES

- Highest trade-in and resale value in the industry on average
- Polar Package Plus: enclosed underbelly with heated and enclosed tanks and dump valves
- 16.2 Gallons per hour – quick recovery water heater (great for bunkhouses)
- Slide-out seal is mounted in a “T” track (no sticky tape to hold slide seals on)

- Cougar – executive chef kitchen (see Cougar Standards for details)
- Easy access laundry chute (most models)
- Porcelain foot flush toilets
- Solid lambrequin leg window treatments
- Day/Night shades standard on all models
- Five side welded aluminum super structure
- R-9 sidewall insulation, R-14 ceiling insulation, R-14 floor insulation, R-15 underbelly insulation and R-15 astro-foil in slide-out floor

- Large capacity holding tanks
- Fully ducted air conditioning featuring triple insulated, foil-wrapped, light-weight ducts
- 12 Volt compatible for dry camping
- Slide-out bike rack
- Cougar E-Z Camp Remote
- Raised panel cherry wood cabinet doors



Cougar by Keystone **1/2 TON SERIES**

Cougar by Keystone

HIGH COUNTRY PACKAGE

WWW.KEYSTONERV.COM/COUGAR



CONNECT WITH KEYSTONE RV AND STAY UP TO DATE WITH PRODUCT NEWS AND INFORMATION

LEARN MORE



Go RVing
Life's A Trip

2642 Hackberry Drive
PO Box 2000
Goshen, IN 46527-2000
(574) 535-2100

Keystone RV Company
www.keystonerv.com

YOUR LOCAL DEALER:

BUY LOCALLY

PURCHASING YOUR RV LOCALLY

JANUARY 2014

It's up to you where you purchase your new Cougar, but may we suggest your local dealer? Not only does it help your local economy and provide jobs, but it will also give you an opportunity to develop a service relationship with someone that will come to know you and your coach. Congratulations on finding the best built, best equipped, best value in the industry, and happy travels!